

**PART# 406/2**

**Contemporary Bracket for 2" Diameter Tubing**

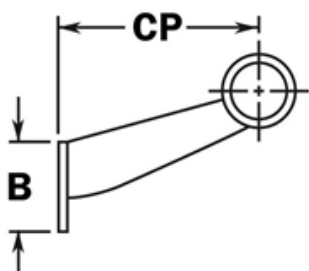

<b>CP</b>	6-1/16"
<b>B</b>	2-7/8"

MATERIAL & AVAILABLE FINISHES			
	BRASS	304 SST	316 SST
Polished	√	√	
Satin	√	√	
Clear Coat	√		

MATERIAL USAGE			
	BRASS	304 SST	316 SST
Indoor	√	√	
Outdoor	√*		
*Uncoated brass only			

MATERIAL CARE	
<b>Brass</b>	Use Lavi Metal Polish (Item# 00202) and apply with a damp, soft cloth.
<b>Stainless Steel</b>	Use metal cleaner and apply with a damp, soft cloth.

<b>INSTALLATION</b>	Mount bracket on the bar (vertical surface) using hardware appropriate for surface upon which it is being mounted.
<b>HARDWARE INCLUDED</b>	3 x #12 x 2" Philips flat head sheet metal brass plated screws.
<b>USE TOGETHER WITH</b>	2" OD tube (A120), matching flush fittings for 2" tube (730/2 series) and matching finials (600/2, 602/2).