



Movement Solutions

For Industrial & Electromechanical Applications

May 2016

Accuride[®]
Always Moving Forward

Spanning the Globe with Ball Bearing Slide Products

As one of the largest companies in the world dedicated exclusively to the design and manufacture of precision slide products, Accuride sets the industry benchmark for smoothness, silence, and strength.

Accuride's production facilities and stocking distributors are located around the world, offering global access, reliable lead times, and flexible scheduling, whether in Helsinki or Los Angeles.

As further testimony to Accuride's global commitment, all manufacturing facilities maintain a quality management system certified to ISO 9001:2008, and all product finishes, grease, and rubber and plastic components comply with the Restriction of Hazardous Substances (RoHS) Directive.

Design innovation, standardized methods, and stringent quality control are the cornerstones of Accuride's philosophy, and the extensive range of specialty and full extension slides is backed by a Limited Lifetime Warranty.

When quality counts leading manufacturers count on Accuride.

Accuride®
Always Moving Forward



Contents

To the Design Engineer

Factors to consider when selecting a slide	3
Slide cross sections and load ratings.....	4–6
Testing and terminology	7

Slides for Electronic Enclosure Applications

Slide Models – Load rating: 100–200 lbs. [45–91 kg]	8
2807, 2907, 2907WB, 3507	
Cable carriers.....	11
CC9, CC11	
Mounting brackets and general mounting instructions	11
Rack mounting bracket dimensions.....	12
Bar nuts Illustrations and dimensions.....	12

Slides for Industrial Applications

Light-Duty Slides – Load rating: 139 lbs. [63 kg] or less	13
2002, 2601, 3732, 3832, 3832SC, 3832HDSC, 3832TR, 3832HDTR, CH3832, 3832DO, 3832EC, 0363, 201	
Medium-Duty Slides – Load rating: 140–169 lbs. [64–76 kg].....	17
204A-LR, 305A-LR, 3301, 3307, 3357, 3308, 3634EC, 301-2590	
Heavy-Duty Slides – Load rating: 170–1,323 lbs. [77–600 kg].....	20
301, 3601, 3600, 3607, 3657, 3641, 3642, 7950, 7957, 9301, 9307, 9308, AL4140, AL4120,	
Specialty Slide Products – Load rating: 14.5–352 lbs. [6.6–160 kg]	28
CB-Hand, AL 4190 Tilt Track System, 115RC, 115, Ascent CBLift-0019, SS2028, SS0330, SS5321	

The 20 Series Slides

Pocket & Bayonet Mount – Load rating: 75–300 lbs. [34–136 kg]	34
2120, 3820, 3320, 3620, 9328, 9322	

Limited Lifetime Warranty

Inside Back Cover

Corporate Headquarters

12311 Shoemaker Avenue • Santa Fe Springs, California 90670
Telephone: (562) 903-0200 • Fax: (562) 903-0208 • accuride.com

Specification Table

	Model	Load Rating	Travel	Cross Section	Detent	Lock	Disconnect	Page
Electronic Enclosures	2807	100 lbs. [45 kg]	2" over [50.8 mm]	.38" [9.6 mm]	—	Out	Latch	9
	2907	115 lbs. [52 kg]	2" over [50.8 mm]	.38" [9.6 mm]	—	Out	Lever	9
	2907WB	120 lbs. [55 kg]	2" over [50.8 mm]	.38" [9.6 mm]	—	Out	Lever	10
	3507	200 lbs. [91 kg]	2" over [50.8 mm]	.50" [12.7 mm]	—	Out	Latch	10
Light-Duty Slides	2002 Two Way	50 lbs. [23 kg]	3/4	.38" [9.6 mm]	Center	—	—	14
	2601	75 lbs. [34 kg]	Full	.50" [12.7 mm]	Hold-in	—	—	14
	3732	100 lbs. [45 kg]	Full	.50" [12.7 mm]	Hold-in	—	Push Latch	14
	3832 series	100 lbs. [45 kg]	Full	.50" [12.7 mm]	Hold-in	—	Lever	15
	0363 Two Way	100 lbs. [45 kg]	Full	.85" [21.6 mm]	Center	—	—	16
	201	108 lbs. [49 kg]	3/4	.38" [9.6 mm]	Hold-in	—	—	16
Medium-Duty Slides	204A-LR	140 lbs. [64 kg]	3/4	.38" [9.6 mm]	—	Out	Latch	18
	305A-LR	140 lbs. [64 kg]	Over	.75" [19.1 mm]	—	Out	Latch	18
	3301	150 lbs. [68 kg]	Over	.50" [12.7 mm]	—	—	—	19
	3307	150 lbs. [68 kg]	Over	.50" [12.7 mm]	—	Out	Latch	19
	3357	150 lbs. [68 kg]	Over	.50" [12.7 mm]	—	—	Latch	19
	3308	150 lbs. [68 kg]	Over	.50" [12.7 mm]	—	In and Out	Lever	19
	3634EC	150 lbs. [68 kg]	Over	.78" [19.8 mm]	Hold-in	—	Lever	19
Heavy-Duty Slides	301-2590	155 lbs. [70 kg]	Over	.75" [19.1 mm]	Hold-in	—	—	19
	301	175 lbs. [80 kg]	Over	.75" [19.1 mm]	—	—	—	21
	3601	225 lbs. [116 kg]	Over	.75" [19.1 mm]	Hold-in	—	—	21
	3600	273 lbs. [124 kg]	Full	.75" [19.1 mm]	Hold-in	—	—	22
	3607	273 lbs. [124 kg]	Full	.75" [19.1 mm]	—	Out	Lever	22
	3641	180 lbs. [82 kg]	Over	.89" [22.6 mm]	Hold-in	—	Rail	23
	3642	180 lbs. [82 kg]	Over	.89" [22.6 mm]	Hold-in	—	Rail	23
	3657	273 lbs. [124 kg]	Full	.75" [19.1 mm]	—	—	Lever	23
	7950	350 lbs. [159 kg]	Full	.75" [19.1 mm]	Hold-in	—	—	24
	7957	350 lbs. [159 kg]	Full	.75" [19.1 mm]	Hold-in	—	Lever	24
	9301	500 lbs. [227 kg]	Full	.75" [19.1 mm]	Hold-in	—	—	25
	9307	500 lbs. [227 kg]	Full	.75" [19.1 mm]	—	Out	—	26
	9308	500 lbs. [227 kg]	Full	.75" [19.1 mm]	—	In and Out	—	26
	AL4120	1,212 lbs. [550 kg]	3/4	1.42" [36 mm]	—	—	—	27
	AL4140	1,323 lbs. [600 kg]	Full	1.50" [38 mm]	—	—	—	27
Specialty Series Slides	CB-Hand	Slide Dependent	—	—	—	In and Out	—	29
	AL4190 Tilt-Track System	—	—	—	—	—	—	29
	115RC	265 lbs. [120 kg]	Linear	.48" [12.3 mm]	—	—	—	30
	CBLift-0019 Ascent	14.5 lbs. [6.6 kg]	21" [538 mm]	—	—	—	—	31
	115	Mounting Dependent	Linear	.43" [11.1 mm]	—	—	—	32
	SS2028	100 lbs. [45 kg]	3/4	.38" [9.6 mm]	Hold-in	—	—	32
	SS0330	143 lbs. [65 kg]	Full	.75" [19.1 mm]	Hold-in	—	—	33
Pocket & Bayonet	SS5321	352 lbs. [160 kg]	Over	.75" [19.1 mm]	Hold-in	—	—	33
	2120	75 lbs. [34 kg]	3/4	.50" [12.7 mm]	Hold-in	—	Lever	38
	3820	100 lbs. [45 kg]	Full	.50" [12.7 mm]	Hold-in	—	Lever	38
	3320	120 lbs. [55 kg]	Full	.50" [12.7 mm]	Hold-in	—	—	39
	3620	200 lbs. [91 kg]	Over	.75" [19.1 mm]	Hold-in	—	—	39
	9328	300 lbs. [136 kg]	Full	.75" [19.1 mm]	—	In and Out	—	40
	9322	300 lbs. [136 kg]	Full	.75" [19.1 mm]	—	—	—	40

To the design engineer:

This catalog is designed to assist you in making the proper slide selection for your application. The information listed on this spread provides an overview of the slides available and pertinent information to consider when selecting a slide. The following pages provide a more detailed look at slides and mounting hardware. Additional information, technical sheets, and specific design criteria is available at www.accuride.com.

Factors to consider when selecting a slide

- Weight of chassis /drawer
- Side space available between chassis /drawer and rack/cabinet
- Height, width, and depth of chassis /drawer
- Depth of rack/cabinet
- Travel desired
- Application-specific requirements
- Disconnect of chassis /drawer needed
- Locks needed
- Mounting holes needed
- Optional mounting hardware for mounting in rack or enclosure

Cross sections and load ratings

Load rating range is based on slide length. For more information, see the slide tables in this catalog or download the technical sheets from www.accuride.com.

Electronic Enclosures

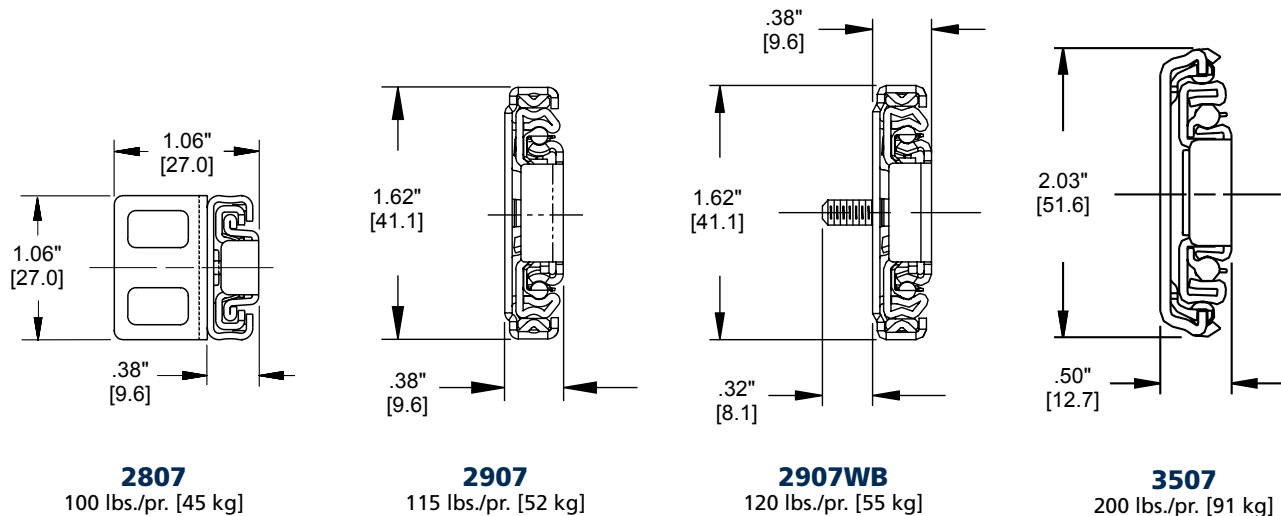

Light-Duty

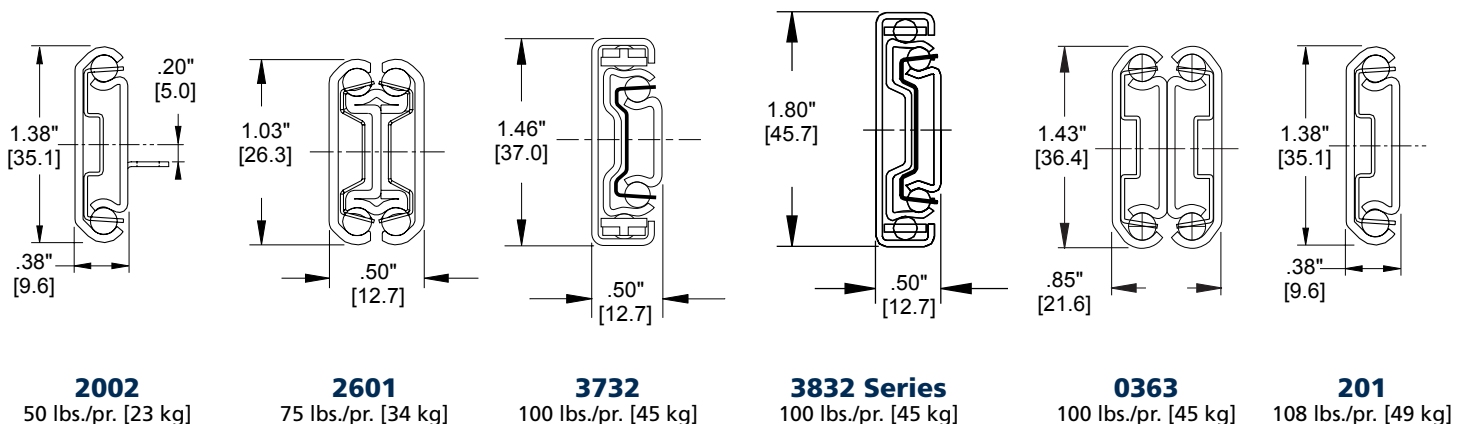

Medium-Duty

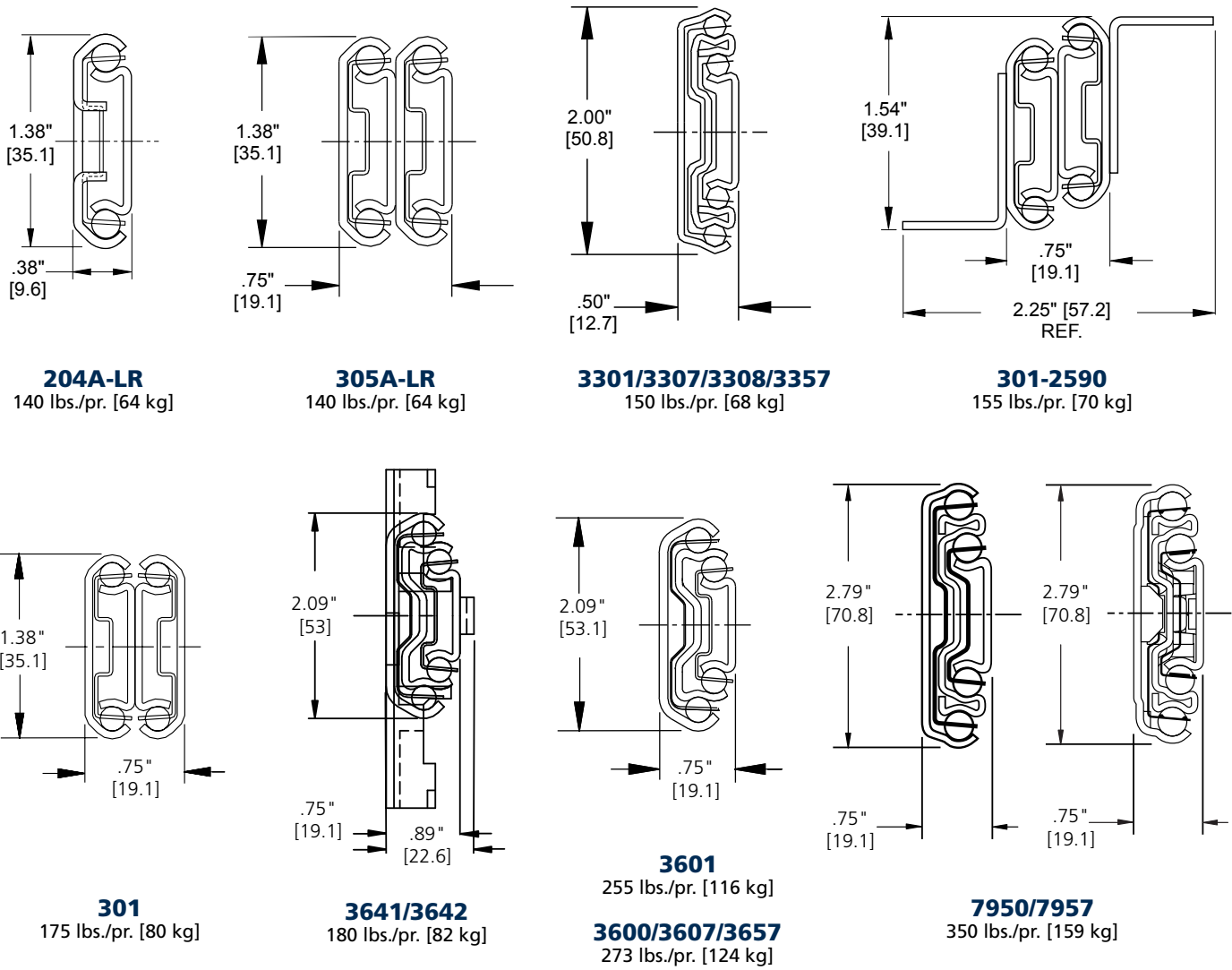

Heavy-Duty

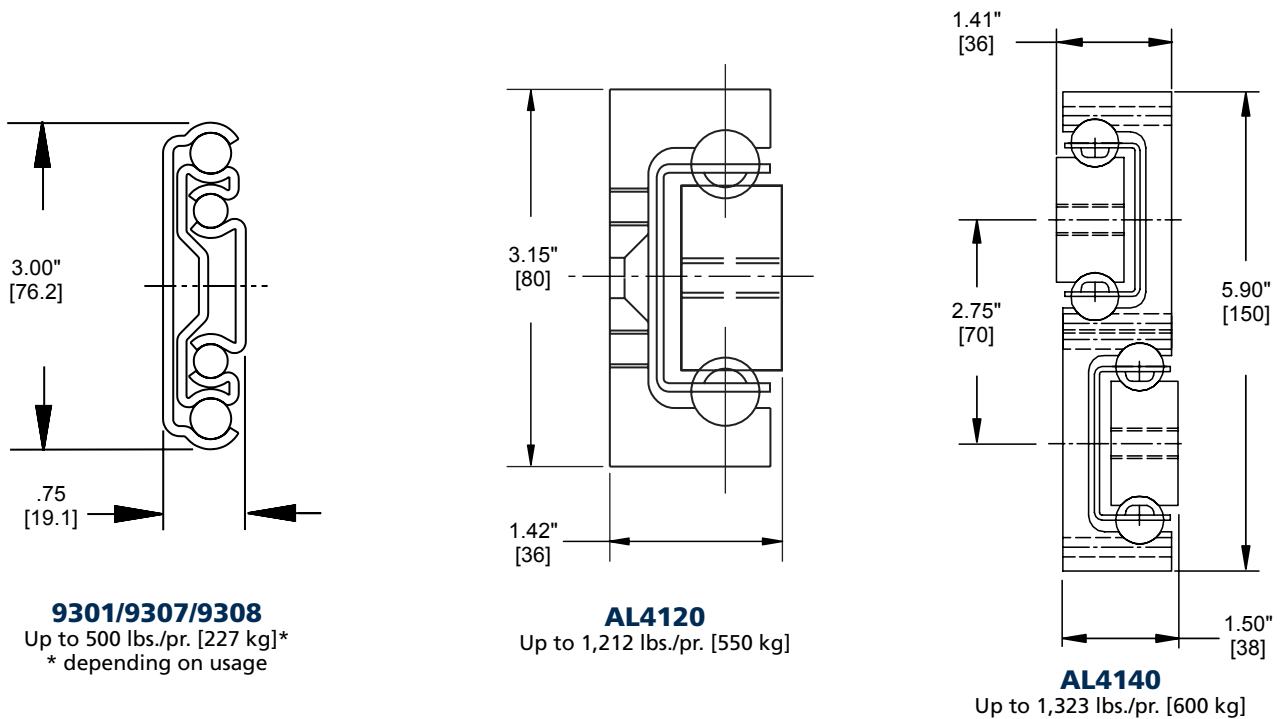

Pocket & Bayonet

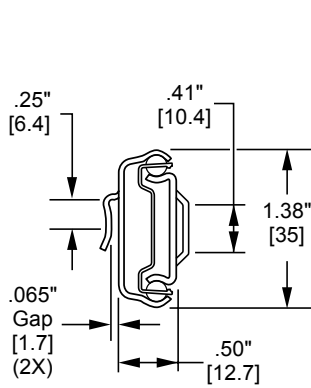

2120
Up to 75 lbs./pr. [50 kg]

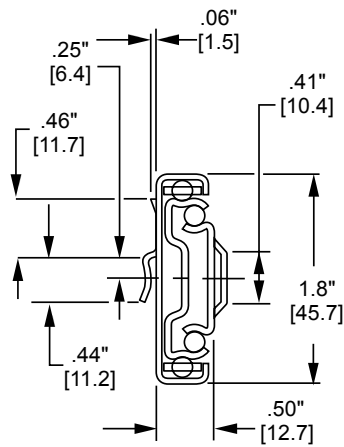

3820
Up to 100 lbs./pr. [50 kg]

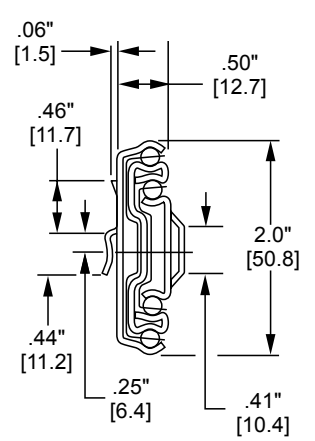

3320
Up to 120 lbs./pr. [55 kg]

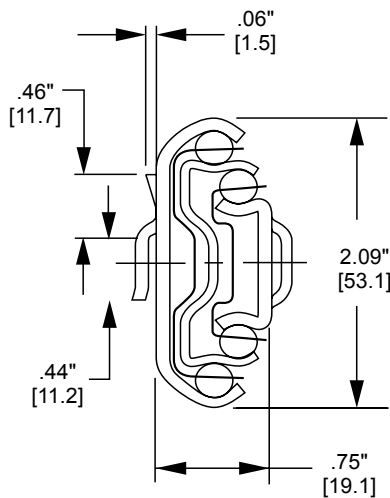

3620
Up to 200 lbs./pr. [91 kg]

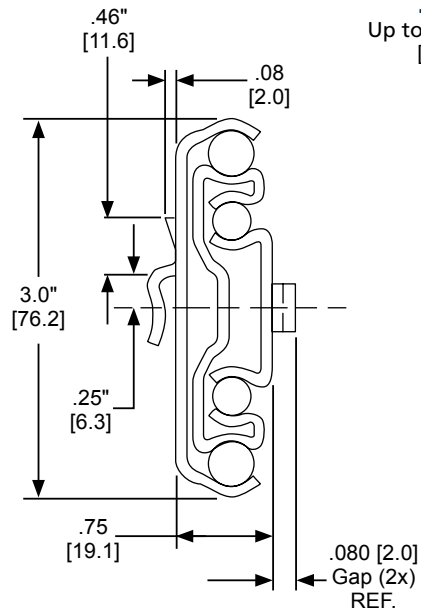

9328/9322
Up to 300 lbs./pr. [136 kg]*
* depending on usage

Specialty Slide Products

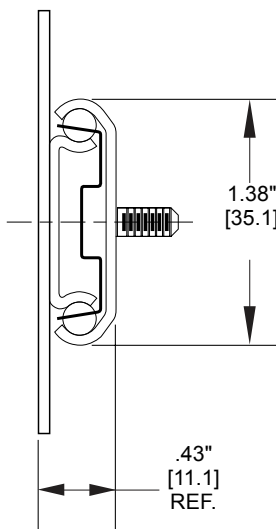

115
Side Mount: 100 lbs./pr. [50 kg]
Flat Mount: 132 lbs./pr. [60 kg]

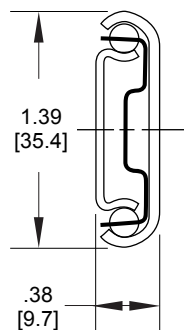

SS2028
100 lbs./pr. [50 kg]

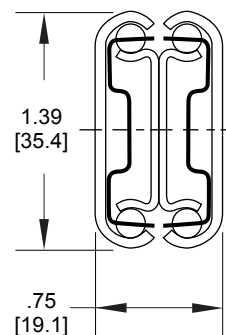

SS0330
143 lbs./pr. [65 kg]

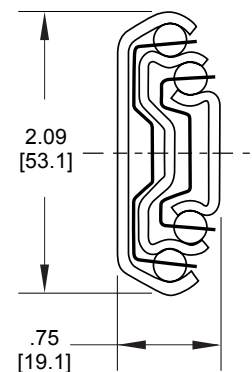

SS5321
352 lbs./pr. [160 kg]

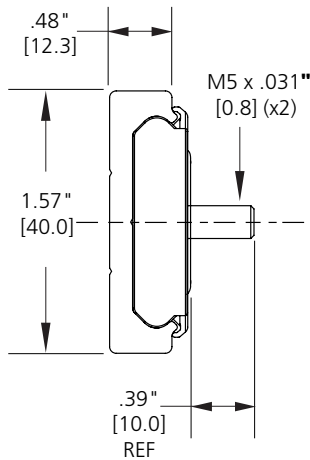

115RC
Up to 265 lbs. [120 kg]

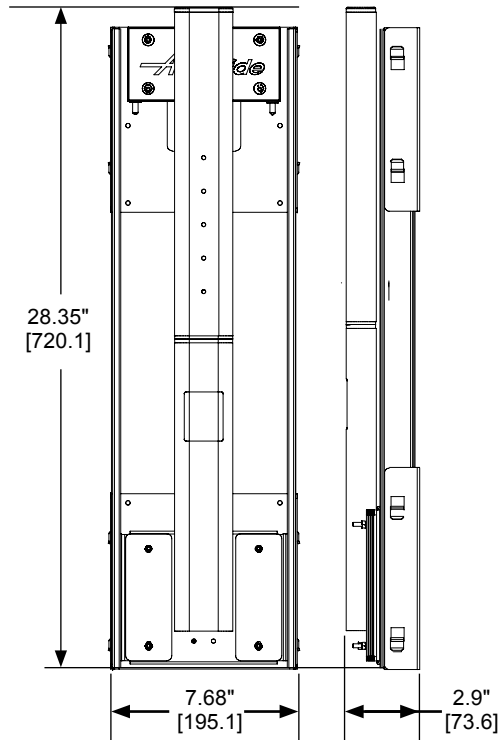

Ascent CBLift-0019
Up to 14.5 lbs. [6.6 kg]

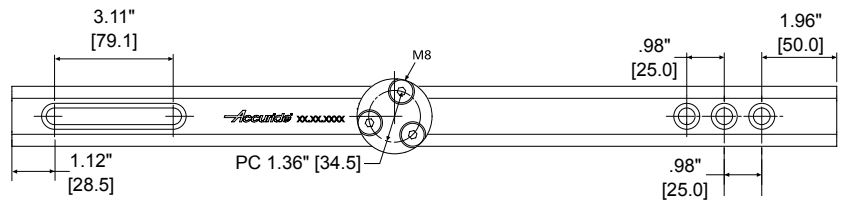
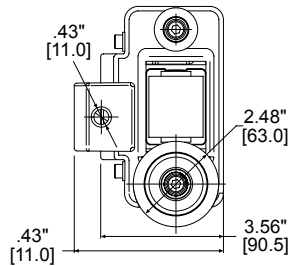
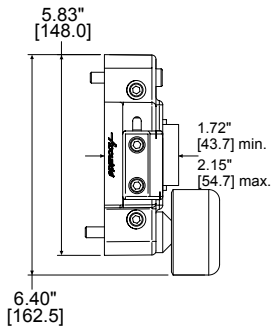

AL4190
Tilt Track System
Drawers up to 40" wide [1016 mm]

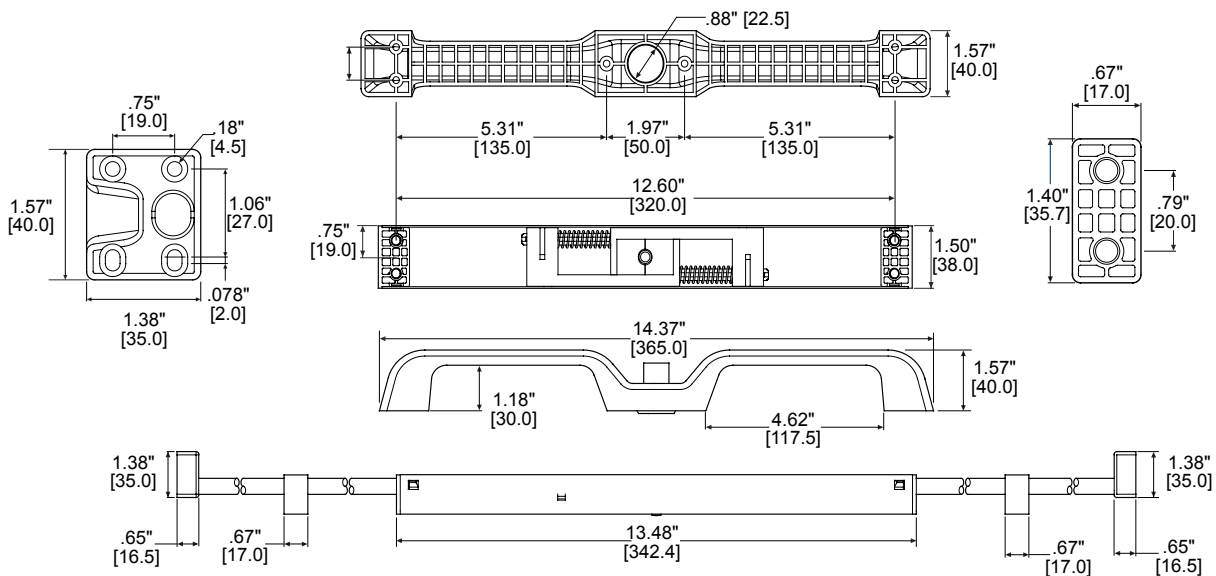

CB-Hand Locking Handle Kits
Drawers up to 60" wide [1524 mm]

Standard Test Criteria and Basis for Load Rating

1. Maximum permissible load for a pair of side-mounted slides.
2. Unless otherwise stated, the tested maximum load rating indicated is based on 18" long slides mounted on a 16" wide drawer.
3. The load's center of gravity is centered between and at the midpoint of the chassis/drawer members.
4. Unless otherwise stated, load ratings are based on 10,000 cycle dynamic tests.
5. Testing includes 100% static safety factor.
6. Unless otherwise stated, load ratings are based on side mounting the slides.
7. Unless otherwise stated, under (or flat) mounting of the slides is not recommended and reduces load carrying capacity to about 1/4 of the side-mount capacity.

Standard Test Criteria for Slides Designed for Electronic Enclosures

1. Life cycle counts for most enclosure applications is 1,000 cycles. Testing is based on 2,000 cycle dynamic tests, with 100% static safety factor.
2. Proof test: Additional weight is added to a fully loaded chassis within two inches of chassis front, for one hour.
3. Salt spray tested, using 5% salt spray (fog) for 48 hours.
4. Vibration testing is available upon request. Customer to supply test standards.
5. Load rating is based on bracket mounting of slides to cabinet.

Note: Because the slide performance may be affected by factors unique to a specific application, always test slides in the intended application.

Disconnect

Allows the drawer or chassis to be removed from the case or rack. A lever or latch must be actuated before the drawer can be removed from the cabinet.

Detent

Holds the slide open or closed until extra force is applied to overcome the detent.

Mechanical and Electronic Locks

Mechanical locks secure slides in an open or closed position. A lever or latch must be actuated to release the lock. Lock-out allows safe access to contents. Lock-in prevents drawers from opening, which is beneficial in mobile applications. Electronic locks secure and control access to openings, which remain locked until an activation device triggers the release (see page 28 for Electronic Locking products).

Mounting Brackets

Optional brackets are available to make it easier to mount slides in an electronics rack or enclosure. Please refer to the Rack Mounting Accessories Selection Guide at www.accuride.com.

Side Space

The side space is the amount of room required between the drawer side and the cabinet or the chassis and the rack. The side space dimension is critical for optimal smooth movement. For rack mount applications, special brackets are available for model 305A-LR. These brackets allow a portion of the slide to be mounted behind the vertical rail, reducing the necessary side space. See page 17 for an illustration.

Travel or Extension

3/4 Extension Drawer opens partially, approximately 3/4 of the total slide length.

Full Extension Drawer opens the same amount as the slide length.

Over Travel Drawer opens further than the length of the slide. This allows the drawer to pull completely out of the cabinet providing access to the entire drawer.

Hardware/Fasteners

Refer to individual product technical sheets for recommended hardware and/or fasteners.

Packaging

Standard Bulk Packaging

Slides and mounting hardware packed separately, one part number per box.

Optional D-Packaging

Package contains one pair of slides, mounting hardware, and installation instructions. To order, add a "D" to the end of the part number.

Standard Material Specifications

Steel Slides:	Slide members and-ball retainers: cold-rolled steel. Ball bearings: carburized steel.
Stainless Steel (SS):	Slide members, ball retainers, and ball bearings are stainless steel.
Aluminium (AL):	Slide members are aluminum, ball retainers and bearings are stainless steel
Standard C Finish:	Clear zinc electroplate
Optional CB Finish:	Black electroplate
Optional EW Finish:	White electrocoat
Optional CH Finish:	Weather-resistant
Lubricants:	Hi-Lo temperature grease Food-Safe available by special order
Temperature Range:	24.8°F (-4° C) to + 180°F (+82.2°C)



Electronic Enclosures

Slide Length	Slide Travel	Load Rating Lbs./Pr.
10.00	12.00	100
[254]	[305]	[45]
12.00	14.00	100
[305]	[356]	[45]
14.00	16.00	95
[356]	[406]	[43]
16.00	18.00	90
[406]	[457]	[40]
18.00	20.00	80
[457]	[508]	[36]
20.00	22.00	80
[508]	[559]	[36]
22.00	24.00	75
[559]	[610]	[34]
24.00	26.00	70
[610]	[660]	[31]
26.00	28.00	65
[660]	[711]	[29]
28.00	30.00	60
[711]	[762]	[27]
30.00	32.00	60
[762]	[813]	[27]



2807

Low profile with a narrow side space designed for 1U to 2U chassis

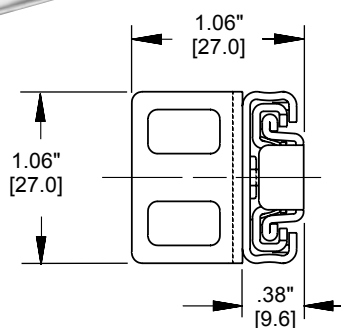
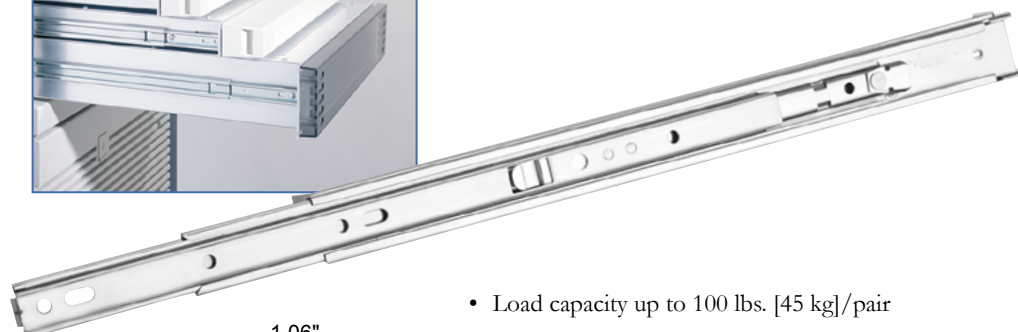

- Load capacity up to 100 lbs. [45 kg]/pair
- 2" [50.8 mm] over travel
- .38" [9.6 mm] side space
- Lock-out
- Latch disconnect
- Attached rear bracket provides 2" [50.8 mm] of adjustment
- Even lengths 10"–30" [254–762 mm]

Slide Length	Slide Travel	Load Rating Lbs./Pr.
12.00	14.00	60
[305]	[356]	[27]
14.00	16.00	80
[356]	[406]	[36]
16.00	18.00	100
[406]	[457]	[45]
18.00	20.00	115
[457]	[508]	[52]
20.00	22.00	114
[508]	[559]	[52]
22.00	24.00	112
[559]	[610]	[51]
24.00	26.00	110
[610]	[660]	[50]
26.00	28.00	110
[660]	[711]	[50]
28.00	30.00	110
[711]	[762]	[50]
30.00	32.00	110
[762]	[813]	[50]



2907

Low profile with a narrow side space designed for 1U to 4U chassis.

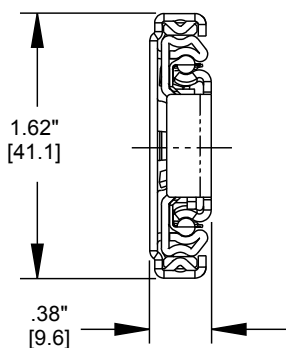
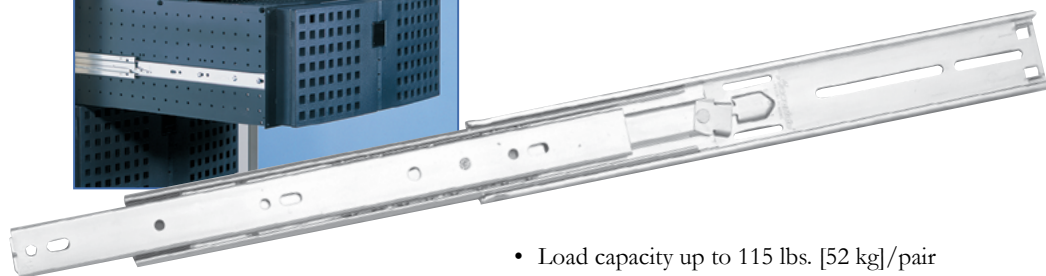

- Load capacity up to 115 lbs. [52 kg]/pair
- 2" [50.8 mm] over travel
- .38" [9.6 mm] side space
- Lock-out
- Lever disconnect
- Adjustable brackets included in standard packaging
- Even lengths 12"–30" [305–762 mm]



2907WB

Highly adaptable for 1U to 4U chassis in multiple rack configurations.

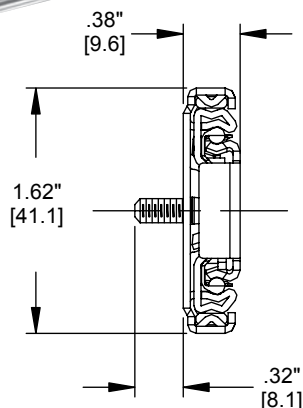
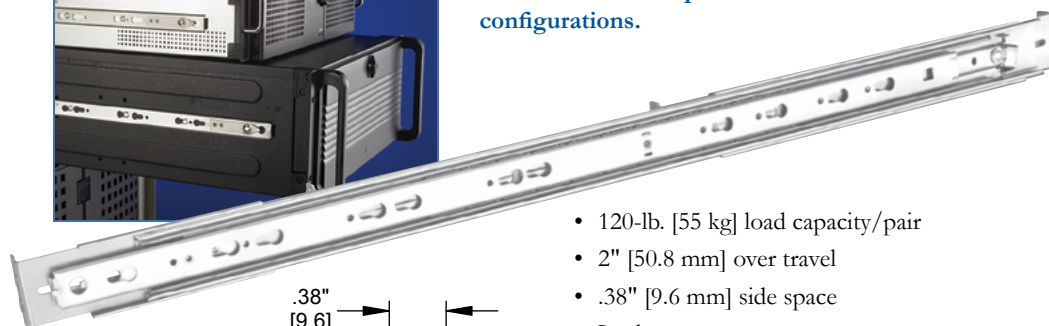

- 120-lb. [55 kg] load capacity/pair
- 2" [50.8 mm] over travel
- .38" [9.6 mm] side space
- Lock-out
- Lever disconnect
- Front and rear brackets (included) compatible with 5/8" and 1/2" pitch patterns, and dual 5/8" patterns
- Slide-to-chassis hole patterns accommodate screw or pin mounting
- Even lengths 22", 24", 26" [584–686 mm]

Part Number	Slide Length	Slide Travel
22WB	23.00 [584]	24.00 [610]
24WB	25.00 [635]	26.00 [660]
26WB	27.00 [686]	28.00 [711]

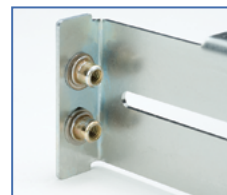

Reversible brackets fit all pitch patterns and provide more options for chassis positioning.



3507

Designed for heavy-duty chassis 4U to 8U.

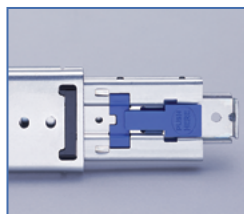
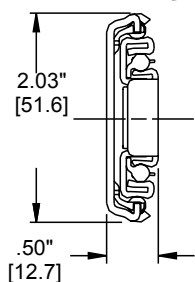
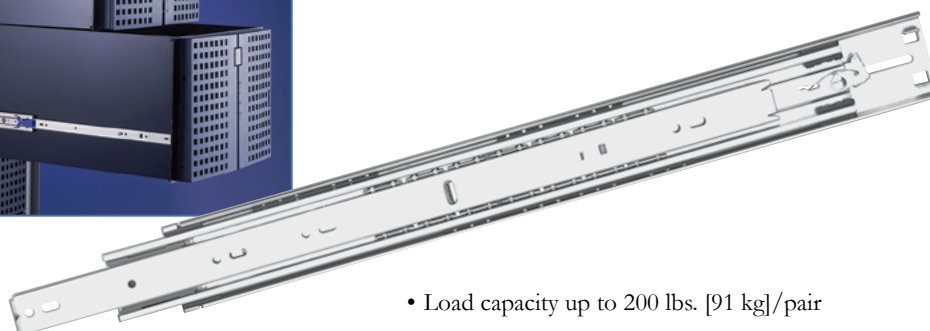

- Load capacity up to 200 lbs. [91 kg]/pair
- 2" [50.8 mm] over travel
- .50" [12.7 mm] side space
- Lock-out
- Latch disconnect
- One-Motion Insertion™ eases drawer insertion
- Even lengths 16"–30" [406–762 mm]
- Bracket mounting kit: P/N 4180-0480-XE

Slide Length	Slide Travel	Load Rating Lbs./Pr.
16.00 [406]	18.00 [457]	200 [90.8]
18.00 [457]	20.00 [508]	200 [90.8]
20.00 [508]	22.00 [559]	200 [90.8]
22.00 [559]	24.00 [610]	200 [90.8]
24.00 [610]	26.00 [660]	200 [90.8]
26.00 [660]	28.00 [711]	200 [90.8]
28.00 [711]	30.00 [762]	200 [90.8]
30.00 [762]	32.00 [813]	200 [90.8]

Cable Carriers

- Prevents sagging and tangling of cable when the chassis is moved.
- May be installed separately or as part of an Accuride chassis suspension system.
- Allows a minimum of 1" [25.4 mm] behind chassis when fully closed.



CC9

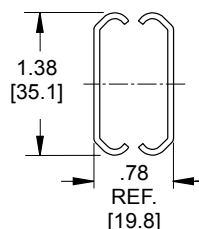

CC11

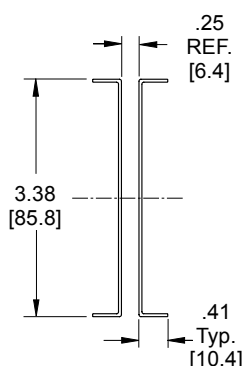

- **CC9-1 (Standard)**
23" [584 mm] long when fully extended
- **CC9-2 (Manufactured to order)**
29" [736 mm] long when fully extended
- Use with round cable
- Quick disconnect chassis fasteners
- For 2U and larger chassis
- Contact Accuride for 1U installation information
- **CC11**
28.24" [717 mm] when fully extended
- Use with ribbon cable
- Wide arm
- Use customer-approved cable ties

Mounting Brackets & General Mounting Instructions

- Brackets simplify the installation of Accuride slides in electronic enclosures.
- Brackets fit over slides and mount to vertical rail.
- Use Rack Mounting Accessories Selection Guide located on Accuride's web site to choose compatible brackets.
- For each pair of slides order:
 - 4 brackets (usually 2 front brackets and 2 rear brackets)
 - 4 bracket-to-slide mounting kits
 - 4 bar nuts
- Short brackets are usually used at the front of the chassis and long brackets are used at the rear for increased adjustability.

Mounting Instructions

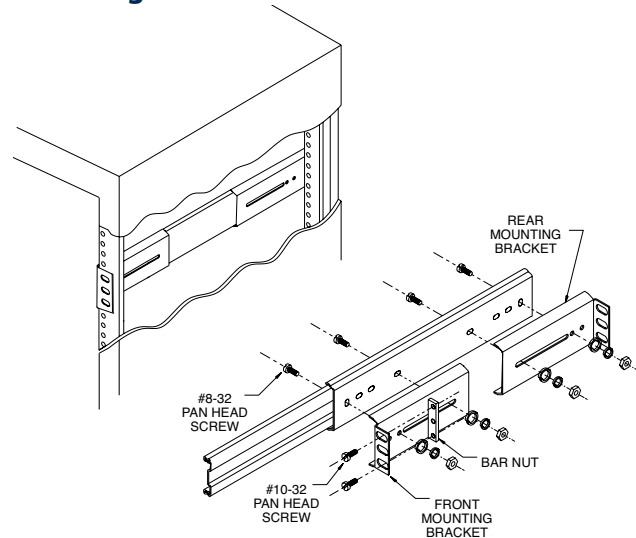

The mounting brackets shown on the following page are designed specifically for Accuride slides. Slides properly installed with the correct mounting brackets will provide lasting, maintenance-free service. The diagram at the left illustrates the correct orientation of the mounting screws when attaching the brackets to the slides.

To ensure proper operation of the slide, make certain that all bracket mounting screw heads are inserted so the screw heads are inside the slides. The front bracket should first be positioned, then securely fastened in place. The rear bracket screws should be left sufficiently loose to allow adjustment while fitting to the vertical mounting rails.

During installation in the enclosure, matching the alignment of the left hand and right hand slides is accomplished by installing one slide, then aligning it to the vertical mounting rails and securing the mounting screws. Then the other slide is installed, however the mounting screws are left sufficiently loose to permit horizontal adjustment. Moving the chassis in and out a few times prior to tightening the mounting screws will ensure proper alignment of the slides to each other and to the cabinet. Any sign of binding indicates lateral stress or misalignment.

Rack Mounting Brackets

Model Numbers	A	A	B	B	B	C	D	E	F
	Short	Long	4 Hole	3 Hole	2 Hole				
201, 204A-LR, 301	4.51 [114.6]	11.01 [279.7]	2.50 [63.5]	1.65 [41.9]	1.51 [38.4]	.72 [18.3]	.29 [7.4]	.66 [18.8]	.60 [15.2]
305A-LR	4.31 [109.5]	10.81 [274.6]	2.50 [63.5]	1.65 [41.9]	1.51 [38.4]	.78 [19.8]	.29 [7.4]	.72 [18.3]	.60 [15.2]
2907	3.04 [77.1]	6.04 [153.3]	-	1.74 [44.2]	-	.69 [17.4]	.213 [5.41]	.213 [5.41]	.63 [15.9]
	-	11.04 [280.4]	-	1.63 [41.4]	-	.69 [17.4]	.213 [5.41]	.213 [5.41]	.63 [15.9]
3301, 3307, 3308	4.51 [114.6]	11.01 [279.7]	2.50 [63.5]	1.75 [44.5]	1.75 [44.5]	.72 [18.3]	.29 [7.4]	.55 [14.0]	.60 [15.2]
3507	3.01 [77.6]	6.06 [153.8]	-	2.19 [55.7]	-	.70 [17.8]	.213 [5.41]	.213 [5.41]	.63 [15.9]
3601, 3607	4.74 [120.4]	11.00 [279.4]	2.50 [63.5]	-	-	.72 [18.3]	.29 [7.4]	.51 [13.0]	.60 [15.2]

- See Rack Mounting Accessories Selection Guide at accuride.com for ordering part numbers.
- Brackets shown below are for Models 201/204A-LR/301 and are shown for representation only.

SHORT BRACKET

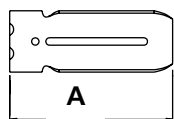

LONG BRACKET

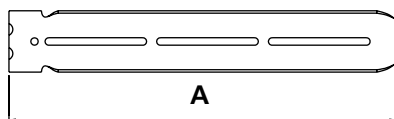

4-HOLE

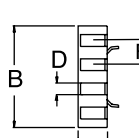

3-HOLE

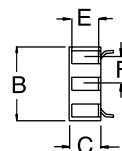

2-HOLE

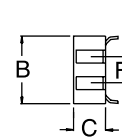

Bar Nuts

- Bar nuts simplify the installation and adjustment of Accuride slides in electronic enclosures
- It is easier to install bar nuts than individual nuts when access to the slide mounting bracket is limited
- Order 4 bar nuts per pair of slides

The following dimensions apply to all bar nuts:

Thickness of bar nut: .13 [3.2]

Width of bar nut: .38 [9.6]

Mounting holes: #10-32 thread

Mounting holes/center to edge: .14 [3.6]

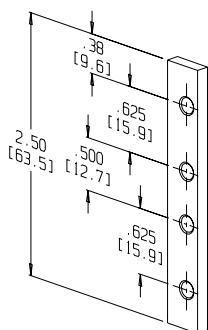

4100-0101-CE

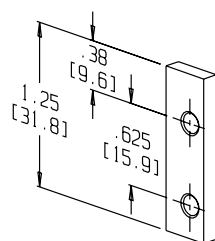

4100-0103-CE

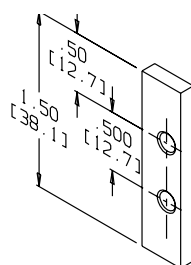

4100-0106-CE

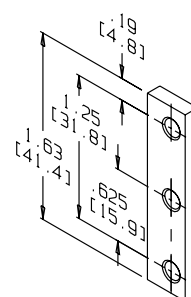

4130-0102-CE

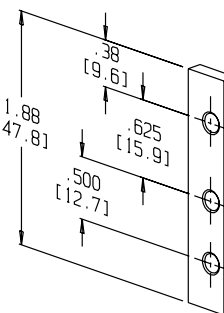

4100-0108-CE



Industrial Applications
Light-Duty Slides
from 75 to 139 pounds





2002

Works well on pass-through drawers in walls and machinery.



- Load capacity up to 50 lbs. [22.5 kg]/pair
- 3/4 extension
- .38" [9.7 mm] side space
- Drawers up to 12" [305 mm] wide
- Non-disconnect
- Even lengths 12"–28" [305–711 mm]

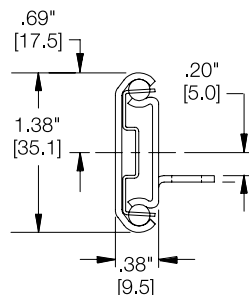

Slide Length	Front/Rear Travel
12.00 [305]	9.00 [229]
14.00 [356]	11.00 [279]
16.00 [406]	12.00 [305]
18.00 [457]	13.00 [330]
20.00 [508]	15.00 [381]
22.00 [559]	16.00 [406]
24.00 [610]	17.00 [432]
26.00 [660]	19.00 [483]
28.00 [711]	20.0 [508]



2601

Ideal for use in tool boxes, laboratory furniture, and store fixtures.



- Load capacity up to 75 lbs. [34 kg]/pair
- Full extension
- .50" [12.7 mm] side space
- Hold-in detent
- Non-disconnect
- Even lengths 8"–22" [200–550 mm]

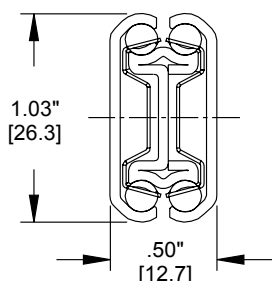

Slide Length	Slide Travel	Load Rating Lbs./Pr.
7.87 [200]	8.23 [209]	35 [16]
9.84 [250]	10.20 [259]	50 [23]
11.81 [300]	12.13 [308]	70 [32]
13.78 [350]	14.06 [357]	75 [34]
15.75 [400]	15.98 [406]	70 [32]
17.72 [450]	17.95 [456]	65 [30]
19.69 [500]	19.88 [505]	63 [29]
21.65 [550]	21.81 [554]	60 [27]



3732

A low profile slide suitable for shallow drawers.



- Load capacity up to 100 lbs. [45 kg]/pair
- Full extension
- .50" [12.7 mm] side space
- Hold-in detent
- Unhanded push latch disconnect
- Even lengths 12"–28" [300–700 mm]

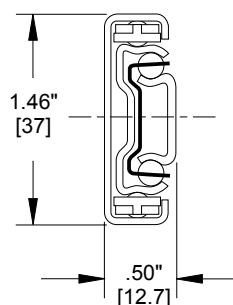

Slide Length	Slide Travel	Load Rating Lbs./Pr.
11.81 [300]	11.50 [292]	60 [27]
13.78 [350]	14.00 [355]	75 [34]
15.75 [400]	16.00 [406]	100 [45]
17.72 [450]	18.00 [457]	100 [45]
19.69 [500]	20.00 [508]	100 [45]
21.65 [550]	22.00 [559]	100 [45]
23.62 [600]	24.00 [610]	85 [39]
25.59 [650]	26.00 [660]	70 [32]
27.56 [700]	28.00 [711]	60 [27]

Slide Length	Slide Travel	Load Rating Lbs./Pr.
5.84 [148]	5.5 [140]	40 [18]
7.84 [199]	8.00 [203]	45 [20]
9.84 [250]	9.57 [243]	50 [23]
11.81 [300]	12.00 [305]	60 [27]
13.78 [350]	14.00 [355]	75 [34]
15.75 [400]	16.00 [406]	100 [45]
17.72 [450]	18.00 [457]	100 [45]
19.69 [500]	20.00 [508]	100 [45]
21.65 [550]	22.00 [559]	100 [45]
23.62 [600]	24.00 [610]	85 [39]
25.59 [650]	26.00 [660]	70 [32]
27.56 [700]	28.00 [711]	60 [27]



3832 Series

These full extension slides offer a host of features well suited for drawers or pull-out trays in medical, industrial, or mobile storage projects.



Common Features

- Load capacity up to 100 lbs. [45 kg]/pair
- Full extension
- .50" [12.7 mm] side space
- Lever disconnect

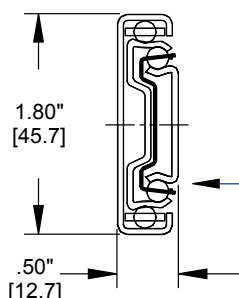

3832



- Hold-in detent
- Even lengths 6"-28" [148-700 mm]

3832SC

Self-Closing

- 100-lb. [45 kg] load rating
- Unique self-closing device
- Full extension
- Even lengths 14"-26" [350-650 mm]

3832HDSC

Heavy-Duty Self-Closing

- Stronger self-closing device
- Optional white electrocoat finish
- Even lengths 12"-28" [300-700 mm]

3832TR/HDTR

Standard & Heavy-Duty Touch Release

- 3832TR: 11 pounds of force to activate
- 3832HDTR: 17-19 pounds of force to activate
- Hold-in feature keeps drawers closed
- Opening mechanism requires 1/16" travel inward to activate
- Propels drawers open approximately 2" from the closed position
- Even lengths 12"-28" [300-700 mm]

CH3832

Weather-Resistant



- Special coating provides eight times more protection than standard zinc finish
- Stainless steel ball retainer, ball bearings, and rivets
- Even lengths 10"-28" [250-700 mm]

3832EC



Easy-Close

- Brings drawers to a smooth, gentle close
- Even lengths 14"-28" [350-700 mm]

3832DO

Detent-Out

- Detent-out holds drawers in an open position
- Even lengths 10"-28" [250-700 mm]



0363

Full extension and two-way travel provide access for carts, drive-through window drawers, and more.

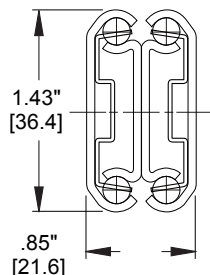

- Load capacity up to 100 lbs. [45 kg]/pair*
- Full extension from center point in both directions
- Hold-in detent at center
- .85" [21.6 mm] side space
- Non-disconnect
- Tested to 80,000 cycles
- Available lengths: 16", 20", 24", and 28" [400 mm, 500 mm, 600 mm, 700 mm]

Slide Length	Slide Travel (x2)	Load Rating Lbs./Pr.*
15.75 [400]	34.00 [864]	88 [40]
19.69 [500]	42.00 [1064]	100 [45]
23.62 [600]	50.00 [1264]	100 [45]
27.55 [700]	58.00 [1464]	88 [40]

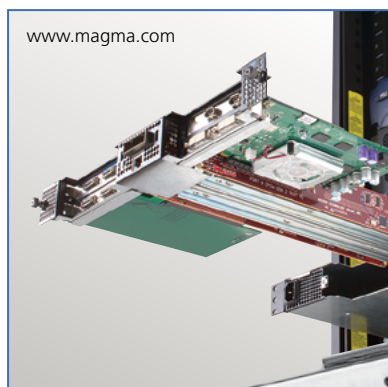

201

Good for POP displays, industrial workstations, or medical applications.

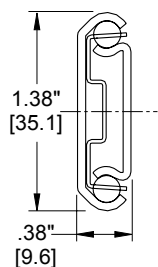

- Load capacity up to 108 lbs. [49 kg]/pair
- 3/4 extension
- .38" [9.6 mm] side space
- Non-disconnect
- Hold-in detent
- Even lengths 12"–28" [305–711 mm]
- Optional enclosure bracket mounting kit: P/N 4180-0222-XE

Slide Length	Slide Travel	Load Rating Lbs./Pr.
12.00 [305]	9.00 [229]	108 [49]
14.00 [356]	11.00 [279]	103 [47]
16.00 [406]	12.00 [305]	95 [43]
18.00 [457]	13.00 [330]	90 [41]
20.00 [508]	15.00 [381]	82 [37]
22.00 [559]	16.00 [406]	75 [34]
24.00 [610]	17.00 [432]	67 [30]
26.00 [660]	19.00 [483]	60 [27]
28.00 [711]	20.00 [508]	55 [25]

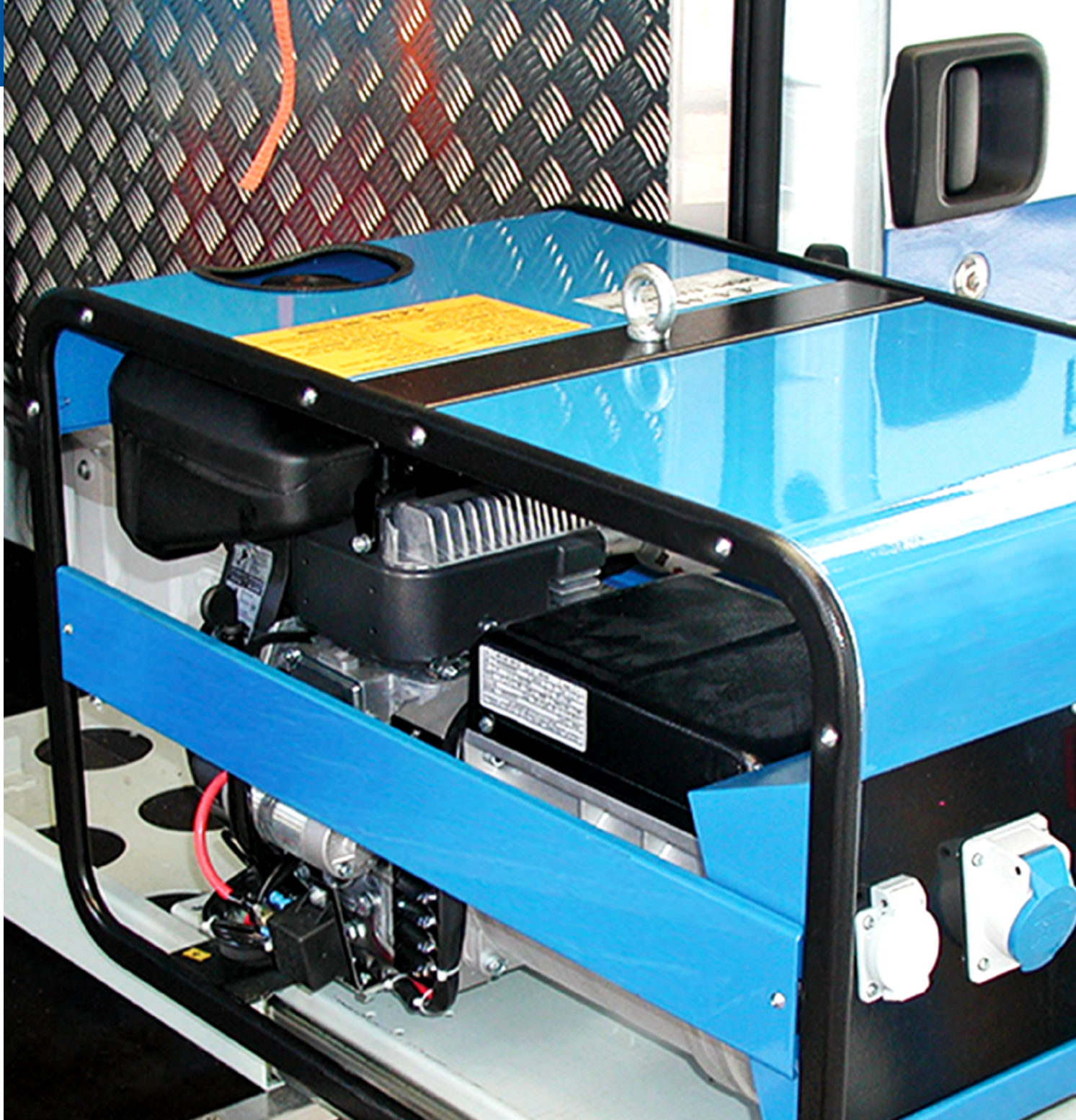

Industrial Applications
Medium-Duty Slides
from 140 to 169 pounds



204A-LR

A lock-out feature holds drawers in an open position for safe access.



Latch Disconnect

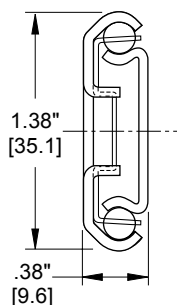

- Load capacity up to 140 lbs. [64 kg]/pair
- 3/4 extension
- .38" [9.6 mm] side space
- Lock-out
- Latch disconnect
- Even lengths 12"–28" [305–711 mm]
- Optional enclosure bracket mounting kit: P/N 4180-0222-XE

Slide Length	Slide Travel	Load Rating Lbs./Pr.
12.00 [305]	8.00 [203]	140 [64]
14.00 [356]	10.00 [254]	130 [59]
16.00 [406]	12.00 [305]	120 [55]
18.00 [457]	13.00 [330]	110 [50]
20.00 [508]	15.00 [381]	92 [42]
22.00 [559]	16.00 [406]	85 [39]
24.00 [610]	17.00 [432]	78 [35]
26.00 [660]	19.00 [483]	70 [32]
28.00 [711]	20.00 [508]	60 [27]

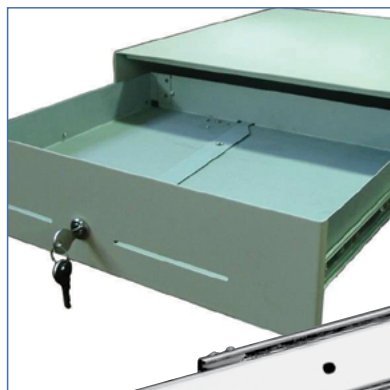

305A-LR

Suitable for both industrial and enclosure applications. Lock-out and over travel offer secure and complete access.



Latch Disconnect

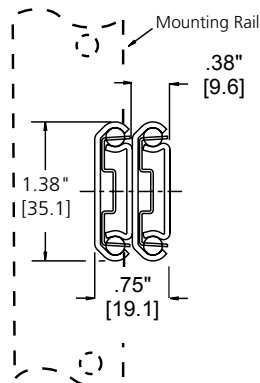

- Load capacity up to 140 lbs. [64 kg]/pair
- .88" [22.4 mm] over travel
- .38" [9.6 mm] when mounted with optional brackets
- Latch disconnect
- Lock-out
- Rack mounting equipment:
- Special brackets allow Model 305A-LR to be partially mounted behind the vertical rails, requiring only .38" [9.6 mm] side space.
- Bracket kit: P/N 4180-0223-XE
- Even lengths 12"–28" [305–711 mm]

Slide Length	Slide Travel	Load Rating Lbs./Pr.
12.00 [305]	12.88 [327]	140 [64]
14.00 [356]	14.88 [378]	132 [60]
16.00 [406]	16.88 [429]	125 [57]
18.00 [457]	18.88 [480]	116 [53]
20.00 [508]	20.88 [530]	107 [49]
22.00 [559]	22.88 [581]	100 [45]
24.00 [610]	24.88 [632]	93 [42]
26.00 [660]	26.88 [683]	86 [39]
28.00 [711]	28.88 [734]	80 [36]



3301•3307•3357•3308

Offers over travel for full access and mid-range load capacity in a narrower profile.

Common Features

- Load capacity up to 150 lbs. [68 kg]/pair
- 1" [25.4 mm] over travel
- .50" [12.7 mm] side space

Model 3307

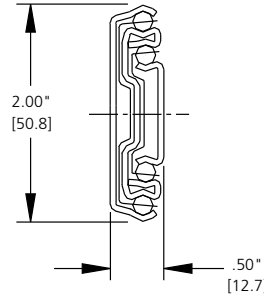

3301

- Non-disconnect
- Even lengths 12"–28" [305–711 mm]

3307

- Latch disconnect
- Lock-out
- Even lengths 12"–30" [305–762 mm]

3357

- Latch disconnect
- Even lengths 12"–30" [305–762 mm]

3308

- Lever disconnect
- Lock-in and lock-out
- Even lengths 12"–28" [305–711 mm]

Optional Bracket Mounting Kit

3301/3307/3308—for enclosure or rack mount applications: **P/N 4180-0219-XE**

Slide Length	Slide Travel
12.00 [305]	13.00 [330]
14.00 [356]	14.00 [356]
16.00 [406]	16.00 [432]
18.00 [457]	19.00 [483]
20.00 [508]	21.00 [533]
22.00 [559]	23.00 [584]
24.00 [610]	25.00 [635]
26.00 [660]	27.00 [686]
28.00 [711]	29.00 [737]



3634EC

Overtravel with Easy-Close action for heavier and wider drawers up to 42".



- Load capacity up to 150 lbs. [68 kg]/pair
- 1" [25.4 mm] over travel
- .78" [19.8 mm] side space
- Cabinet member hole pattern matches models 3832/3834
- Hold-in detent
- Lever disconnect
- Even lengths 14"–28" [355–711 mm]

NOTE: 14" length of this product is full extension

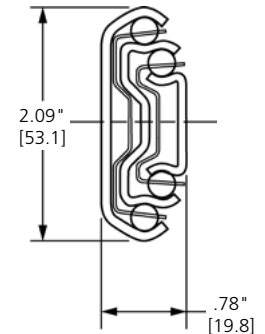

Slide Length	Slide Travel	Load Rating Lbs./Pr.
12.00 [305]	12.83 [326]	155 [70]
14.00 [356]	14.83 [377]	148 [67]
16.00 [406]	16.83 [427]	140 [64]
18.00 [457]	18.83 [478]	130 [59]
20.00 [508]	20.83 [529]	122 [55]
22.00 [559]	22.83 [580]	113 [51]
24.00 [610]	24.83 [631]	104 [47]
26.00 [660]	26.83 [681]	95 [43]
28.00 [711]	28.83 [732]	85 [39]

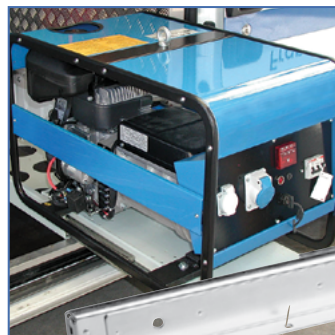

301-2590

Mounts to top or bottom of cases; suitable for storage trays or shelves for items such as batteries or generators.

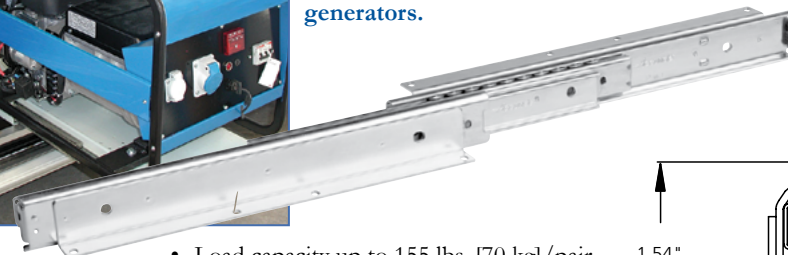

- Load capacity up to 155 lbs. [70 kg]/pair
- .83" [21 mm] over travel
- .75" [19.1 mm] side space (not including mounting flanges)
- Undercarriage mount
- Hold-in detent
- Non-disconnect
- Even lengths 12"–28" [305–711 mm]

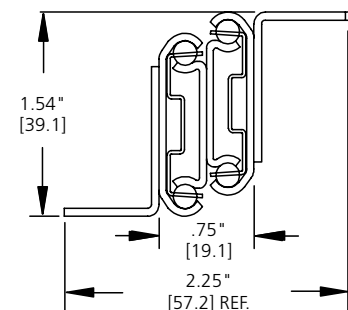



Industrial Applications

Heavy-Duty Slides

from 170 to 1,323 pounds



Slide Length	Slide Travel	Load Rating Lbs./Pr.
12.00 [305]	12.88 [327]	175 [80]
14.00 [356]	14.88 [378]	170 [77]
16.00 [406]	16.88 [429]	160 [73]
18.00 [457]	18.88 [480]	150 [68]
20.00 [508]	20.88 [530]	142 [65]
22.00 [559]	22.88 [581]	130 [59]
24.00 [610]	24.88 [632]	115 [52]
26.00 [660]	26.88 [683]	105 [48]
28.00 [711]	28.88 [734]	90 [41]



301

Low profile and over travel provide access in electronic enclosures, medical equipment and electromechanical devices.

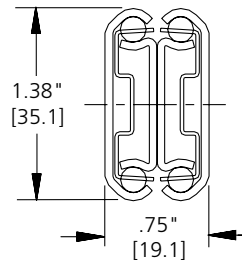

- Load capacity up to 175 lbs. [80 kg]/pair
- .88" [22.4 mm] over travel
- .75" [19.1 mm] side space
- Non-disconnect
- Even lengths 12"–28" [305–711 mm]
- **Optional enclosure bracket mounting kit:**
P/N 4180-0222-XE

Slide Length	Slide Travel	Load Rating Lbs./Pr.
12.00 [305]	13.00 [330]	255 [116]
14.00 [356]	15.00 [381]	248 [112]
16.00 [406]	17.00 [432]	241 [109]
18.00 [457]	19.00 [483]	234 [106]
20.00 [508]	21.00 [533]	225 [102]
22.00 [559]	23.00 [584]	215 [98]
24.00 [610]	25.00 [635]	203 [92]
26.00 [660]	27.00 [686]	188 [85]
28.00 [711]	29.00 [737]	169 [77]



3601

Over travel and heavy-duty capacity make this slide a popular choice for utility and industrial truck bodies, machine tools and mechanical devices.

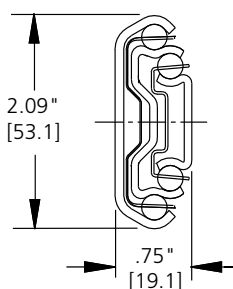

- Load capacity up to 255 lbs. [116 kg]/pair
- 1" [25.4 mm] over travel
- .75" [19.1 mm] side space
- Non-disconnect
- Hold-in detent
- Even lengths 12"–28" [305–711 mm]
- **Optional enclosure bracket mounting kit:**
P/N 4180-0220-XE

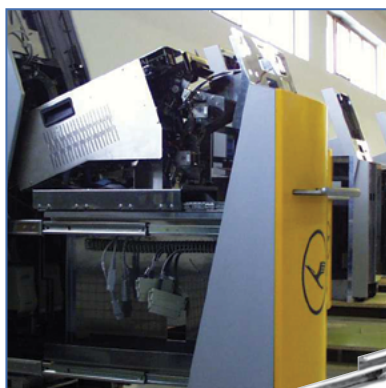

3600

Full extension and the higher load rating perform well in industrial workstations, machinery, and mechanical devices.

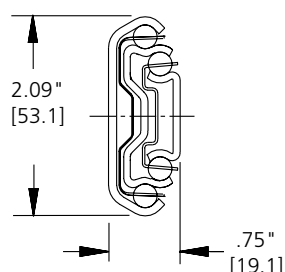
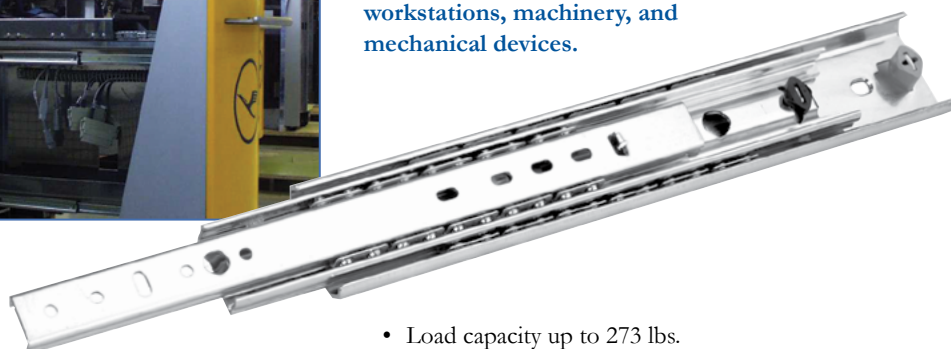

- Load capacity up to 273 lbs. [124 kg]/pair
- Full extension
- .75" [19.1 mm] side space
- Non-disconnect
- Hold-in detent
- Even lengths 12"–28" [305–711 mm]

Slide Length	Slide Travel	Load Rating Lbs./Pr.
12.00 [305]	12.00 [305]	273 [124]
14.00 [356]	14.00 [356]	267 [121]
16.00 [406]	16.00 [406]	261 [118]
18.00 [457]	18.00 [457]	253 [115]
20.00 [508]	20.00 [508]	244 [111]
22.00 [559]	22.00 [559]	233 [106]
24.00 [610]	24.00 [610]	220 [100]
26.00 [660]	26.00 [660]	203 [92]
28.00 [711]	28.00 [711]	182 [83]

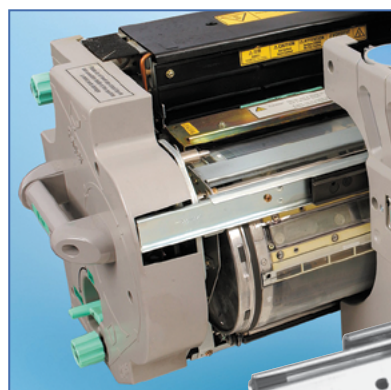

3607

Lock-out and lever disconnect are useful in applications such as machinery or electronic chassis where components may require service.

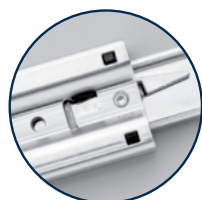

Lever Disconnect

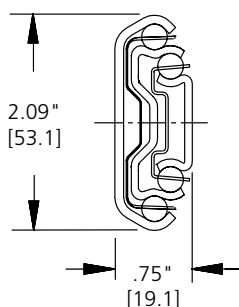

- Load capacity up to 273 lbs. [124 kg]/pair
- Full extension
- .75" [19.1 mm] side space
- Lever disconnect
- Lock-out
- Optional enclosure mounting brackets available
- Even lengths 12"–28" [305–711 mm]

Slide Length	Slide Travel	Load Rating Lbs./Pr.
12.00 [305]	12.00 [305]	273 [124]
14.00 [356]	14.00 [356]	267 [121]
16.00 [406]	16.00 [406]	261 [119]
18.00 [457]	18.00 [457]	253 [115]
20.00 [508]	20.00 [508]	244 [111]
22.00 [559]	22.00 [559]	233 [106]
24.00 [610]	24.00 [610]	220 [100]
26.00 [660]	26.00 [660]	203 [92]
28.00 [711]	28.00 [711]	182 [83]

Slide Length	Slide Travel
12.00 [305]	12.00 [305]
14.00 [356]	14.00 [356]
16.00 [406]	16.00 [406]
18.00 [457]	18.00 [457]
20.00 [508]	20.00 [508]
22.00 [559]	22.00 [559]
24.00 [610]	24.00 [610]
26.00 [660]	26.00 [660]
28.00 [711]	28.00 [711]



www.embertonmachine.com

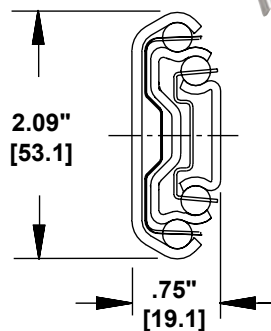

3657

Provides solutions for applications such as bulk storage bins, trays, or pullout shelving units in environments ranging from garages to game rooms to grocery stores.



- Load capacity up to 273 lbs. [124 kg]/pair
- Full extension
- .75" [19.1 mm] side space
- Lever disconnect
- Even lengths 12"-28" [305–722 mm]

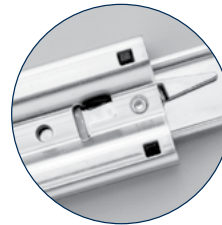

Lever Disconnect

Slide Length	Slide Travel
13.90 [353]	14.00 [356]
15.90 [404]	17.00 [432]
16.90 [429]	18.00 [457]
17.90 [455]	19.00 [483]
19.90 [505]	21.00 [533]
21.90 [556]	23.00 [584]
23.90 [607]	25.00 [635]
25.90 [658]	27.00 [686]
27.90 [709]	29.00 [737]

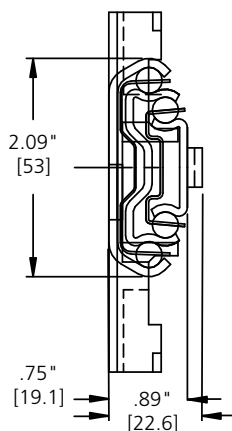

3641

Designed with an interlock system to prevent more than one drawer from opening at a time. Ideal for heavy multi-drawer applications where tipping might occur due to weight shift.

3642 Non-locking Companion Slide

- Load capacity up to 180 lbs. [82 kg]/pair
- 1" [25.4 mm] over travel
- .89" [22.6 mm] side space
- Drawers up to 42" [1067 mm] wide
- One piece rail-and-pocket mount/disconnect system
- Front location of interlock eliminates reaching during installation
- Interfaces with central locking system
- Cut-to-length aluminum connecting rods
- Hold-in detent
- Even lengths 14"–28" and 17" [353–709 and 429 mm]

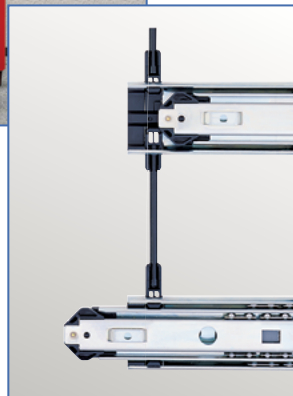

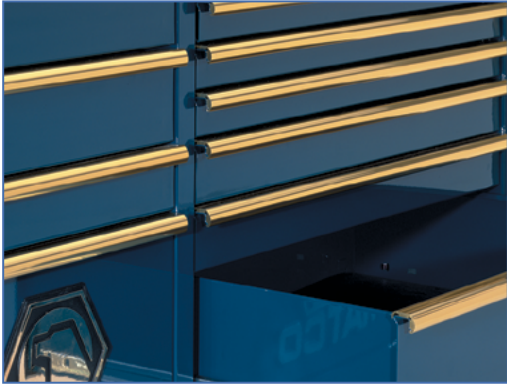

7950/7957

These products provide an intermediate load rating choice in a .75" cross section width. Designed to accommodate drawers up to 42" wide.



Model 7957



Model 7950

- May be side or flat mounted:
 - Side mount load capacity up to 350 lbs. [159 kg]/pair
 - Flat mount load capacity up to 150 lbs. [68 kg]/pair
- Full extension
- .75" [19.1 mm] side space
- 7950: non-disconnect
7957: handed lever disconnect
- Bridged ball retainer design prevents retainer migration.
- Even lengths 12"–36" [305–914 mm]

Slide Length	Slide Travel
12.00	12.00
[305]	[305]
14.00	14.00
[356]	[356]
16.00	16.00
[406]	[406]
18.00	18.00
[457]	[457]
20.00	20.00
[508]	[508]
22.00	22.00
[559]	[559]
24.00	24.00
[610]	[610]
26.00	26.00
[660]	[660]
28.00	28.00
[711]	[711]
30.00	30.00
[762]	[762]
32.00	32.00
[813]	[813]
34.00	34.00
[864]	[864]
36.00	36.00
[914]	[914]

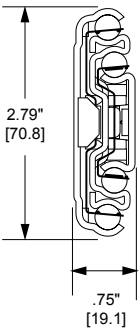

7950
Non-Disconnect

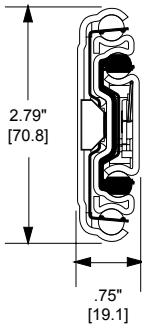

7957
Handed
Lever
Disconnect

NOTE: Available by special order: Models 7937 (lever disconnect) and 7930 (non-disconnect), which offer the same features in a narrower cross section width of .724" [18.4 mm].



9301

Offering heavy duty support in a variety of industrial storage applications.
Optional platform brackets expand mounting options.

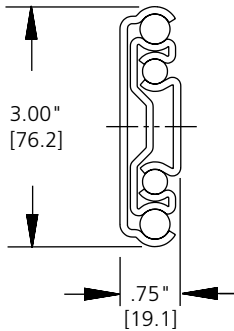
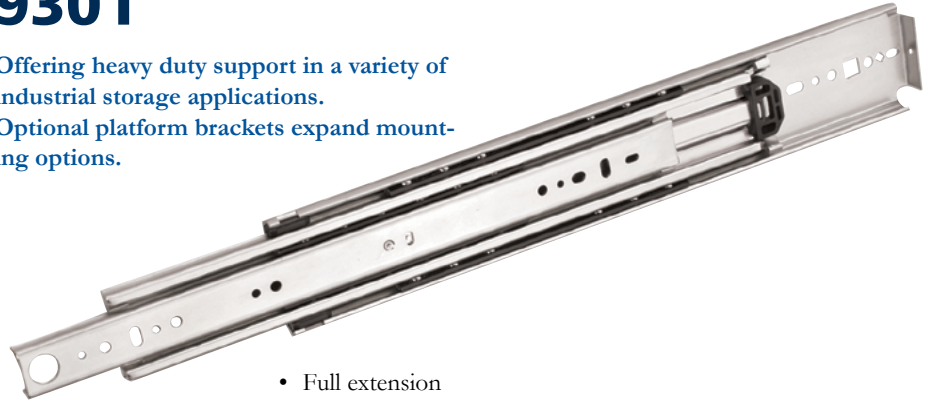

- Full extension
- .75" [19.1 mm] side space
- Silenced movement
- Non-disconnect
- Available in even lengths 10"-36", 40", 42", 44", 48", 60"
[254-914 mm, 1016 mm, 1066 mm, 1118 mm, 1219 mm, 1524 mm]

Load Ratings/pair

- Flat mount: 150 lb. [68 kg]*
Drawer widths up to 32" [813 mm]
- Mobile applications: 300 lb. [136 kg]*
Drawer widths up to 32" [813 mm]
- Frequent usage: 400 lb. [181 kg]
Drawer widths up to 42" [1067 mm]
- Moderate usage: 500 lb. [227 kg]*
Drawer widths up to 18" [457 mm]
- Bracket-mounted: 350 lb. [159 kg]
Drawer widths up to 42" [1067 mm]
- Bracket-mounted: 500 lb. [227 kg]
Drawer widths up to 18" [457 mm]

Note: Special packaging is available which includes one standard 9301 and one right-hand 9308. Available lengths: 14"-36", 40", 42", 48", and 60". The part number for this packaging is 9308-5.

Platform Brackets

For use with Models 9301, 9307, and 9308

- Provides 6 additional mounting configurations
- Available in lengths of 12", 16", 22", and 28"
[305 mm, 406 mm, 559 mm, 711 mm]
- Four bracket lengths have been designed to be used individually or combined to accommodate all slide lengths
- See technical sheet for ordering information.

SIDE MOUNT APPLICATIONS

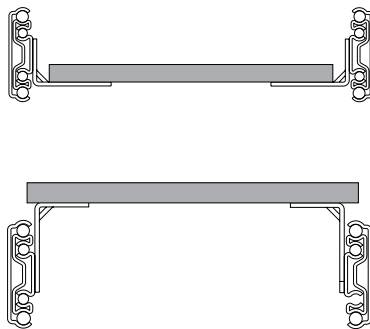

BOTTOM MOUNT APPLICATIONS

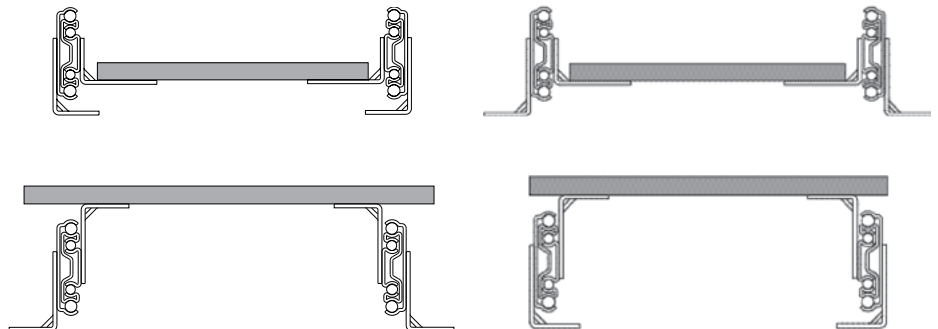

* For lengths 10"-36" [254-914 mm]. Consult Accuride for load ratings for longer slide lengths. See 9301 technical sheet for additional load rating information.



Model 9308

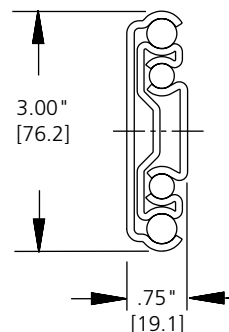

9307 Lock-out

Heavy duty with a lock-out for applications where secure access to equipment drawers and trays is required.

9308 Lock-in & Lock-out

Lock-in and lock-out features to ensure drawers stay securely closed during transit in applications such as emergency or hazmat vehicles.

Load Ratings/pair

Mobile applications:

- 300 lbs. [136 kg]*
- Drawer widths up to 32" [813 mm]

Frequent usage:

- 400 lbs. [181 kg]**
- Drawer widths up to 42" [1067 mm]

Moderate usage:

- 500 lbs. [227 kg]*
- Drawer widths up to 18" [457 mm]

* Load ratings based on 10,000 cycle test

** Load rating based on 50,000 cycle test

Common Features

- Full extension
- .75" [19.1 mm] side space
- Non-disconnect
- Lock-in/Lock-out actuated with latch at front of slide
- Compatible with optional platform brackets (see page 24)
- For locking on one side only, order non-locking companion slide Model 9301
- Available in even lengths
12"-36", 40", 42", 48", 60"
[305-914 mm, 1016 mm, 1066 mm, 1219 mm, 1524 mm]

Note: Special packaging is available which includes one standard 9301 and one right-hand 9308. Available lengths: 14"-32", 36", 40", 48", and 60". The part number for this packaging is 9308-5.



Super Heavy-Duty Slides

Lightweight aluminum combined with stainless steel ball bearings and ball retainers provides corrosion resistance and strength without the additional weight of steel slides.



AL4120

- 3/4 extension
- 1.42" [36 mm] side space
- Load rating up to 1,212 lbs. [550 kg]/pair

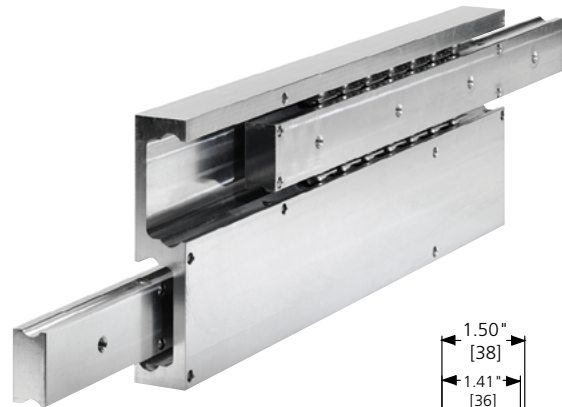
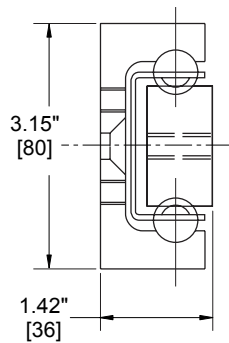

AL4140

- Full extension
- 1.5" [38 mm] side space
- Load rating up to 1,323 lbs. [600 kg]/pair

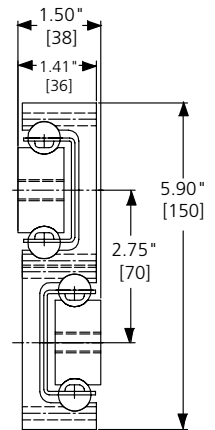

AL4140

Slide Length	Slide Travel
15.75 [400]	15.82 [402]
19.69 [500]	21.38 [543]
23.62 [600]	24.60 [625]
27.56 [700]	27.83 [707]
31.50 [800]	33.39 [848]
35.43 [900]	36.61 [930]
39.37 [1000]	39.84 [1012]
43.31 [1100]	30.83 [783]
47.24 [1200]	35.58 [853]

AL4120

Slide Length	Slide Travel
15.75 [400]	11.42 [290]
19.69 [500]	14.17 [360]
23.62 [600]	16.93 [430]
27.56 [700]	19.72 [501]
31.50 [800]	22.52 [572]
35.43 [900]	25.28 [642]
39.37 [1000]	28.07 [713]
43.31 [1100]	30.83 [783]
47.24 [1200]	35.58 [853]

Common Features

- Load rating based on a pair of slides spaced 24" [610 mm] apart and tested to 5,000 cycles.
- Non-disconnect
- Stainless steel ball bearings
- Lengths: 16", 20", 24", 28", 32", 36", 40", 44" and 48" [400 mm, 500 mm, 600 mm, 700 mm, 800 mm, 900 mm, 1000 mm, 1100 mm, 1200 mm]*

* The lengths indicated in inches are approximate conversions from the metric measurements. Please see the chart at left or the product technical sheet for exact dimensions.



Industrial Applications

Specialty Slide Products

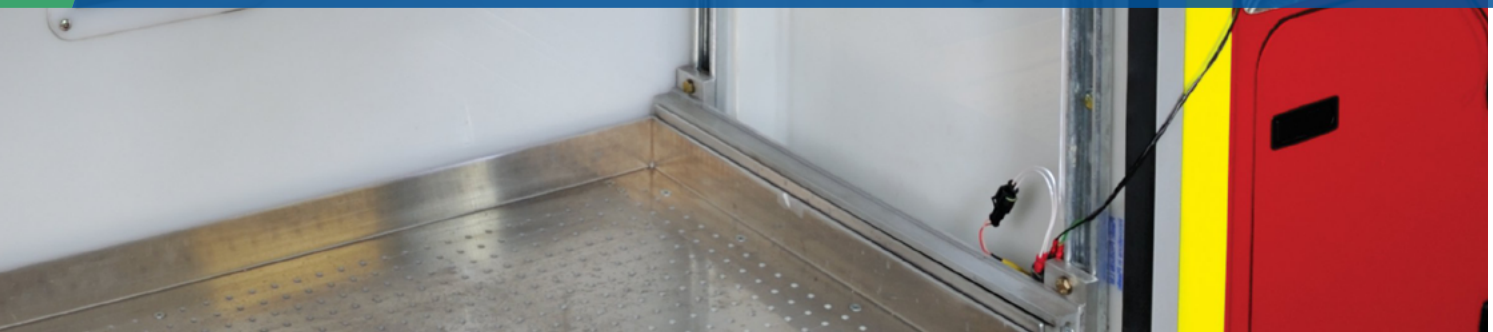

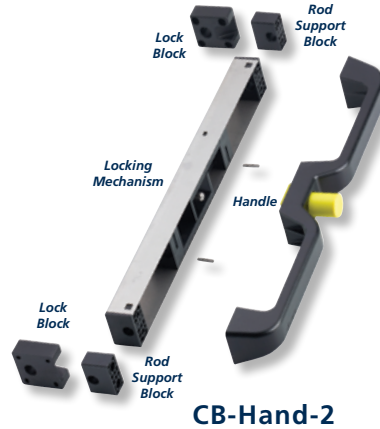

CB-Hand-2

CB-Hand Locking Handle Kit

Adds lock-in and lock-out features to heavy-duty drawers or trays. Suitable for installations where the locking feature provides a measure of safety.

- Compatible with slide cross sections .75" [17.5 mm] or greater.
- Accommodates drawers up to 60" [1.5 mm] wide.
- Activates with a centrally located push-button.
- Two locking options:
 - Front mounted unit – lock-in only (CBHand-2)
 - Rear mounted unit – lock-in and lock-out (CBHan4-5)
- Lightweight and corrosion resistant components

CB-Hand Optional Kits

- **CBHAN4-5**
Lock-out conversion kit
- **CBHAN3-0100-2**
2 ea. 19.7" [500 mm] Stainless Steel Rods
- **CBHAN3-0150-2**
2 ea. 29.5" [750 mm] Stainless Steel Rods

Note: See product technical sheet for details.

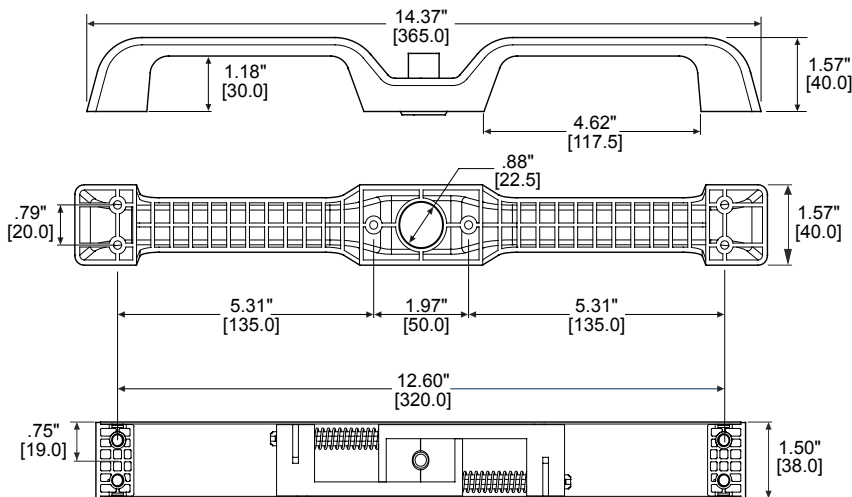

AL4190

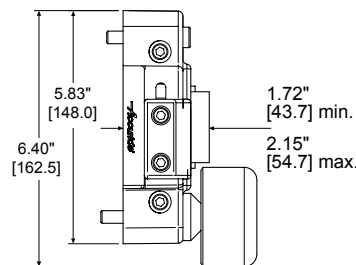

AL4190 Tilt Track System

A track system that extends and tilts drawers downward for easy viewing and access to contents. Use for supply and equipment storage in mobile applications and warehouse, manufacturing, or garage facilities.

- Extends and tilts downwards
- Drawers up to 40" wide
- Aluminum tracks in lengths of 24" and 40"
- Non-disconnect

Features

- Corrosion resistant
- Angle of tilts is preset by installer
- Track can be cut to length for custom fit
- Fully adjustable from the front and with the drawer in place
- Can be used with CBHand-2 Locking Handle Kit to add lock-in feature

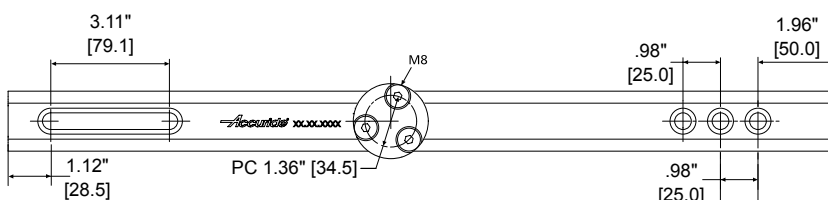



115RC

A simple motion solution comprised of aluminum tracks and re-circulating ball carriages. Use for movement and positioning of screens, panels, boards, or components used in medical apparatus.

Features

- Load rating up to 265 lbs. [120 kg]
- Load capacity based on track orientation and the type of ball carriages
- Corrosion-resistant components

Aluminum Track

- Available in two lengths: 47" [1.2 m] and 94" [2.4 m].
- Track may be cut down to the desired length or butted together to extend to greater lengths.
- Track may be side, flat, or vertically mounted.
- Flat-mounted track may be oriented with ball carriage facing up or down.
- Tracks have drilling marks for fixing holes and end stops.

Ball Carriages

- Re-circulating ball carriages in two options:
 - Stainless steel ball bearings
 - Polymer ball bearings
- Multiple carriages may be inserted into tracks. Carriages may be used separately to provide independent movement, combined as a unit, or both methods within one track.

Optional Kits

DZ0115-DJIGRC

Drill Jig (made to order)

CB0115-ECRC Easy-Close Kit

Dampening Mechanism



Load Ratings

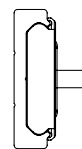

Side mount

SS0115-CASSRC Stainless Steel Ball Carriage	CB0115-CASSRC Polymer Ball Carriage
x1 110 lbs.	x1 65 lbs.
x2 200 lbs.	x2 120 lbs.
x3 265 lbs.	x3 160 lbs.

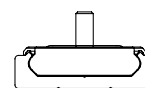

**Flat mount
(carriage up)**

SS0115-CASSRC Stainless Steel Ball Carriage	CB0115-CASSRC Polymer Ball Carriage
x1 65 lbs.	x1 40 lbs.
x2 120 lbs.	x2 70 lbs.
x3 155 lbs.	x3 90 lbs.

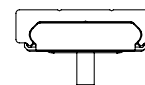

**Flat mount
(carriage down)**

SS0115-CASSRC Stainless Steel Ball Carriage	CB0115-CASSRC Polymer Ball Carriage
x1 90 lbs.	x1 50 lbs.
x2 155 lbs.	x2 90 lbs.
x3 200 lbs.	x3 120 lbs.

NOTE: Weight should be evenly distributed across the carriage(s).

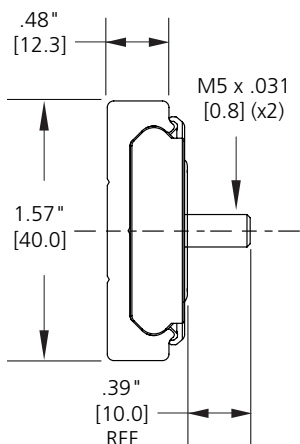

NOTE: Due to the extensive variety of applications and possible orientations for this product, we recommend that customers first test this product in the intended application. This product is not recommended for high-torque applications.



Ascent CBLift-0019

The Ascent is a push-to-operate mechanical lift that provides access and conceals screens in desks and other cabinetry when not in use.

- Accommodates screens from 5.5–14.5 pounds [2.5–6.6 kg], up to 17.5 inches tall, and 22 inches diagonally
- No power required; movement is controlled by counterbalancing weights
- Swivels $\pm 112.5^\circ$ for expanded viewing access
- Easy to install
- Unit raises 21 inches in less than 2 seconds
- Packaging includes wire management, cable control kit, and one weight pack
- Black electroplate finish

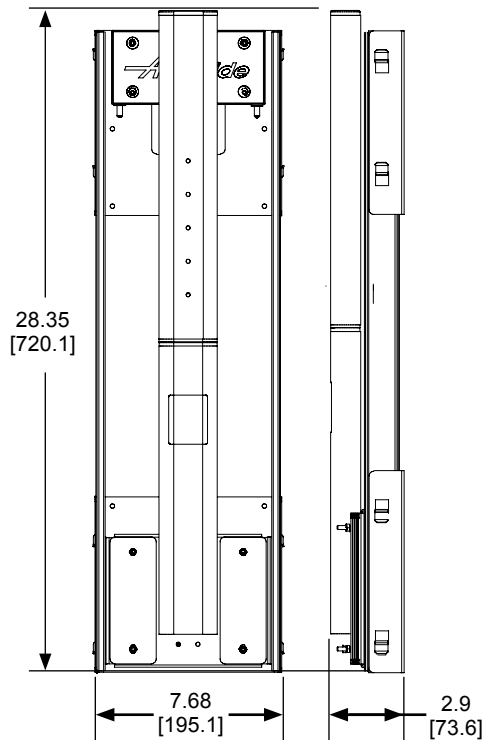

The slim and compact design makes the Ascent a multi-purpose solution for a wide range of applications in industrial, commercial, institutional, and manufacturing environments.

Optional
VESA
Fixed
Bracket

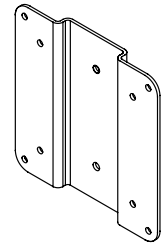

Optional
VESA
Tilt
Bracket

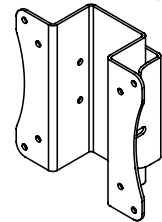

Optional Kits

Additional Weight Pack
(3.88 oz. [10X] plates)
P/N 2990-9774-BE

Weight Extension Plate Kit
P/N 2990-9775-BE

VESA Tilt Bracket
P/N 2990-9776-BE

VESA Fixed Bracket
P/N 2990-9777-BE

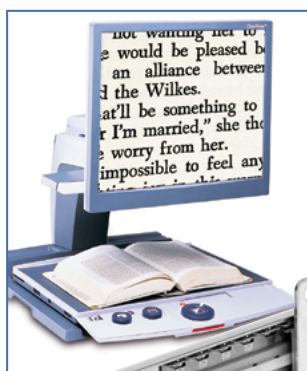

115

Model 115 is a linear motion ball bearing slide designed for component guidance, support, or adjustment in applications from manufacturing machinery to utility vehicles to diagnostic equipment.

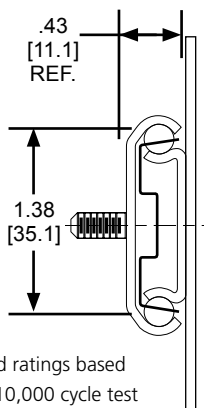
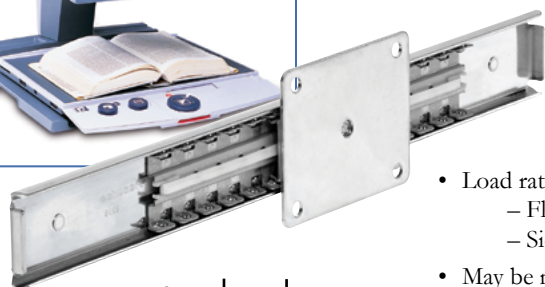

* Load ratings based on 10,000 cycle test

- Load ratings:
 - Flat mount – up to 132 lbs. [60 kg]/pair
 - Side mount – up to 110 lbs. [50 kg]/pair
- May be mounted vertically as a non-load bearing guide
- .43" [11 mm] width, 1.38" [35.1 mm] height
- Non-disconnect
- Provides captive motion within the length of the outer member
- A guide belt synchronizes the moving elements of the slide for smooth and consistent travel
- Moving member is fully supported on ball bearings
- Lengths: 12"–28" in 2" increments, plus 32", 36", and 40" [305–711 mm, 813 mm, 914 mm, 1016 mm]

Slide Length	Slide Travel	Load Rating Lbs./Pr. Flat	Load Rating Lbs./Pr. Side
12.00 [305]	8.90 [226]	132 [60]	110 [50]
14.00 [356]	10.87 [276]	132 [60]	110 [50]
16.00 [406]	12.87 [327]	132 [60]	110 [50]
18.00 [457]	14.88 [378]	132 [60]	110 [50]
20.00 [508]	16.89 [429]	132 [60]	110 [50]
22.00 [559]	18.90 [480]	132 [60]	110 [50]
24.00 [610]	20.87 [530]	132 [60]	110 [50]
26.00 [660]	22.87 [581]	132 [60]	110 [50]
28.00 [711]	24.88 [632]	132 [60]	110 [50]
32.00 [813]	28.90 [734]	132 [60]	110 [50]
36.00 [914]	32.87 [835]	132 [60]	110 [50]
40.00 [1016]	36.79 [937]	132 [60]	110 [50]



SS2028

Stainless steel for corrosion resistance in applications such as food or chemical storage.

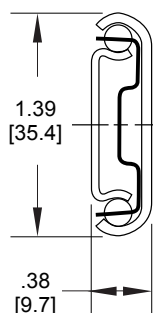

- Load capacity up to 100 lbs. [45 kg]/pair*
- 3/4 extension
- Corrosion resistant
- Hold-in detent
- .38" [9.5 mm] side space
- Non-disconnect
- Even lengths 12"–28" [300–700 mm]**
- Food-safe grease available by special order

Slide Length	Slide Travel
11.81 [300]	8.23 [209]
13.78 [350]	9.64 [245]
15.75 [400]	11.10 [282]
17.72 [450]	12.60 [320]
19.69 [500]	14.06 [357]
21.65 [550]	15.51 [394]
23.62 [600]	17.00 [432]
25.59 [650]	18.46 [469]
27.56 [700]	19.92 [506]

* Load rating based on 18" slides in an 18" wide drawer cycled 80,000 times

** The lengths indicated in inches are approximate conversions from the metric measurements. Please see the chart above or the product technical sheet for exact dimensions.

Slide Length	Slide Travel	Load Rating Lbs./Pr.
11.81 [300]	11.98 [304.5]	110 [50]
13.77 [350]	13.93 [354]	121 [55]
15.74 [400]	15.86 [403]	121 [55]
17.71 [450]	17.79 [452]	143 [65]
19.68 [500]	19.72 [501]	121 [55]
21.65 [550]	22.67 [550.5]	110 [50]
23.62 [600]	23.62 [600]	99 [45]
27.55 [700]	27.48 [698]	77 [35]



SS0330

Stainless steel and full extension for applications subject to moisture or humidity.

Stainless Steel

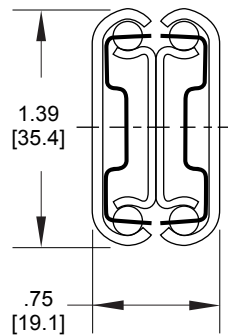

- Load capacity up to 143 lbs. [65 kg]/pair*
- Full extension
- Corrosion resistant
- Hold-in detent
- .75" [19.1mm] side space
- Non-disconnect
- Available in even lengths 12"–24" [300–600 mm], plus 28" [700 mm]**
- Food-safe grease available by special order

Slide Length	Slide Travel	Load Rating Lbs./Pr.
11.81 [300]	12.74 [323.5]	264 [120]
13.78 [350]	14.70 [373.5]	286 [130]
15.75 [400]	16.67 [423.5]	308 [140]
17.72 [450]	18.64 [473.5]	330 [150]
19.68 [500]	20.61 [523.5]	352 [160]
21.65 [550]	22.58 [573.5]	330 [150]
23.62 [600]	24.55 [623.5]	286 [130]
27.56 [700]	28.48 [723.5]	242 [110]
31.10 [790]	31.63 [803.5]	220 [100]



SS5321

Stainless steel offers corrosion resistance for applications exposed to moisture such as marine or industrial storage.

Stainless Steel

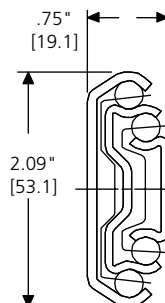

- Load capacity up to 352 lbs. [160 kg]/pair*
- 1" [25.4 mm] over travel
- Corrosion resistant
- Hold-in detent
- .75" [19.1mm] side space
- Non-disconnect
- Available in even lengths 12"–24", 28", 31" [300–600, 700, 790 mm]**
- Food-safe grease available by special order

* Load rating based on 18" slides in an 18" wide drawer cycled 80,000 times

** The lengths indicated in inches are approximate conversions from the metric measurements. Please see the chart above or the product technical sheet for exact dimensions.

20 Series Slides

The 20 Series is a

complete family of slides with common mounting characteristics designed specifically for use in metal applications.

Originally developed for metal office furniture; applications have expanded to include medical carts, modular and built-in toolboxes for utility or emergency vehicles and more.

Quick and Easy Installation

These products have a standardized bayonet/pocket installation system that simplifies and speeds up slide integration. Installers simply snap the slides into position, without the need for screws, washers, or lock nuts. The slide is secured in position with locking tabs or barbs.

Manufacturers have discovered that by setting up their cases or cabinets to the pitch and gap of the 20 Series slides, they can significantly reduce labor and material costs.

Ordering and Availability

All 20 Series slides are handed and have features which require a pair of slides, one left hand and one right hand slide, per drawer. All models are ordered as pairs. The drawings in this section are left hand slides.

If a modification to this system is required to fit your specific application, please contact your Accuride representative for design assistance.

Minimum order quantities, tooling charges, and manufacturing leadtimes apply.



Industrial Applications 20 Series Slides Pocket & Bayonet

Pocket

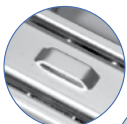

Bayonet

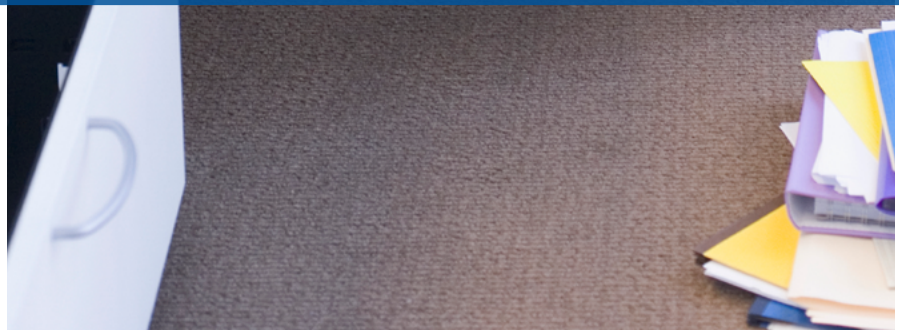

How the 20 Series Slides Work

To accommodate the pocket and bayonet mounting style, the cabinet or case is set up with vertical columns or “hat” sections that have cutouts to carry the bayonets located on the slide’s outer member. The drawers, trays, or shelves are set up with bayonets and locking tabs; the bayonets fit into the pockets on the slide’s inner member and the locking tabs secure the slide.

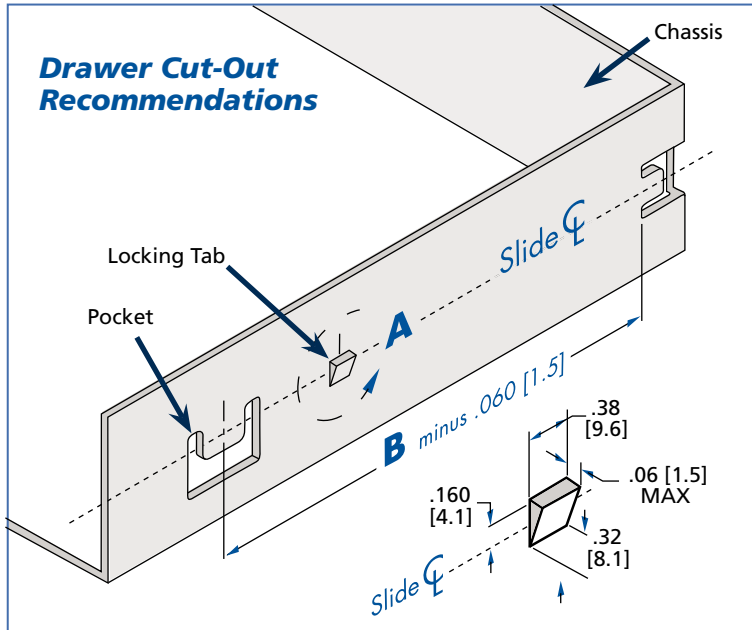

Material Modifications*

Gauge	Material Thickness	Dim. "D"	Dim. "E"
16	.060 [1.52]	.855 [21.7]	.395 [10.0]
18	.048 [1.22]	.865 [22.0]	.405 [10.3]
20	.036 [.91]	.885 [22.5]	.425 [10.8]
22	.030 [.76]	.905 [23.0]	.435 [11.1]

For dimension "B", see tabulated tables for each slide model.

Cut-out recommendations are based on 16-gauge material thickness. If a thinner material is used, adjustments to the cut-outs must be made to ensure a proper fit. Refer to the Material Modifications table above right for the required modifications for 16- to 22-gauge material.*

Terminology

Bayonet = tab, lance, or open tab

Pocket = closed tab, closed pocket, bayonet pocket

Locking tabs = locking barbs, eyebrow tabs, self-locking tabs

Hat sections = Columns, vertical sections, uprights, struts

Drawer Cut-Outs* Detailed Dimensions

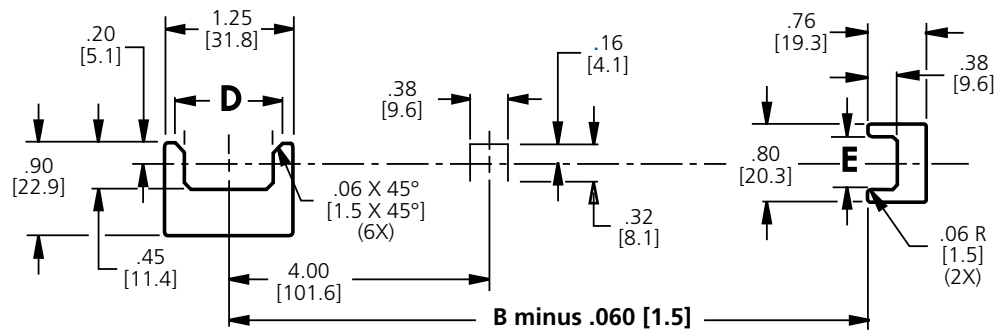

* These dimensions do not apply to models 9328/9322. See the 9328/9322 technical sheet for exact dimensions.

Typical Cabinet Hat Section

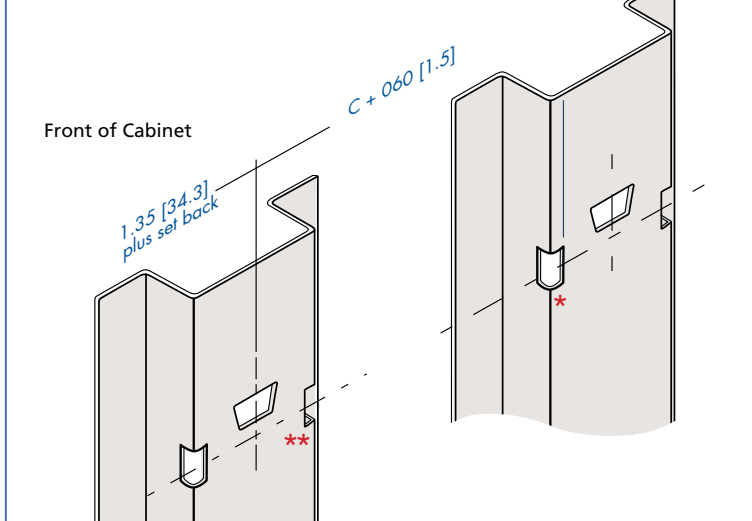

Cabinet Cut-Out Recommendations

The front and rear hat sections shown here are identical. Hat sections are required for all 20 Series slide installations.

The vertical cut-out at the front of the rear hat section* accepts the rear cabinet member tab of all 20 Series models.

The vertical cut-out at the back of the front hat section accepts the anti-lift tab on Model 2120.**

Setback = Thickness of inset drawer front where applicable + .12" [3.1 mm] clearance.

For dimension "C" dimension, see tabulated tables on the product technical sheets.

Alternate Configurations

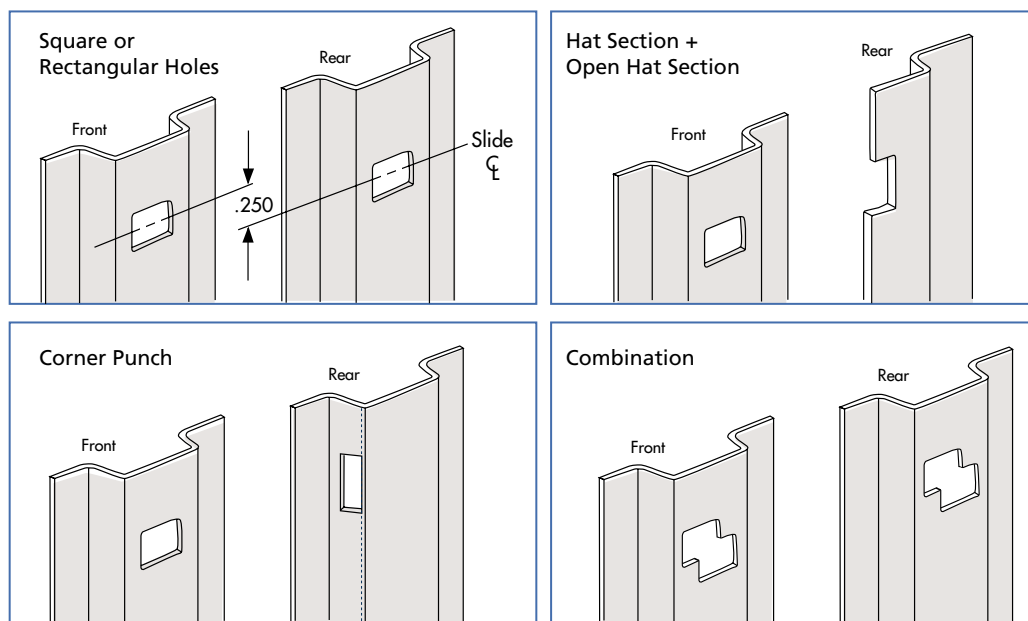

Alternate Cut-Out Shapes

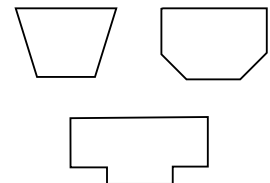

In addition to the trapezoidal punch shown in the diagram at the top of the page, a standard rectangle punch will work as well. The trapezoid is the optimum shape to provide faster installation and tolerance control when inserting the lance into the cut-out, but several other punch sizes and shapes may be used.

Cabinet Cut-Outs Detailed Dimensions*

* These dimensions do not apply to models 9328/9322. See the 9328/9322 technical sheet for exact dimensions.

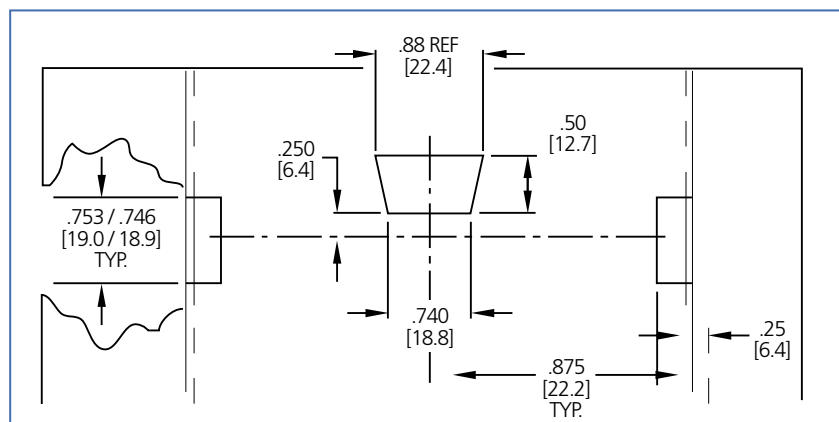

Cabinet

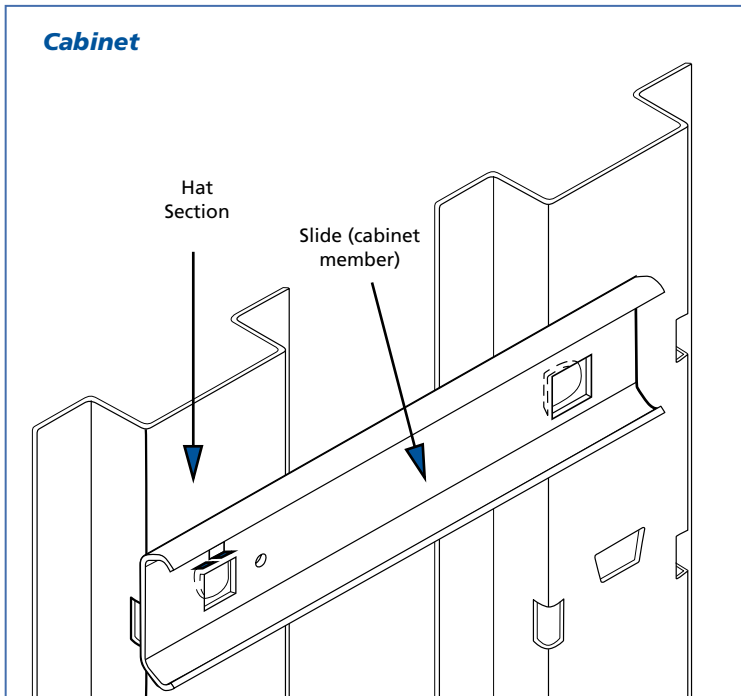

Slide Installation

- Place the rear cabinet member tab into rear hat section slot and slide back.
- Press down on slide until cabinet member tab fully engages front hat section slot. The retention lug above the tab should lock against the top edge of the cut-out.
- On Model 2120, the anti-lift tab will snap into the rear vertical cut-out.
- Extend slides.
- Place the rear drawer tab into the rear drawer member slot and slide back.
- Lower the front of the drawer until the drawer tab fully engages the slide pocket and snaps into place.

Slide Removal

- For Models 3320, 3620, and 3820, remove drawer reversing the installation procedure. Twist cabinet member to disengage anti-lift feature.
- For Model 2120, remove drawer, then using a finger or screwdriver, depress the cabinet member anti-lift tab inward.
- Lift slide to remove.

Drawer or Chassis

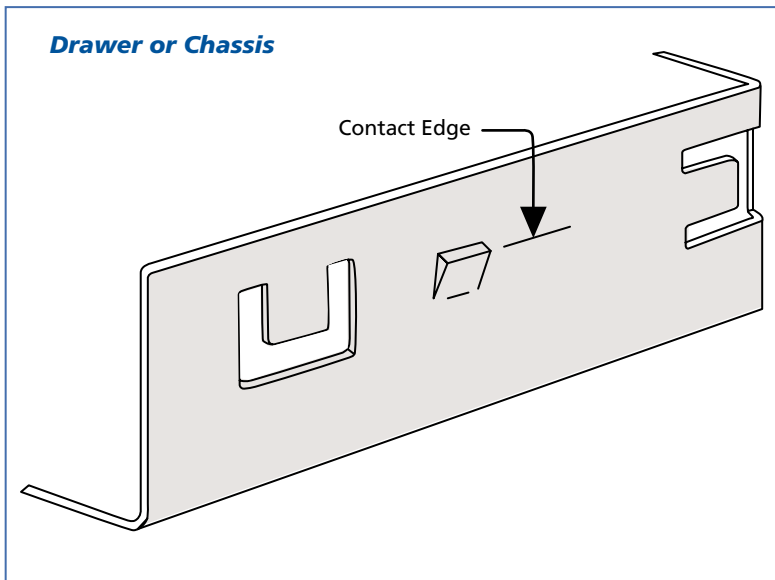

Slide (Drawer Member)

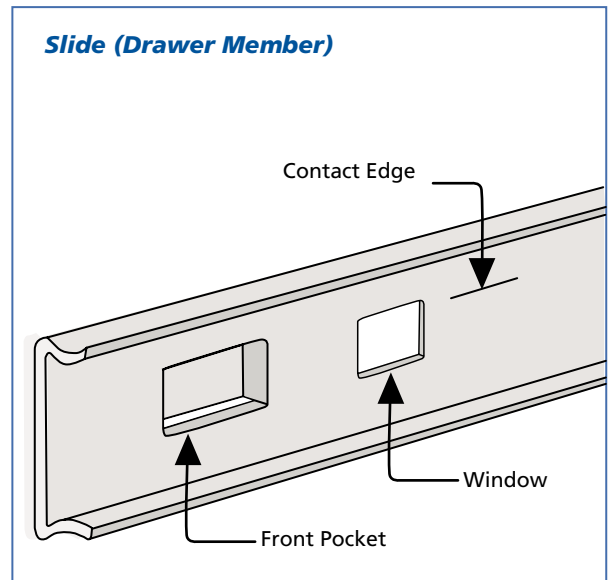



2120

For light applications calling for 3/4 extension and a disconnect such as small metal pods for office supply storage.

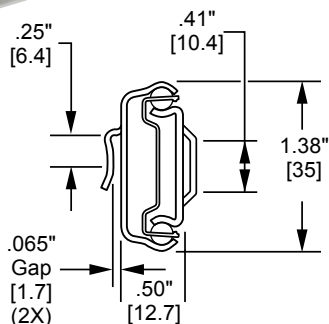

- 3/4 extension
- .50" [12.7 mm] side space*
- 75-lb. [34 kg] load rating/pair based on 18" [450 mm] slide length
- Drawer widths up to 16"
- Hold-in detent
- Lever disconnect
- Even lengths 12"–28" [305–700 mm]

Slide Length Slide Travel

12.00 [305]	8.45 [215]
13.78 [350]	9.73 [247]
15.75 [400]	11.81 [300]
17.72 [450]	13.29 [338]
19.69 [500]	14.79 [376]
21.65 [550]	16.34 [415]
23.62 [600]	17.74 [451]
25.59 [650]	18.73 [476]
27.56 [700]	19.73 [501]

* Provide + .030/- .000 [+ .76 mm/.00 mm] tolerance in cabinet design



3820

Full extension and a disconnect method for light to medium duty applications.

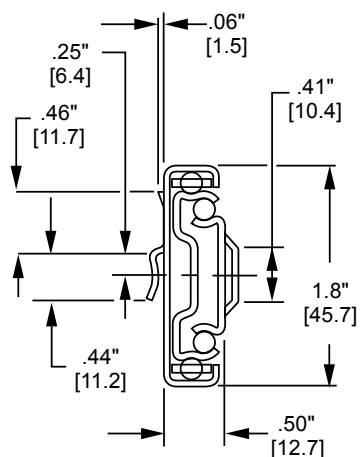

- Full extension
- .50" [12.7 mm] side space*
- 100-lb. [45 kg] load rating/pair based on 18" [450 mm] slide length
- Drawer widths up to 16"
- Hold-in detent
- Lever disconnect
- Even lengths 12"–28" [305–700 mm]

Slide Length Slide Travel

12.00 [305]	12.00 [305]
13.78 [350]	14.00 [356]
15.75 [400]	16.00 [406]
17.72 [450]	18.00 [457]
19.69 [500]	20.00 [508]
21.65 [550]	22.00 [559]
23.62 [600]	24.00 [610]
25.59 [650]	26.00 [660]
27.56 [700]	28.00 [711]

* Provide + .030/- .000 [+ .76 mm/.00 mm] tolerance in cabinet design

Slide Length	Slide Travel
12.00	12.00
[305]	[305]
14.00	14.00
[356]	[356]
16.00	16.00
[406]	[406]
18.00	18.00
[457]	[457]
20.00	20.00
[508]	[508]
22.00	22.00
[559]	[559]
24.00	24.00
[610]	[610]
26.00	26.00
[660]	[660]
28.00	28.00
[711]	[711]

* Provide + .030/- .000 [+ .76 mm/.00 mm] tolerance in cabinet design

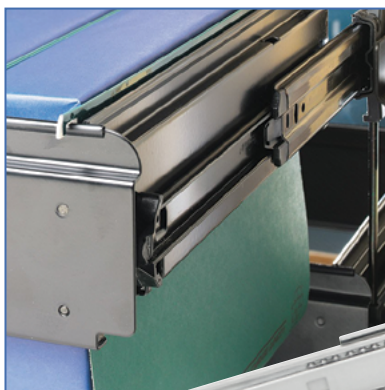

3320

Non disconnect to add strength and prevent drawer removal in medium duty applications.

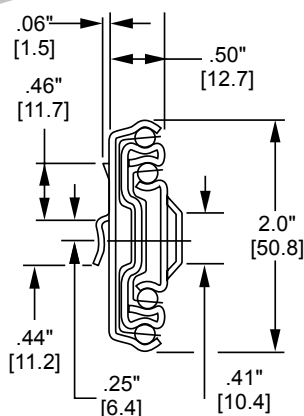

- Full extension
- .50" [12.7 mm] side space*
- 120-lb. [55 kg] load rating/pair based on 18" [450 mm] slide length
- Drawer widths up to 24"
- Hold-in detent
- Non disconnect
- Silencing open and closed
- Even lengths 12"–28" [305–711 mm]

Slide Length	Slide Travel
14.00	15.00
[356]	[381]
16.00	17.00
[406]	[432]
17.00	18.00
[432]	[457]
18.00	19.00
[457]	[483]
20.00	21.00
[508]	[533]
21.00	22.00
[533]	[559]
22.00	23.00
[559]	[584]
24.00	25.00
[610]	[635]
26.00	27.00
[660]	[686]
28.00	29.00
[711]	[737]

* Provide + .030/- .000 [+ .76 mm/.00 mm] tolerance in cabinet design



3620

Suitable for wider drawers; over travel provides complete access to drawer contents.

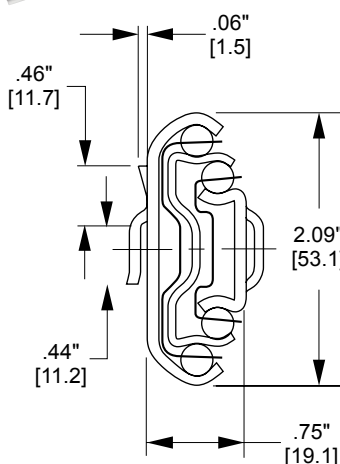
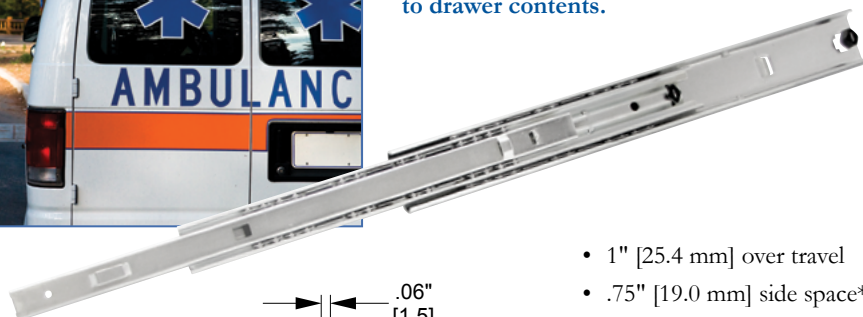

- 1" [25.4 mm] over travel
- .75" [19.0 mm] side space*
- 200-lb. [91 kg] load rating/pair based on 18" [457 mm] slide length
- Drawer widths up to 42"
- Sequential action
- Hold-in detent
- Non disconnect
- Silencing open and closed
- Lengths: 14", 16", 17", 18", 20", 21", 22", 24", 26", 28" [356, 406, 432, 457, 508, 533, 559, 610, 660, 711 mm]



9328

A heavy-duty load rating with lock-in and lock-out to keep drawers securely in place during access or transit.

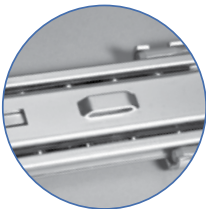

Model 9328
Bayonet Detail



Model 9328

Slide Length Slide Travel

10.00	10.00
[254]	[254]
12.00	12.00
[305]	[305]
14.00	14.00
[356]	[356]
16.00	16.00
[406]	[406]
18.00	18.00
[457]	[457]
20.00	20.00
[376]	[376]
22.00	22.00
[559]	[559]
24.00	24.00
[610]	[610]
26.00	26.00
[660]	[660]
28.00	28.00
[711]	[711]
30.00	30.00
[762]	[762]
32.00	32.00
[813]	[813]
34.00	34.00
[864]	[864]
36.00	36.00
[914]	[914]
40.00	40.00
[1016]	[1016]
42.00	42.00
[1067]	[1067]
48.00	48.00
[1219]	[1219]
60.00	60.00
[1524]	[1524]

9322

Non-locking companion slide.



Model 9322

- Load capacity up to 300 lbs. [136 kg]/pair
- Full extension
- .75" [19.1 mm] side space
- Lock-in/Lock-out actuated with latch at the front of the slide
- For locking on one side only, order non-locking companion slide Model 9322
- Non-disconnect
- Available in even lengths 10"–36", 40", 42", 48", 60" [254–914 mm, 1016, 1067, 1219, 1524 mm]

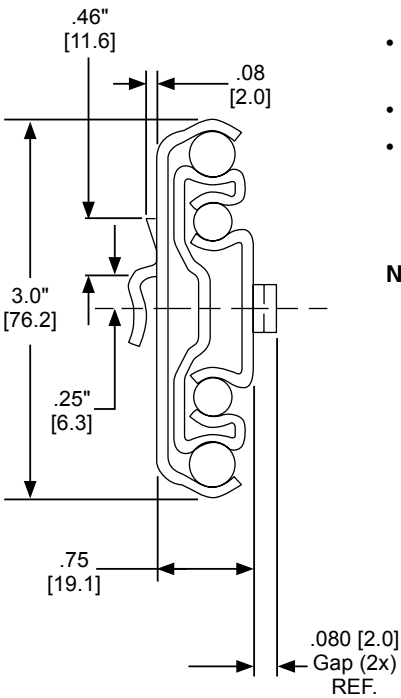

Note: The drawer and cabinet hat section cut-out specifications are unique to these models. Please see the technical sheet for detailed dimensions.

LIMITED LIFETIME WARRANTY

Accuride International Inc. warrants its Accuride-branded drawer slides against defects in material and workmanship.*

This warranty does not cover drawer slides which have been damaged due to abuse, improper installation, excessive loads, or any use contrary to the instructions accompanying the product. Accuride will send the purchaser a replacement of the same model or a comparable model at no cost. This warranty is for replacement only and does not cover the cost of removal, installation, or incidental charges.

To obtain a replacement slide under this warranty, contact Accuride Technical Support within 30 days of the discovery of the defect. Please let us know how the product was used and the type of defect or malfunction experienced. Contact us by e-mail or phone at:

Technical@accuride.com
or 562-903-0200, ext. 1436

The foregoing express limited warranty is in lieu of all other express warranties and excludes incidental or consequential damages. This warranty does not apply to products sold and used outside of the United States and Canada.

All warranties implied by state law, including implied warranties of merchantability and fitness for a particular purpose, are expressly limited. Some states do not allow limitations on how long an implied warranty lasts or exclusion of incidental or consequential damages, so the foregoing limitation or exclusion may not apply to you. This Limited Lifetime Warranty gives you specific legal rights, and you may have other rights which vary from state to state.

* This warranty does not apply to the cylinder for the Easy-Down® Flipper Door Slide®, CBERGO-TRAY Keyboard Systems, or any other Accuride product for which the expressed warranty differs from the Limited Lifetime Warranty offered above. Call Accuride Technical Support for further information.

Accuride®
Always Moving Forward

ACCURIDE INTERNATIONAL INC. NORTH AMERICA

International Headquarters
12311 Shoemaker Avenue
Santa Fe Springs, California 90670

562 903-0200 Telephone
562 903-0208 Fax
www accuride.com

Calle Circuito Norte No. 6
Parque Industrial Nelson
Mexicali, B.C., C.P. 21395 Mexico



EUROPE

Liliput Road
Brackmills Industrial Estate
Northampton, NN4 7AS
United Kingdom
(441) 604-761111 Telephone
(441) 604-767190 Fax
www accuride-europe.com

Postfach 1464
Werner - Von Siemens - Strasse 16-18
65582 Diez/Lahn
Germany
(49 64 32) 6 08-0 Telephone
(49 64 32) 6 08-20 Fax
www accuride-europe.com



ASIA

Accuride Japan Co., Ltd.
44 Minami-asaji Iwata Yawata-shi
Kyoto, Japan
81-75-983-7500 Telephone
81-75-983-9500 Fax
www accuride.co.jp

Accuride International Suzhou Co. LTD
No. 178, Suhong East Road
Suzhou Industrial Park
Jiangsu Province, China 215026
86-512-62731200 Telephone
86-512-62833993 Fax
www accuride.com.cn



DISTRIBUTED BY:

Accuride®
Always Moving Forward

Stay connected:



Accuride printed materials are;
Printed with soy based inks. Printed on paper that
contains recycled materials and conforms to the
latest sustainable arboriculture guidelines.