



AVENTOS HK top
Lift Systems Reimagined

blum.com

 **blum**[®]



Reimagined for Easy Installation

An eye for detail and another on the big picture – that's what's needed to develop a lift system that is not only compact in design but also impresses with easy installation. That is what makes AVENTOS HK top the perfect solution for cabinetry where every detail counts.

 **blum**

A modern kitchen cabinet featuring a black AVENTOS HK top. The top is shown in an open position, revealing a glassware storage area. Several clear glass tumblers are visible, some resting on the top and others hanging from the underside. The cabinet's interior is white, and the bottom section has a light wood grain finish.

Contents

AVENTOS HK top

- 5** Solutions for All Applications
- 6** Specifications for Frameless & Face Frame
- 10** Specifications for Narrow Aluminum
- 14** Ordering Information for TIP-ON
- 16** Assembly
- 17** Adjustments
- 18** Face Frame Mounting Brackets
- 19** Assembly Aids
- 20** SERVO-DRIVE for HK top
- 36** Part Number Index



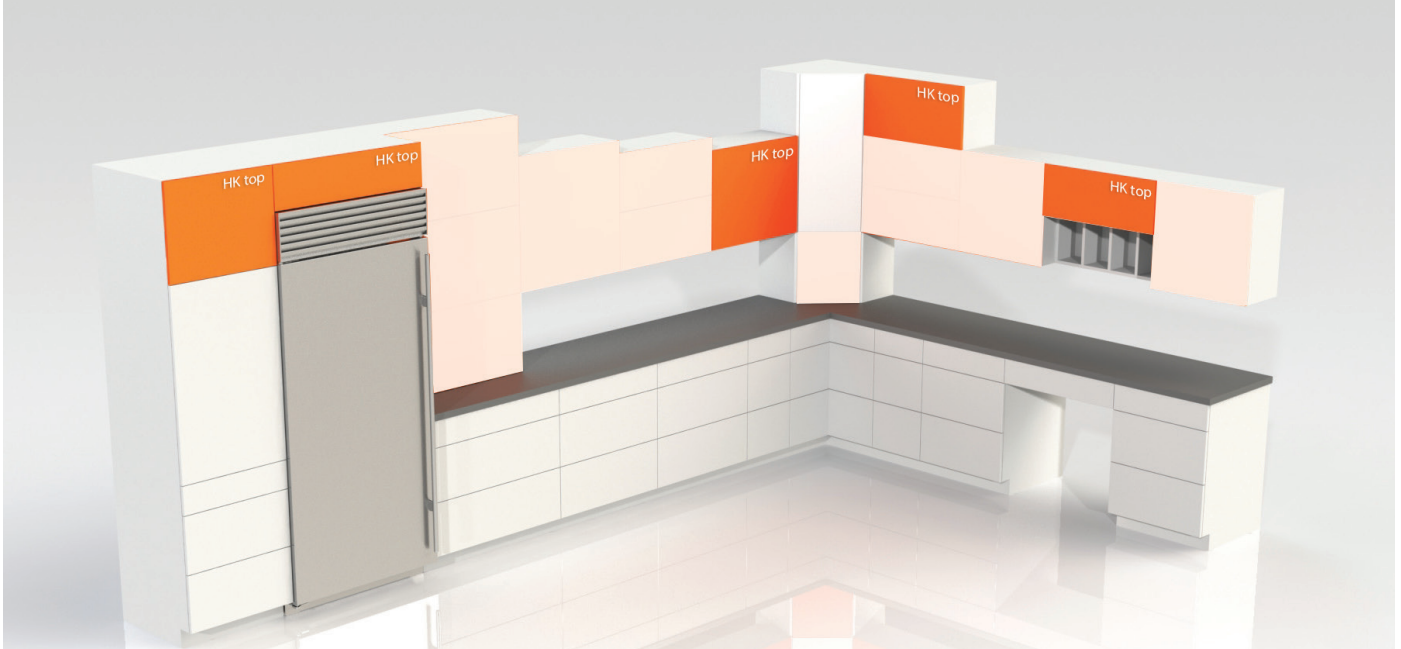

There are many good reasons why AVENTOS lift systems are an excellent choice for wall cabinets.

Since the cabinet doors open upwards, AVENTOS provides an excellent view into the cabinet interior enabling comfortable and ergonomic access to storage items.

The AVENTOS program opens up a whole new world of design possibilities for kitchen and office spaces. Even the widest and heaviest doors can be accommodated. Wide base cabinet designs can now be mirrored in the wall cabinets above to create a more uniform look.



Online Resource for Planning

Easy Planning

Blum offers many online tools to help you with your kitchen planning and ordering. Online Product Configurator (OPC) offers a parts list and planning information based on your specifications. Once complete, your results can then be exported to a shareable document.

OPC is easily accessible on our website at blum.com/configurator

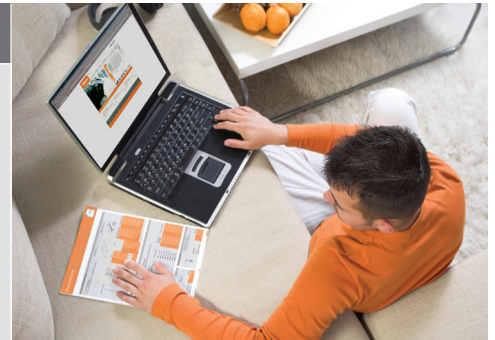

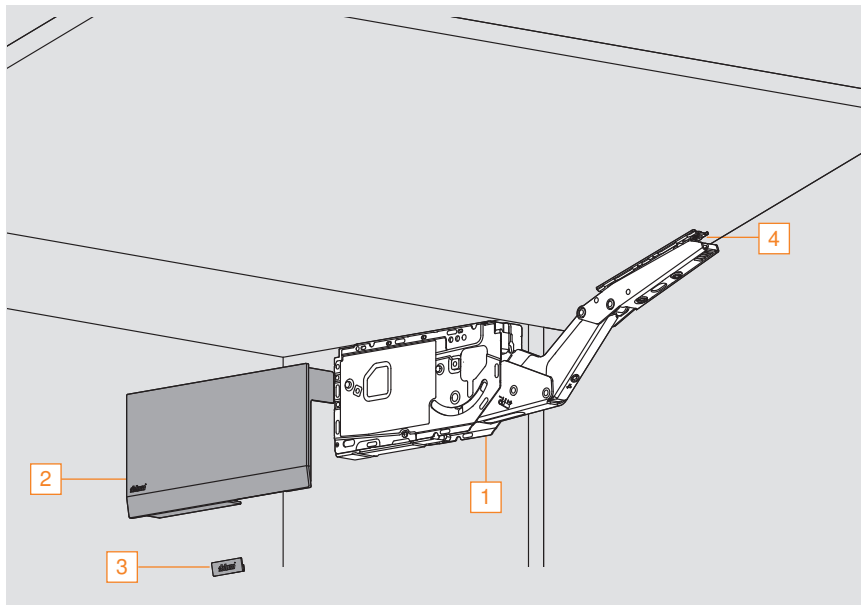

- Self-positioning mechanism with locating template eliminates complicated installation
- Integrated opening angle adjustment between 75° and 107°
- Cabinet height from **250** (10") to **610** (24")
- Cabinet width range **381** (15") to **1828** (72")
- Interior cabinet depth minimum of **187** (7-3/8")
- Optional: TIP-ON for AVENTOS
- If using a third lift mechanism for wider applications (power factor increases by up to 50%), we recommend a trial application.

NOTE: For wide cabinets, we recommend an additional lift mechanism be attached to the center panel to prevent the middle of the front from sagging when open.



Warning: Risk of injury by spring-loaded lever arm!

- Arm has built in safety feature to prevent opening and closing
- Secure lever arm before installing cabinet

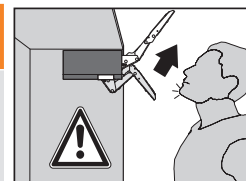

Step 1 – Determine the Power Factor for the Application



Power factor = cabinet height (inch) x door weight* (lb)

Determine power factor

To select the correct lift mechanism for a given application, the power factor must first be calculated by using the formula below. Use the table at the bottom of the page to convert ounces into decimal form for easy calculation.

Power factor = cabinet height multiplied by door weight*

Example:

Cabinet height: 20" (within possible range)

Door weight including twice the handle weight = 13 lb 14 oz (14 oz = .9 lb see chart below)

Power factor = 20 x 13.9

Power factor = 278

A power factor of 278 requires lift mechanism 22K2700

*Including twice the handle weight

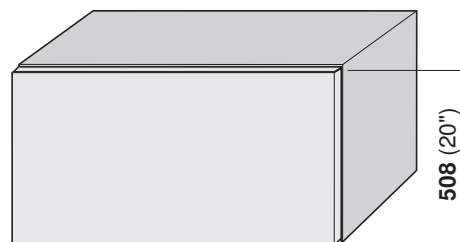

Door weight + twice handle weight = **13 lb 14 oz**

NOTE: AVENTOS planning tools available at blum.com/planning

Weight conversion chart

oz	1	2	3	4	5	6	7	8	9	10	11	12	13	14	15
lb	.1	.1	.2	.3	.3	.4	.4	.5	.6	.6	.7	.8	.8	.9	.9

AVENTOS HK top Ordering Information

AVENTOS

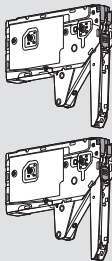
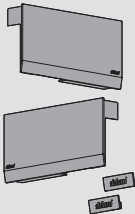
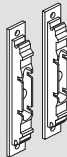
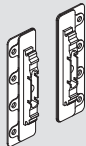
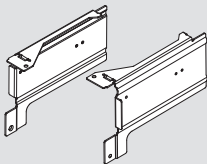

Step 2 – Select the Required Components

Lift mechanism sets				
	Set includes: <div><div>1</div> Lift mechanism (qty 2)</div> <div><div>■</div> #7 x 35 (1-3/8") wood screw (qty 8)</div>	NOTE: Symmetrical with wood screws including positioning template. Max front weight 39 lb for two lift mechanisms.		
		Power factor range	Opening angle	Part no.
		36 – 139	107°	22K2300
		80 – 240	107°	22K2500
		150 – 450	107°	22K2700
270 – 781	107°	22K2900		
Cover set				
	Set includes: <div><div>2</div> Right and left cover plate</div> <div><div>3</div> Non-handed cover cap (qty 2)</div>	NOTE: Light and Dark Gray options available		
		<div><div></div> Light Gray (HGIG)</div> <div><div></div> Dark Gray (TGIG)</div>	Part no.	
		Cover set	22K8000.NA	
Wood or wide aluminum door hardware set				
	Set includes: <div><div>4</div> Arm assembly mounting plate (qty 2)</div>	Part no.		
		Wood or wide aluminum hardware set	20S4200	
		Installation screw for wood doors	606N or 606P	
		Installation screw for wide aluminum doors	7072A	
Mounting plate with bracket set				
	Set includes: <div><div>■</div> Mounting plate with bracket (qty 2)</div>	For use with large overlay five-piece doors		
		Part no.		
		Mounting plate with bracket set	20S4F01	
Face frame mounting bracket set				
	Set includes: <div><div>■</div> Right and left brackets</div> <div><div>■</div> M4 X 30 lift mounting screws</div>	NOTE: See page 18 for more information		
		Part no.		
		HK top frame mounting bracket set	22K6001	

Frameless Application

Door and hardware clearance

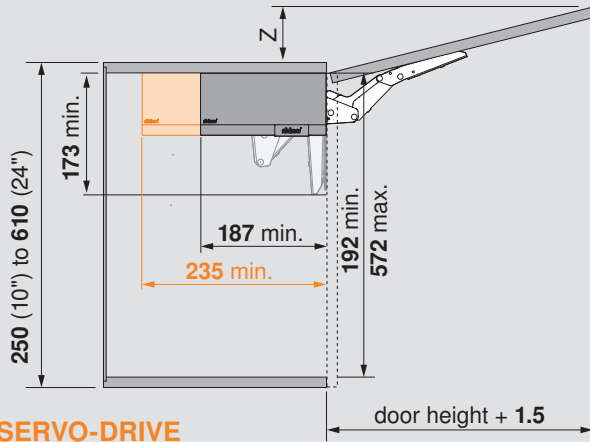

SERVO-DRIVE

NOTE: $Z = \text{door height} \times 0.29 + \text{door thickness} - \text{top panel thickness}$

Face Frame Application

Door and hardware clearance

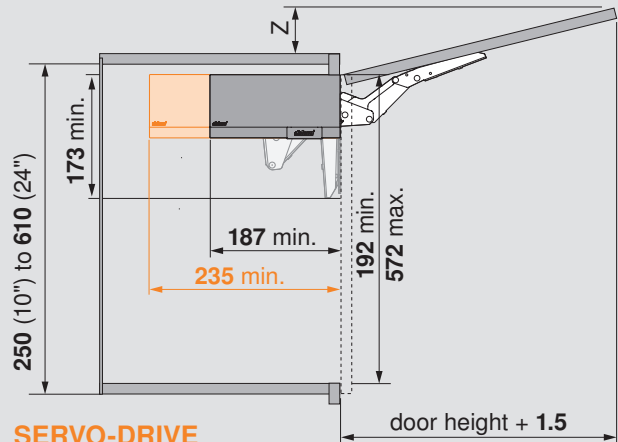

SERVO-DRIVE

NOTE: $Z = \text{door height} \times 0.29 + \text{door thickness} - \text{top frame width}$

Lift mechanism clearance

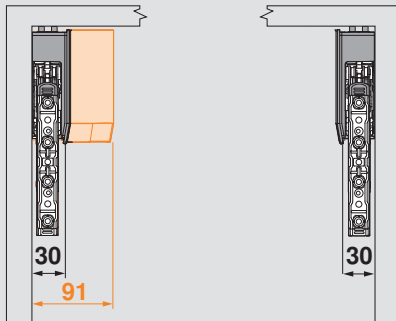

SERVO-DRIVE

Lift mechanism positioning

Attachment for lift mechanism for wood screws including positioning template.

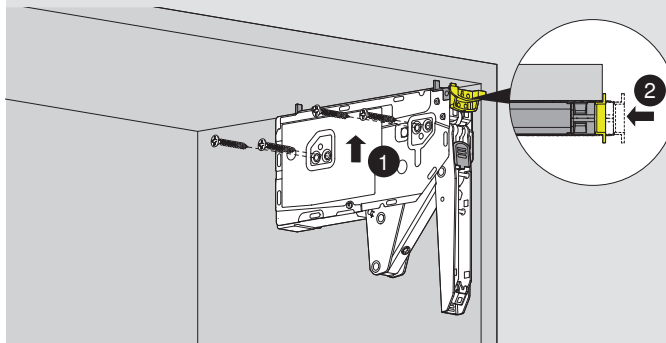

Door and Hardware Clearance

Minimum gap

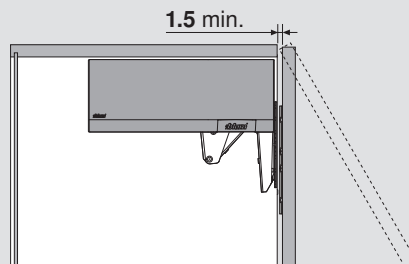

NOTE: Min gap assumes door radius of 1

Overlay	up to 25.4
gap	1.5

Decorative molding clearance

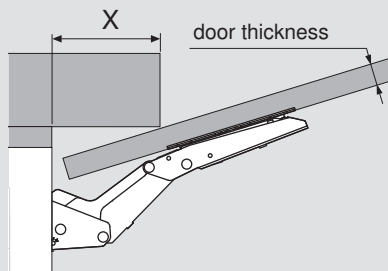

Door thickness	16	19	22	26
maximum X	68	57	47	33

Minimum bottom reveal

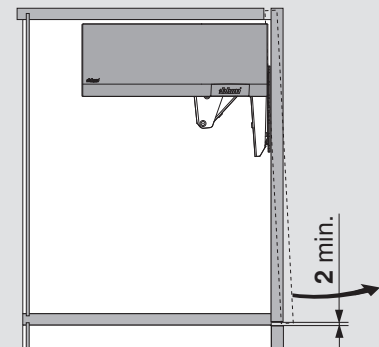



Arm assembly mounting plate location

Frameless and face frame applications

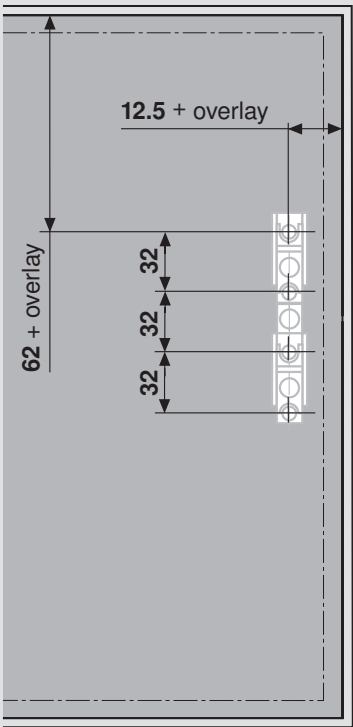

NOTE: Attach mounting plate with four 606N or 606P wood screw for wood doors or 7072A for wide aluminum doors

Arm assembly mounting plate choices

Mounting plate

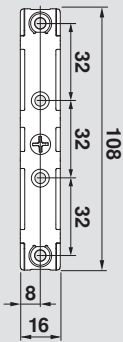

Slab door

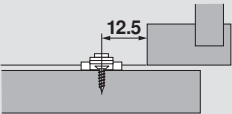

Five-piece door

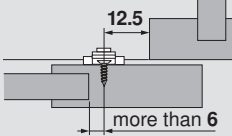

Mounting plate with bracket for large overlay five-piece doors

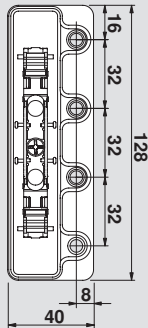

Five-piece door

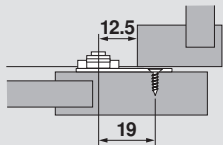

NOTE: Hole locations offset by 19 (example: 12.5 + overlay - 19 = hole location from side)

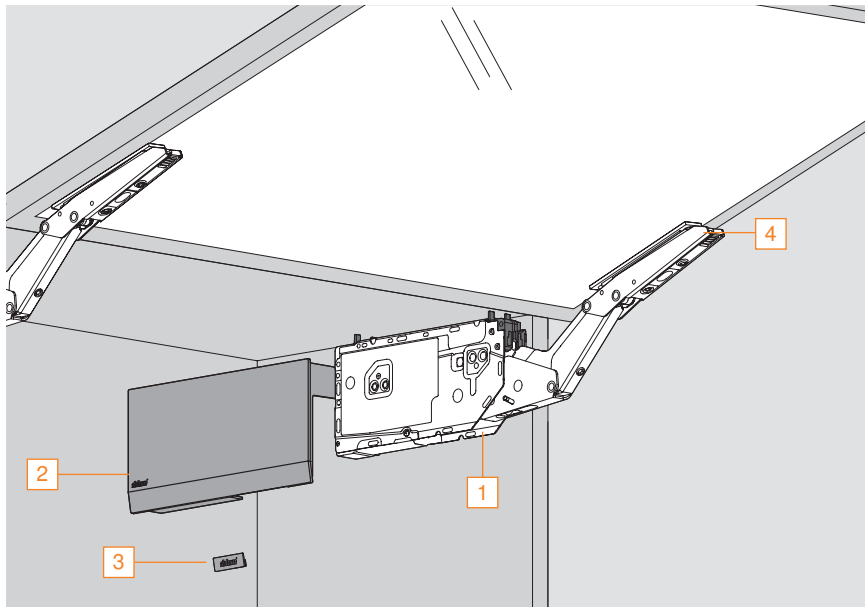

- Self-positioning mechanism with locating template eliminates complicated installation
- Integrated opening angle adjustment between 75° and 107°
- Cabinet height from **250** (10") to **610** (24")
- Cabinet width range **381** (15") to **1828** (72")
- Interior cabinet depth minimum of **187** (7-3/8")
- Optional: TIP-ON for AVENTOS
- If using a third lift mechanism for wider applications (power factor increases by up to 50%), we recommend a trial application.

NOTE: For wide cabinets, we recommend an additional lift mechanism be attached to the center panel to prevent the middle of the front from sagging when open.



Warning: Risk of injury by spring-loaded lever arm!

- Arm has built in safety feature to prevent opening and closing
- Secure lever arm before installing cabinet

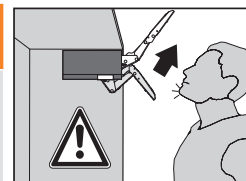

Step 1 – Determine the Power Factor for the Application



Power factor = cabinet height (inch) x door weight* (lb)

Determine power factor

To select the correct lift mechanism for a given application, the power factor must first be calculated by using the formula below. Use the table at the bottom of the page to convert ounces into decimal form for easy calculation.

Power factor = cabinet height multiplied by door weight*

Example:

Cabinet height: 20" (within possible range)

Door weight including twice the handle weight = 13 lb 14 oz (14 oz = .9 lb see chart below)

Power factor = 20 x 13.9

Power factor = 278

A power factor of 278 requires lift mechanism 22K2700

*Including twice the handle weight

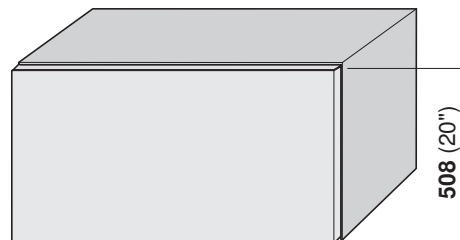

Door weight + twice handle weight = **13 lb 14 oz**

NOTE: AVENTOS planning tools available at blum.com/planning

Weight conversion chart

oz	1	2	3	4	5	6	7	8	9	10	11	12	13	14	15
lb	.1	.1	.2	.3	.3	.4	.4	.5	.6	.6	.7	.8	.8	.9	.9

Step 2 – Select the Required Components

Lift mechanism sets		
	Set includes: 1 Lift mechanism (qty 2) #7 x 35 (1-3/8") wood screw (qty 8)	NOTE: Symmetrical with wood screws including positioning template. Max front weight 39 lb for two lift mechanisms.
	Power factor range	Opening angle
	36 – 139	107°
	80 – 240	107°
	150 – 450	107°
	270 – 781	107°
		Part no.
		22K2300
		22K2500
		22K2700
		22K2900
Cover set		
	Set includes: 2 Right and left cover plate 3 Non-handed cover cap (qty 2)	NOTE: Light and Dark Gray options available Light Gray (HGIG) Dark Gray (TGIG)
		Part no.
Cover set		22K8000.NA
Narrow aluminum door hardware set		
	Set includes: 4 Arm assembly mounting plate (qty 2) 699.110 – Aluminum scREW for narrow aluminum lever arm mounting plate (qty 8)	
		Part no.
Narrow aluminum door hardware set		20S4200A

Door and Hardware Clearance and Positioning

Door and hardware clearance

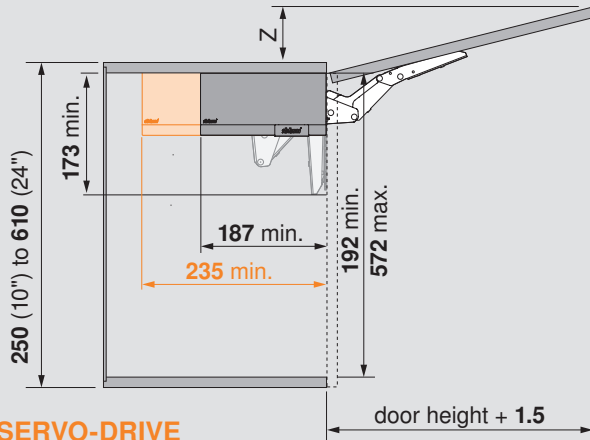

SERVO-DRIVE

NOTE: $Z = \text{door height} \times 0.29 + \text{door thickness} - \text{top panel thickness}$

Lift mechanism clearance

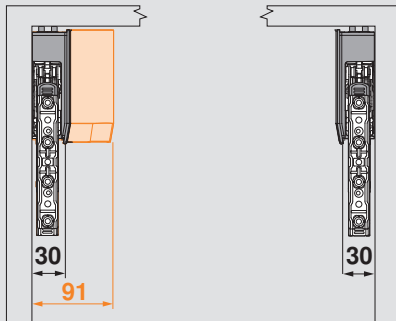

SERVO-DRIVE

Lift mechanism positioning

Attachment for lift mechanism for wood screws including positioning template.

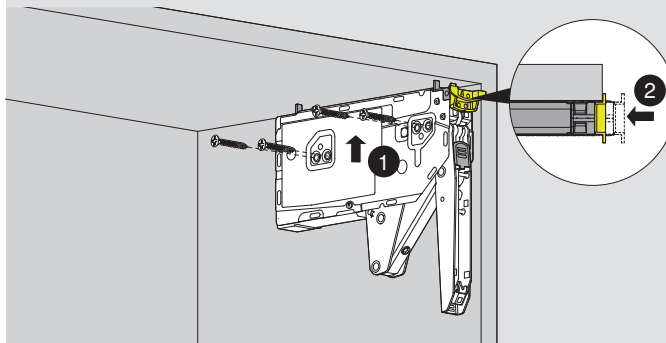

Door and Hardware Clearance

Minimum gap

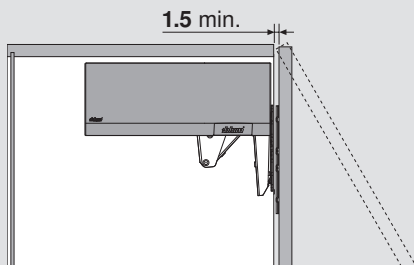

NOTE: Min gap assumes door radius of 1 and a maximum top overlay of 25.4

Decorative molding clearance

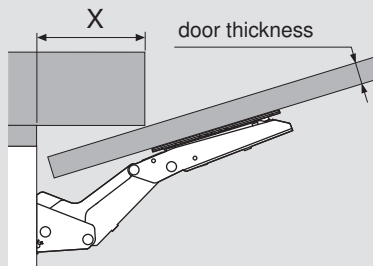

Door thickness	16	19	22	26
maximum X	70	59	49	35

Minimum bottom reveal

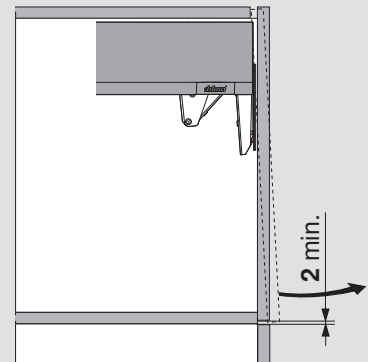

Arm assembly mounting plate location

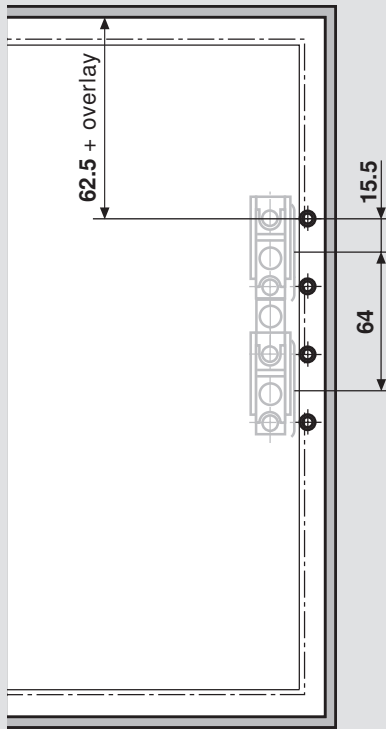

Arm assembly mounting plate attachment

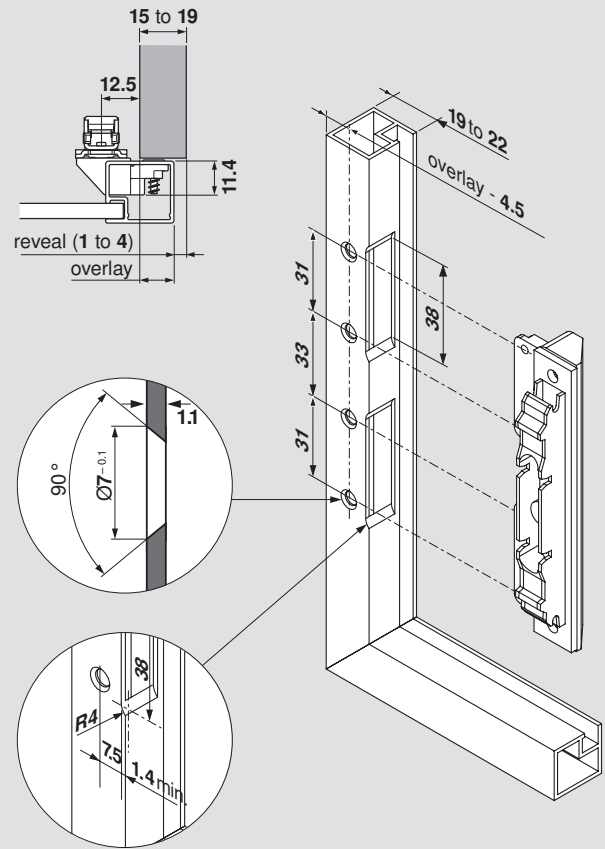

Follow the assembly instructions on page 16

Lift mechanism sets

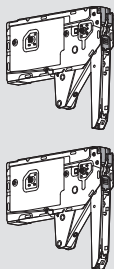

Set includes:

- Lift mechanism (qty 2)
- #7 x 35 mm (1-3/8") wood screw (qty 8)

NOTE: Symmetrical with wood screws including positioning template. Max front weight 39 lb for two lift mechanisms.

Power factor	Opening angle	Part no.
36 – 139	107°	22K2300T
80 – 240	107°	22K2500T
150 – 450	100°	22K2700T
270 – 781	100°	22K2900T

Cover set

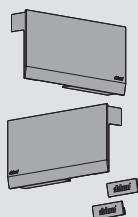

Set includes:

- Right and left cover plate
- Non-handed cover cap (qty 2)

NOTE: Light and Dark Gray options available.

- Light Gray (HGIG)
- Dark Gray (TGIG)

Part no.
Cover set
22K8000.NA

Wood or wide aluminum door hardware set

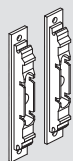

Set includes:

- Arm assembly mounting plate (qty 2)

Part no.
Wood or wide aluminum hardware set
20S4200
Installation screw for wood doors
606N or 606P
Installation screw for wide aluminum doors
7072A

NOTE: Refer to pages 8-9 for installation specifications

Narrow aluminum door hardware set

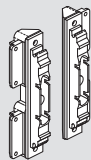

Set includes:

- Arm assembly mounting plate (qty 2)
- 669.110 aluminum screw for narrow aluminum lever arm mounting plate (qty 8)

Part no.
Narrow aluminum door hardware set
20S4200A

NOTE: Refer to pages 12-13 for installation specifications

AVENTOS HK top Ordering Information for TIP-ON

AVENTOS



TIP-ON set for standard doors



- White (SEIW)
- Gray (R736)
- Black (TERS)

Use of screw-on catch plate
required for all applications

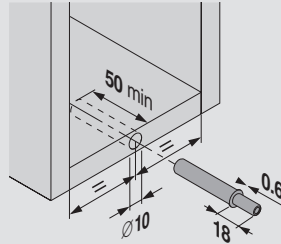

- Nylon gray unit with magnet tip
- Adjustment range +4 mm to -1 mm
- For door heights up to **400** (15-3/4")
- Works for overlay and inset applications
- Can be bored into the panel or used with an adapter plate

Set includes:

- TIP-ON unit
- Self-adhesive catch plate
- Screw-on catch plate
- Wood screw

Part no.

NOTE: Due to various door weights and sizes, trial application recommended

Standard door set

956.1004

TIP-ON set for large doors

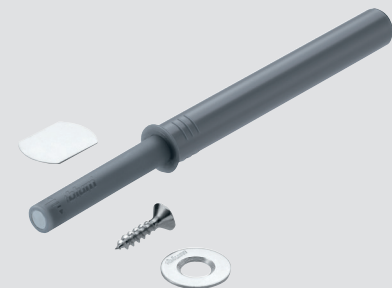

- White (SEIW)
- Gray (R736)
- Black (TERS)

Use of screw-on catch plate
required for all applications

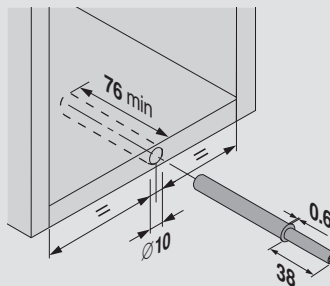

- Nylon gray unit with magnet tip
- Adjustment range +4 mm to -1 mm
- For door heights greater than **400** (15-3/4")
- Works for overlay and inset applications
- Can be bored into the panel or used with an adapter plate

Set includes:

- TIP-ON unit
- Self-adhesive catch plate
- Screw-on catch plate
- Wood screw

Part no.

NOTE: Due to various door weights and sizes, trial application recommended

Large door set

956A1004

TIP-ON for AVENTOS specifications

Standard doors

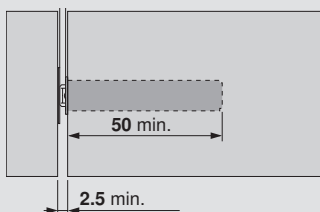

Large doors

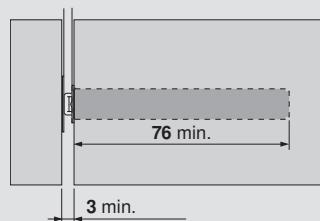

Screw-on catch plate specifications

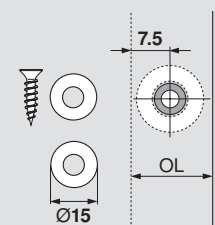

Pre-boring Ø2.5 countersunk
pilot holes are required

For TIP-ON adapter plate mounting please refer to the Concealed hinges brochure.

Remove positioning template

- 1 Push the positioning template down to remove.
- 2 Press up on arm release slide then slowly raise the arm to the upright position.

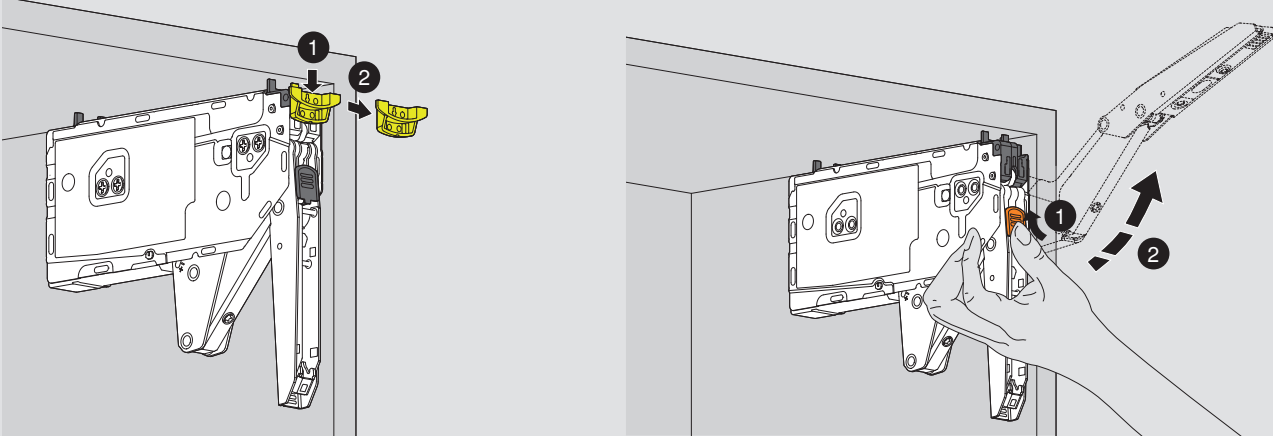

Attaching AVENTOS HK top doors

Attach the door using the CLIP mechanism to the arm assembly.

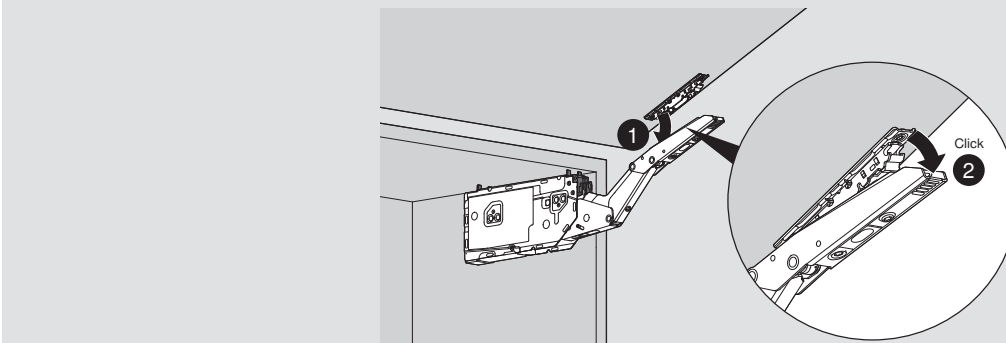

Adjust the lift mechanism

Use a T20 TORX screwdriver or screw gun and a T20 TORX bit to adjust the lift mechanism to the desired tension (door weight balanced). Cover cap does not need to be removed to perform this adjustment.

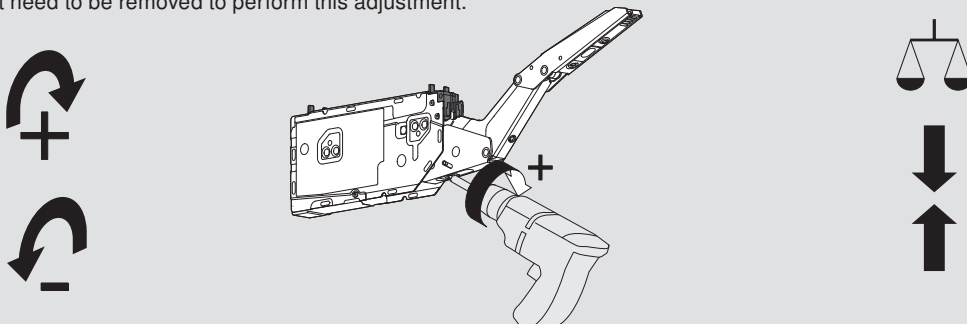

Warning: Risk of injury by spring-loaded lever arm!

- Arm has built in safety feature to prevent opening and closing
- Secure lever arm before installing cabinet

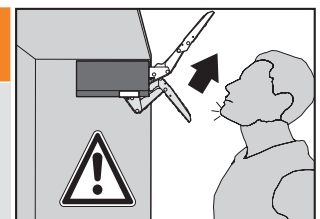

AVENTOS HK top door adjustment

Use a T20 TORX screwdriver to perform cam adjustments for each of the three-dimensional door adjustments.

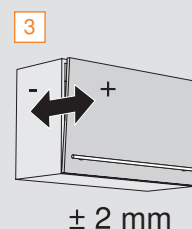
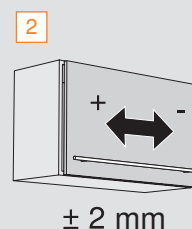
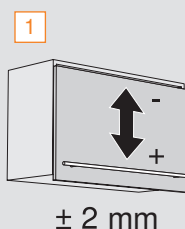
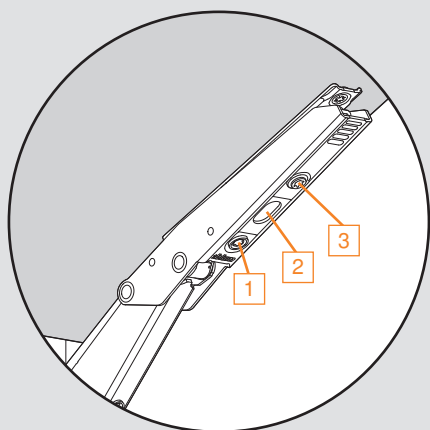

Attaching cover caps

Place the left and right cover plates over the appropriate lift mechanisms, and snap them in place.

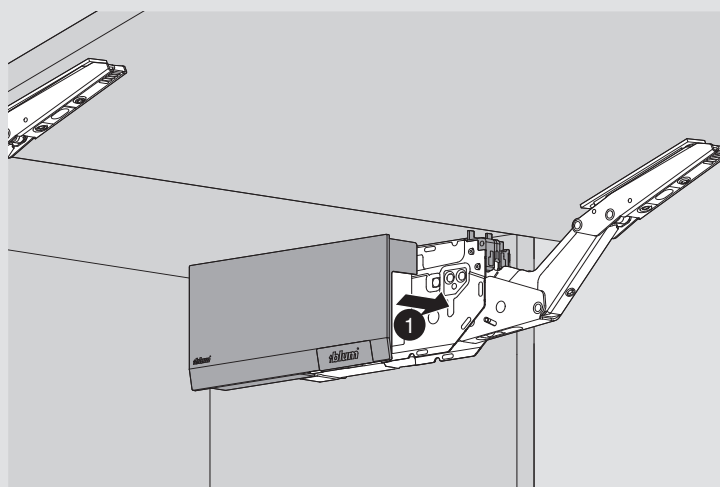

Adjust opening angle

Turn adjustment screw, with a T20 TORX screwdriver, until tight on both sides and desired angle is reached.

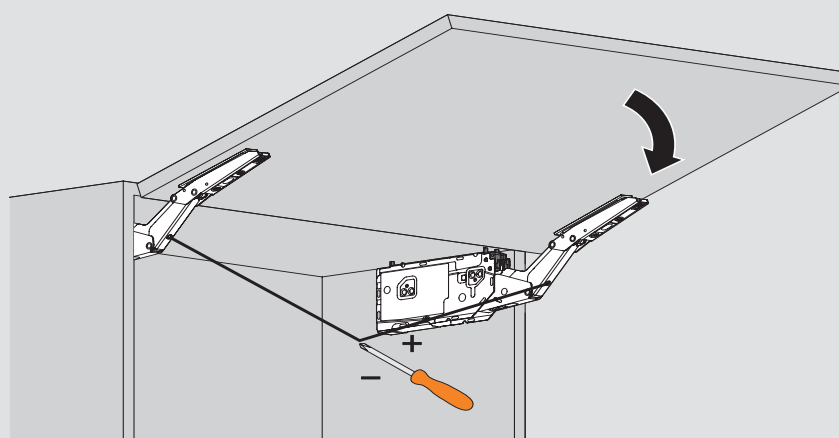

NOTE: Adjustments can be made with the cap on

AVENTOS HK top face frame mounting bracket set

- Brackets for mounting AVENTOS HK top in face frame cabinet
- Minimum recess of **12.5** (1/2")
- Provides accurate mounting position for lift mechanism

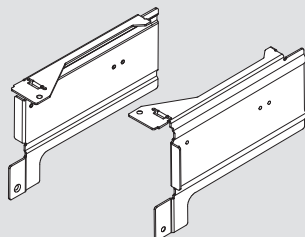

Set includes:

- Right and left brackets
- M4 x 30** lift mounting screws (qty 12)

Part no.

HK top frame mounting bracket set

22K6001

AVENTOS HK top face frame bracket mounting locations

Fixed setback allowing for up to **25.4** top overlay.

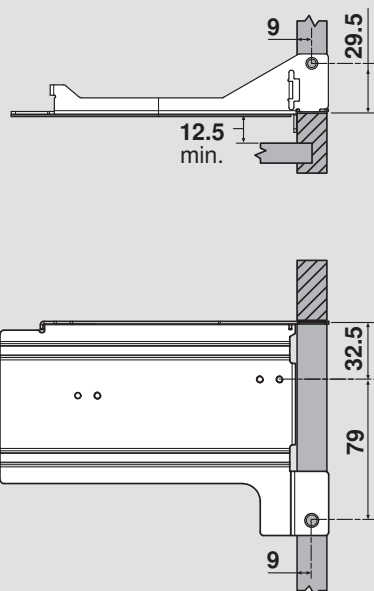

Attach bracket to face frame with two #7 x 3/4" (7074N) wood screws. Attach lift mechanism to bracket with four **M4 x 30** machine screws (included).

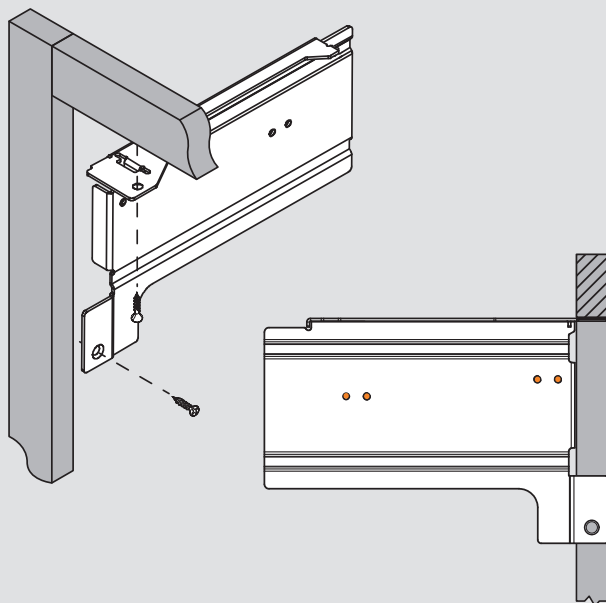

NOTE: Machine screw mounting locations marked in orange

Assembly Aids

AVENTOS



TORX DRIVER

- For AVENTOS HK top and LEGRABOX adjustments
- TORX size 20 (T20)
- Blade length **100**
- Total length **210**



Part no.

T20 TORX DRIVER

TORX DRIVER

Short TORX DRIVER

- For AVENTOS HK top and LEGRABOX adjustments
- TORX size 20 (T20)
- Blade length **35**



Part no.

T20 TORX DRIVER

SHORT TORX DRIVER

POZI DRIVER

A POZI screwdriver (different from Phillips) is the most crucial tool you can use to assure that full torque is applied to all Blum mounting screws. POZI screws can be identified by the distinctive "tick" marks located in the center of the screwhead recess.

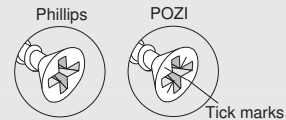

Part no.

#2 POZI DRIVER

POZI DRIVER

1/4" Magnetic bit holder

BIT HOLDER

#2 x 1" POZI bit insert

POZI BIT #2X1

#2 x 2" POZI bit insert

POZI BIT #2X2

Front marking template for HK top

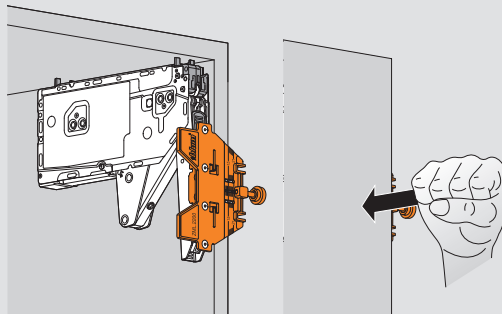
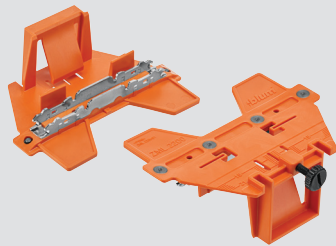

- Used to determine the location for the arm assembly mounting plate
- Side overlay adjustable from **12** to **21** mm
- Calibrated scale for accurate setting
- Only intended for frameless cabinets
- Instructions included with template

Part no.

Template

ZML.2200

Universal individual template

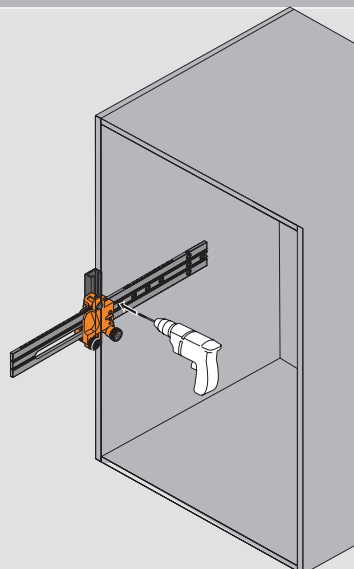
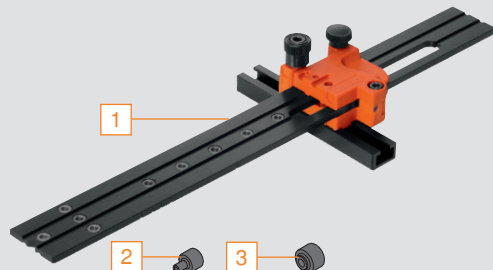

- Used to pre-bore for AVENTOS lift mechanism locating pins
- Also used for pre-boring for cabinet profiles and BLUMOTION for doors and TIP-ON for doors adapter plates
- Calibrated scale for accurate setting

Set includes:

- Universal individual template
- Ø2.5** stop collar
- Ø5** stop collar

Part no.

Template

65.1051.02

Ø2.5 drill bit

DB-2.5mm R

Ø5 drill bit

DB-5mm R

SERVO-DRIVE for AVENTOS HK top

AVENTOS HK top is also compatible with other Blum motion technologies that help create an awe-inspiring space, like SERVO-DRIVE, our electrical motion support system. With one-touch opening and closing, SERVO-DRIVE increases the functionality of the cabinet, and even with the added electrical drive unit, the mechanism remains impressively compact.





Contents

SERVO-DRIVE for AVENTOS HK top

- 22** SERVO-DRIVE Ordering Information
- 23** Electrical Components
- 25** Assembly for HK top SERVO-DRIVE
- 27** Activating SERVO-DRIVE
- 30** Additional Features
- 33** Deactivating SERVO-DRIVE

SERVO-DRIVE for AVENTOS HK top



AVENTOS HK top SERVO-DRIVE Ordering Information

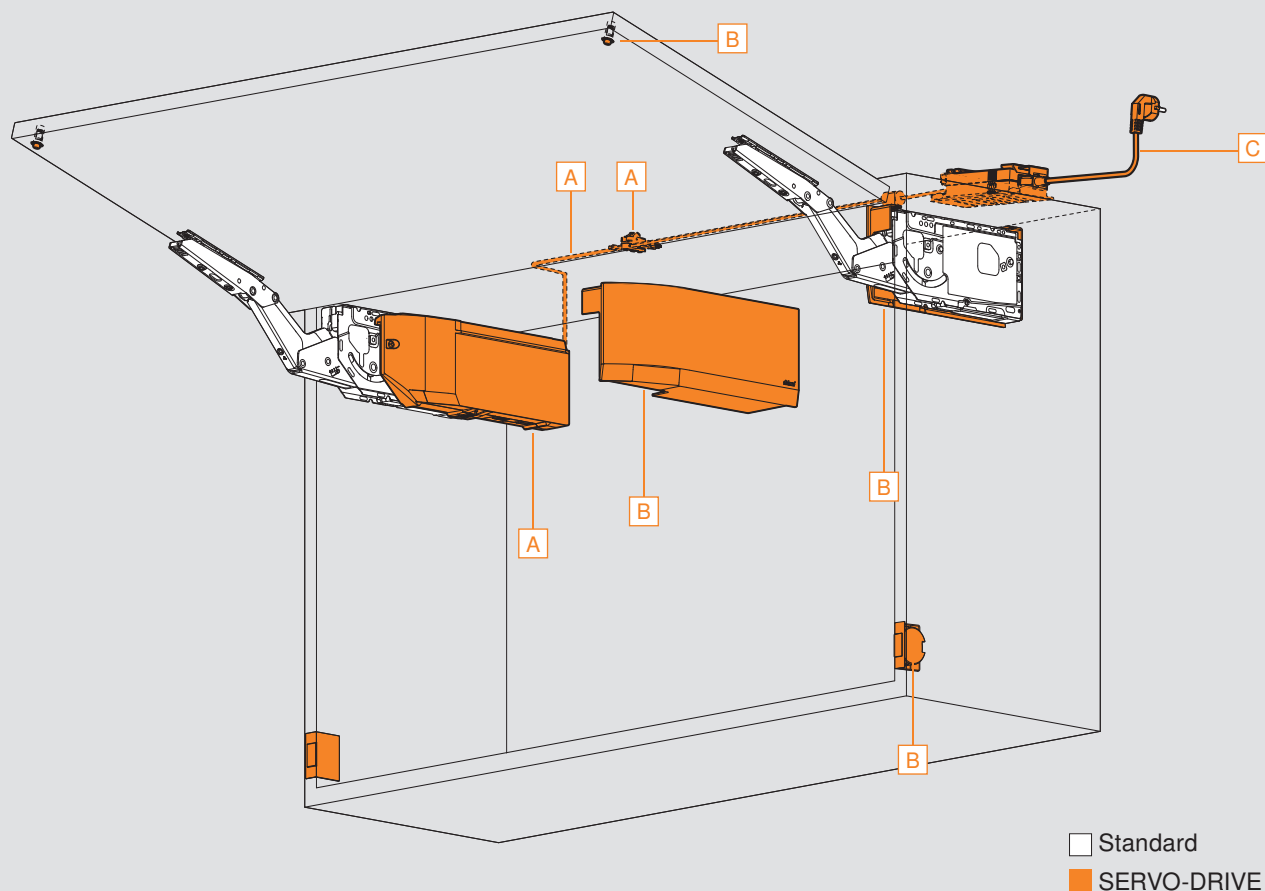

SERVO-DRIVE set

A Set includes:

- Drive unit
- 60" universal cable
- Cable connector
- Cable end protector (qty 2)

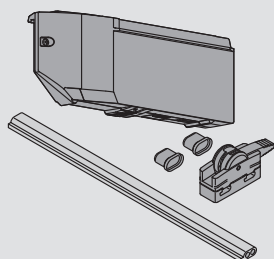

Part no.

SERVO-DRIVE set

23KA000

Cover set

B Set includes:

- SERVO-DRIVE cover plate (left)
- Cover plate (right)
- Non-handed cover cap (qty 2)
- SERVO-DRIVE switches (qty 2)
- Ø5 Blum distance bumper (qty 2)
- Color options: light gray or dark gray

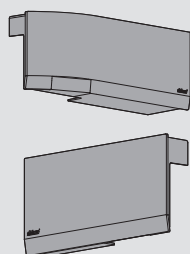

Light Gray (HGIG)

Dark Gray (TGIG)

Part no.

Cover set

23K8000.NA

Power Supply

C Power supply options - see page 23

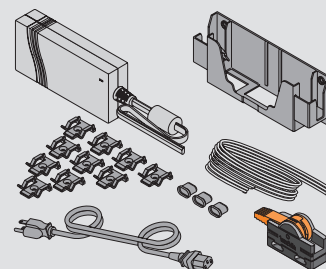

NOTE: For additional AVENTOS HK top components and installation instructions, see pages 7-9

Electrical Components

SERVO-DRIVE for AVENTOS HK top



Option 1: Power supply set

Set includes:

- Power supply
- Wall mount bracket
- Three-prong power cord
- Cable connector
- Cable end protector (qty 3)
- Cable clips (qty 10)
- 19 feet universal cable

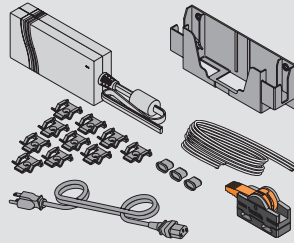

Part no.

Power supply set

Z10NE03UG10

Option 2: SERVO-DRIVE uno power supply

Supplies power to a single drive unit

- 44" power cord
- Extendable up to 6 feet using cable connectors (sold separately)



Part no.

Power supply set

Z10NA30UGF

SERVO-DRIVE switch

For adding additional activation switches to a SERVO-DRIVE for AVENTOS application.

- Up to six switches can be added per drive unit
- Color options: light gray or dark gray

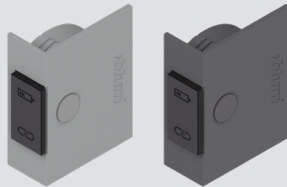

NOTE: A switch can only be synchronized to one drive unit

Part no.

SERVO-DRIVE switch (set of 2)

23P5020

SERVO-DRIVE switch adapter

- Used for face frame and frameless applications
- Doesn't require boring into side of cabinet
- Color options: light gray or dark gray

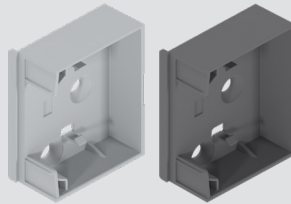

Part no.

SERVO-DRIVE switch adapter

23P5216

Space requirements and safety distance for power supply

A safety distance of **30 mm** must be maintained for air circulation

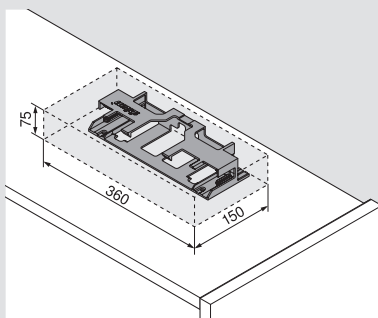

Output specifications

Output voltage	24 VDC
Output power	24 W continuous / 12 W continuous*
Minimum load	None
Over voltage protection	At 33 VDC
Overload protection	10.5 A hiccup trip and restart mode with auto recovery
Short circuit protection	Continuous

*12 W Output power applies to SERVO-DRIVE uno only

Environmental information

Operating temperature	32° F–104° F
Storage temperature	-4° F to 185° F
Protection	IP40

Input specifications

Input voltage	100-240 VAC
Input frequency	50-60 Hz
Input current	0.6 A
Inrush current	100 A maximum at 240 VAC
Protection class	Class I
Earth leakage current	3.5 mA maximum

General specifications

Efficiency	≥ 87%
Switching frequency	65 kHz typical
No load loss (standby)	< 0.075 W
Energy Star	Level VI

Safety / Approvals

EN / IEC	60950, 60335-1
UL	60950-1

SERVO-DRIVE for AVENTOS HK top



Wiring Options

Assembly on the cabinet top panel

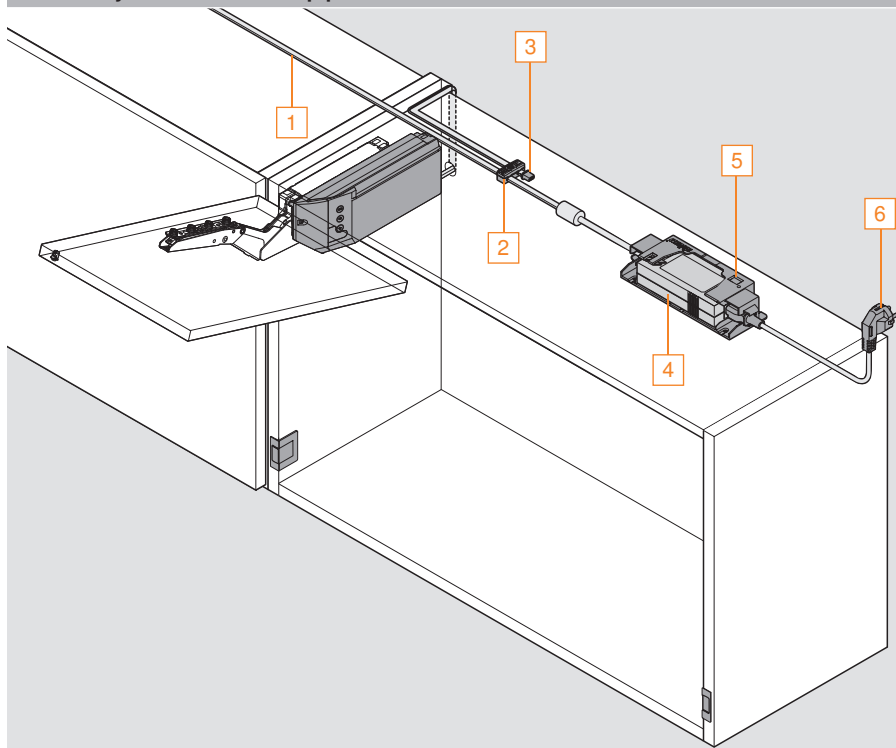

- 1 Distribution cable for cutting to size
- 2 Connecting node
- 3 Cable end protector
- 4 Blum transformer
- 5 Transformer unit housing
- 6 Plug

i Only one Blum transformer can be connected to each distribution cable.

Back cabling

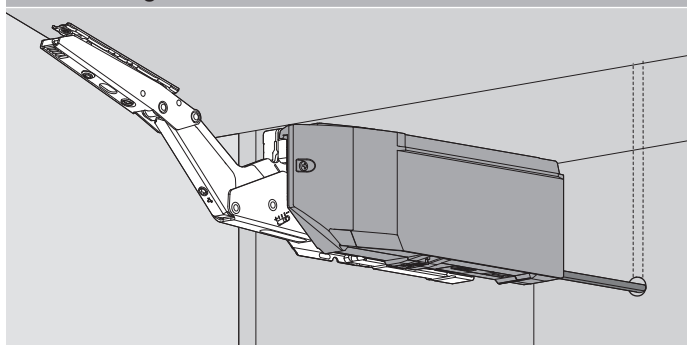

Top cabling

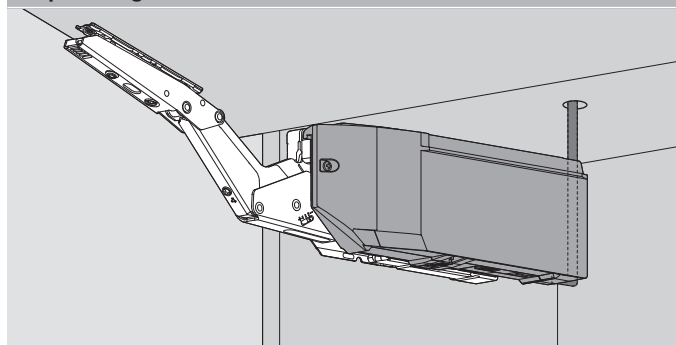

Installing cable connector

- 1 Insert cable for distribution into open slot
- 2 Insert cable for power into open slot
- 3 Rotate orange lever to lock into place
- 4 Slide cable end protector over exposed cable

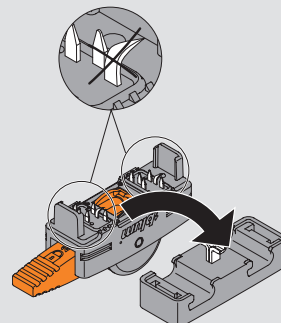
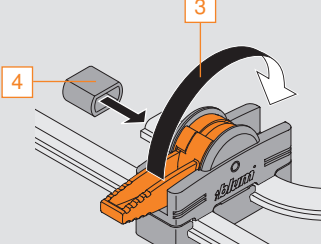
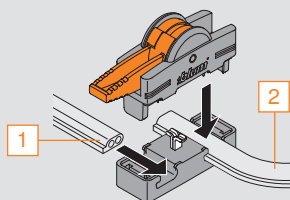

NOTE: Ensure piercing pins are not damaged

Installation of SERVO-DRIVE activation switch

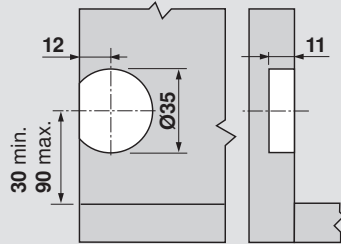

The activation switch should be installed by pressing into the cabinet side with your hand. Do not use hammer to install.

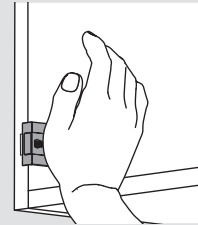

NOTE: Use of boring template (M31.2000) recommended, see page 35

Installation of Blum distance bumpers

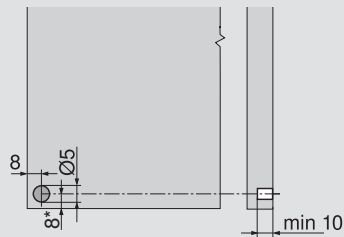

Install into door front.



NOTE: The distance bumper should not touch the SERVO-DRIVE switch

Installation of universal cable

1 Pull down orange universal cable lock lever

2 Insert universal cable (either end of the cable can be used)

3 Once cable is inserted, push up on universal cable lock lever

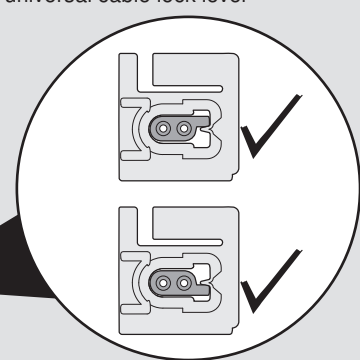
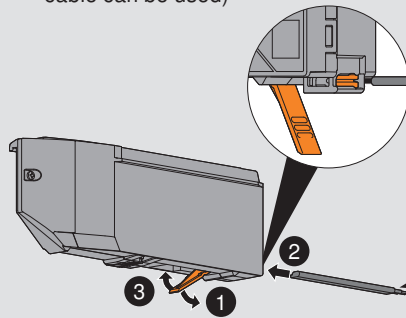
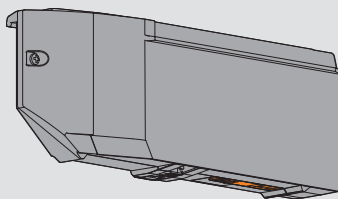

Drive unit installation

- 1 Position drive unit onto lift mechanism with locating tabs.

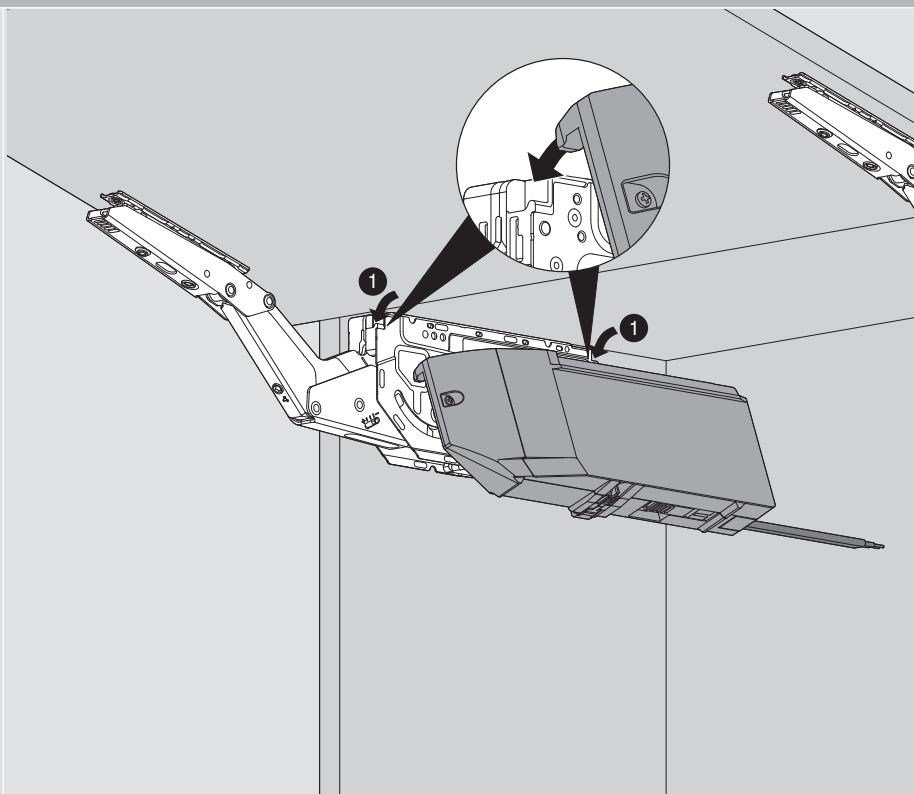

- 2 To lock drive unit to the lift mechanism, hold drive unit in place and press the bottom of the drive unit to click into place. Drive unit pin will self-locate during reference run.

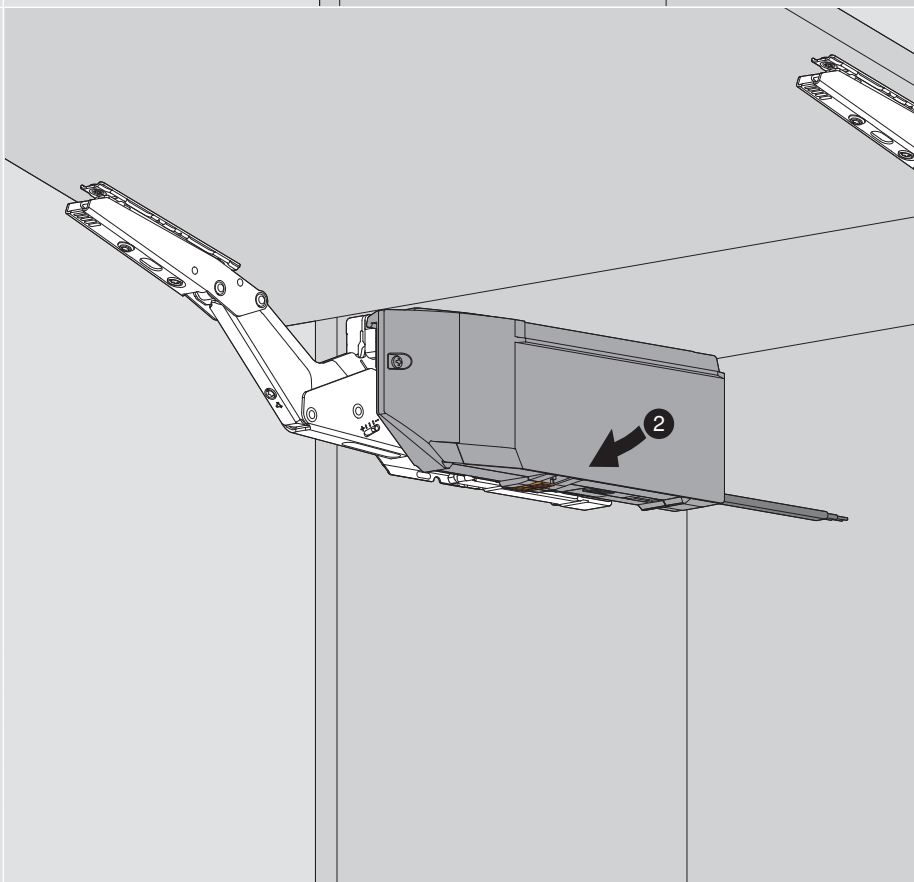

Overview of Functions

SERVO-DRIVE for
AVENTOS HK top



Start-Up

A Activating the SERVO-DRIVE switch

Additional Features

Optional

C Activating synchronization

B Start reference run

Optional

D Activating collision avoidance

Deactivation

E Reset to Default

Function buttons layout

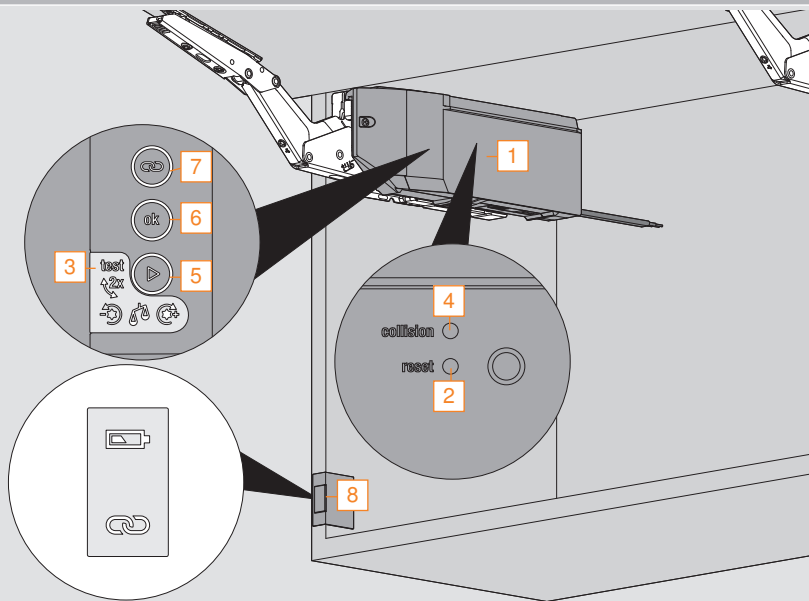

- 1 Drive unit
- 2 <Reset> button
- 3 LED
- 4 <Collision> button
- 5 <Play> button
- 6 <Ok> button
- 7 <Link> button
- 8 SERVO-DRIVE switch



SERVO-DRIVE for AVENTOS HK top

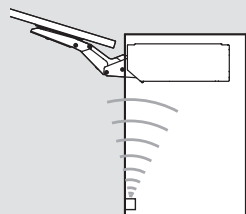

Start-Up

A Linking the SERVO-DRIVE switch



-  Operation
-  Lights up continuously
-  Flashes

Set up the wireless connection between the SERVO-DRIVE switch and the drive unit. Each switch can only be assigned to one SERVO-DRIVE unit.

NOTE: Up to 6 switches can be programmed to a single drive unit

1 Press flashing link button.

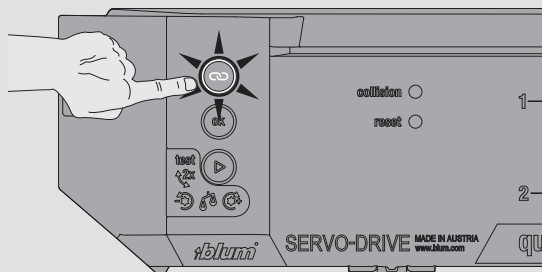

2 Link button lights continuously.

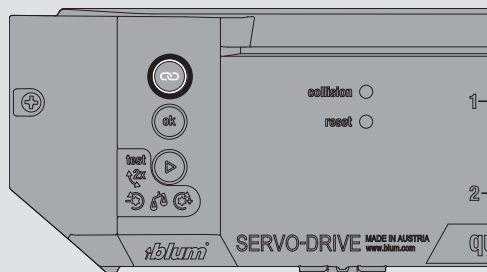

3 Press each switch to link.

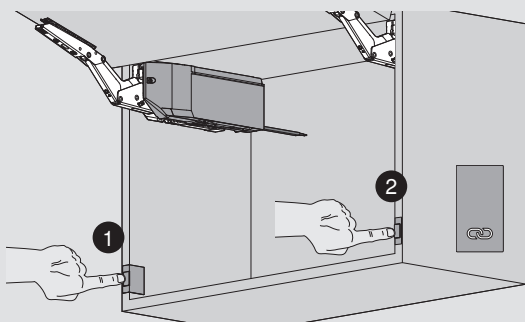

4 Press flashing "ok" button to complete linking.

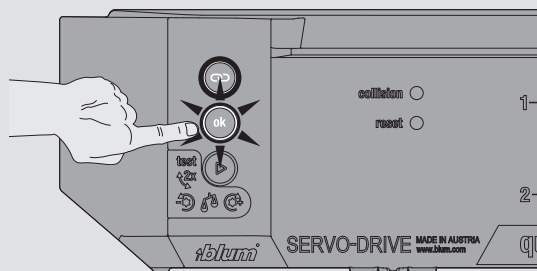

5 Proceed to start reference run. Page 29

B Start reference run

The drive unit recognizes the required parameters using the reference run.

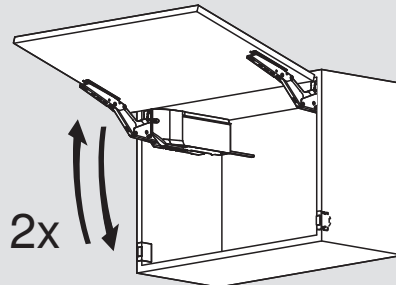

1 Press flashing play button.

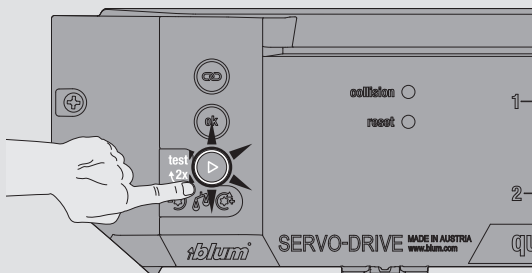

2 Door will cycle twice. Do not interrupt.

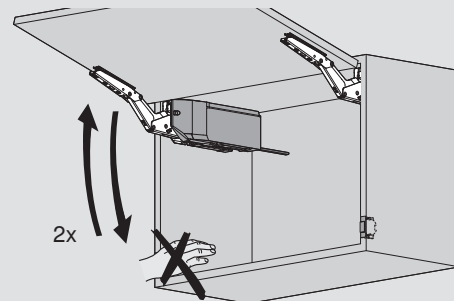

3 Ok button lights continuously. Setup complete.

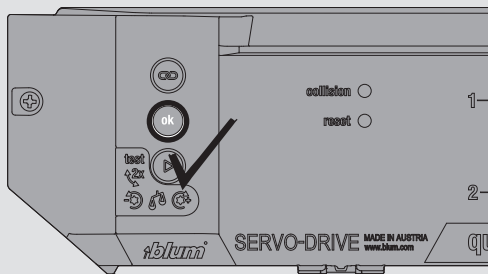

Reference run with error detection.

1 Unbalanced door error detection after reference run.

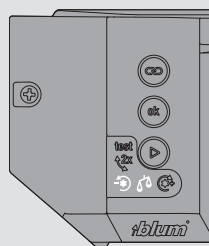

Too much tension.

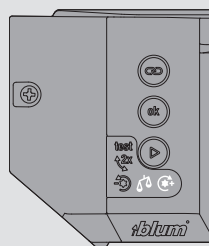

Not enough tension.

2 Adjust tension accordingly to balance door.

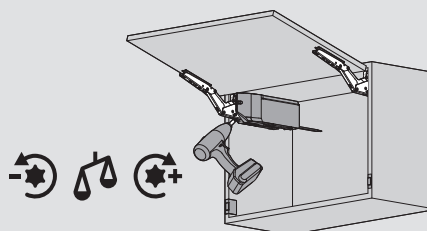

3 Press play button to perform reference run again.

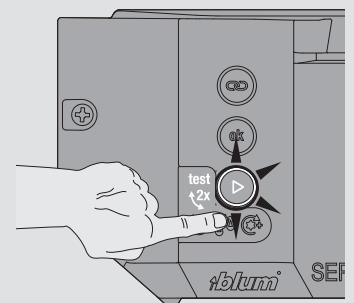

C Activating synchronization

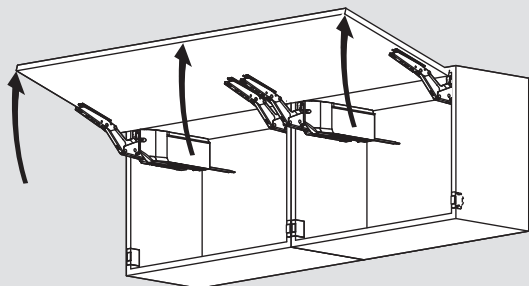

Up to three drive units can be synchronized allowing them to move simultaneously. This function is required for several cabinets with a single front.

NOTE: Up to 6 switches can be programmed to a single drive unit

1 Press link button on first drive unit.

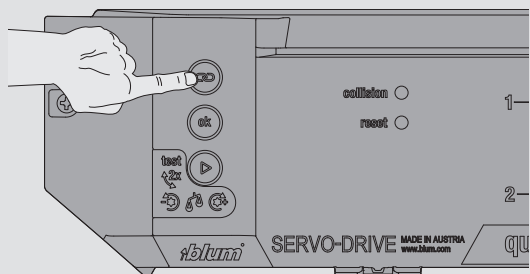

2 Link button lights continuously.

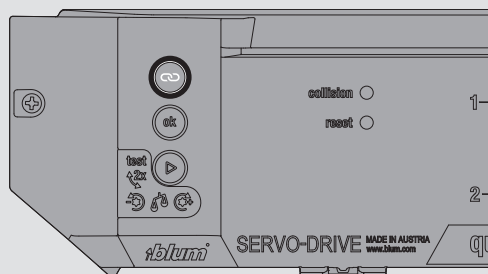

3 Press link button on second drive unit. Recommended to link switches at this step as well.

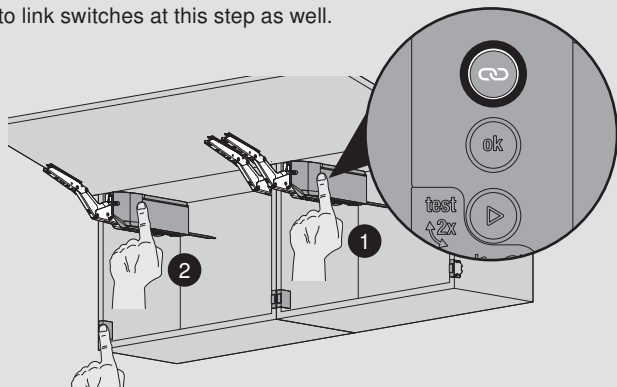

4 Confirm link by pressing flashing ok button.

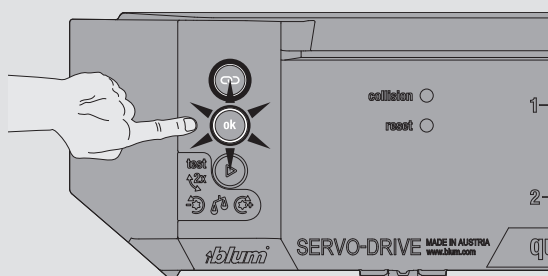

5 Ok button lights continuously.

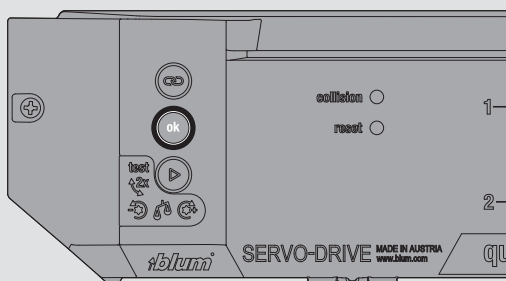

6 Press flashing play button to start reference run and complete synchronization.

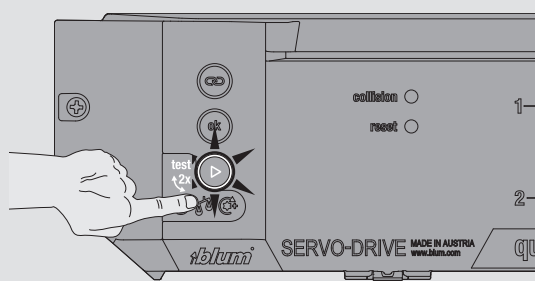

D Activating collision avoidance

To avoid the collision of fronts, drive units (max. 6) can be linked so that only one front can be opened at a time. A front is prevented from opening as long as a linked front remains open.

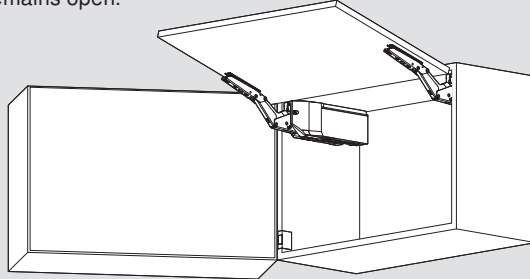

1 Press collision button on first drive unit.

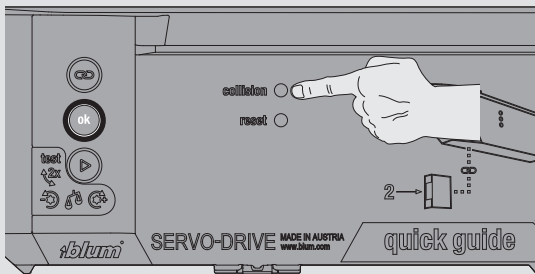

2 Collision button will light blue continuously.

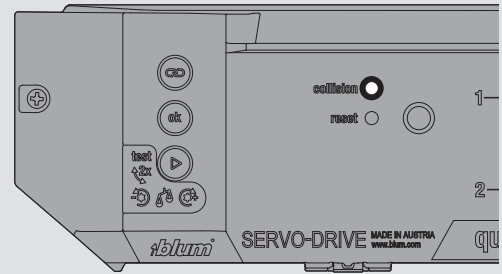

3 Close door one and open door two.

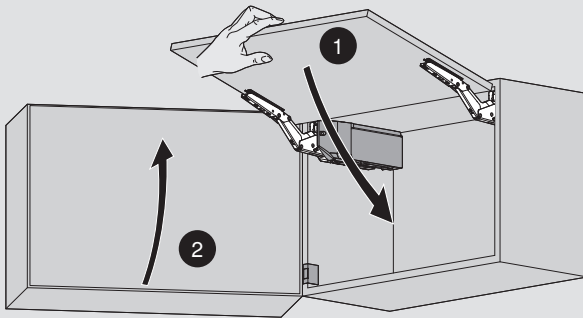

4 Press collision button on second drive unit.

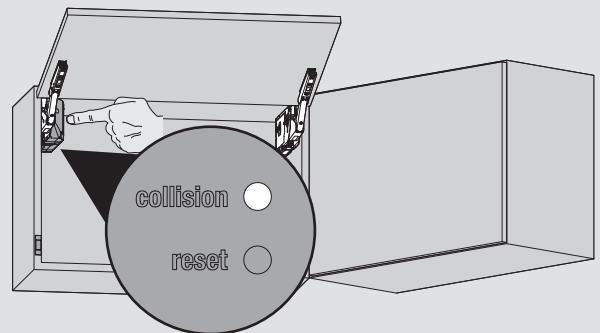

5 Press flashing ok button to complete link.

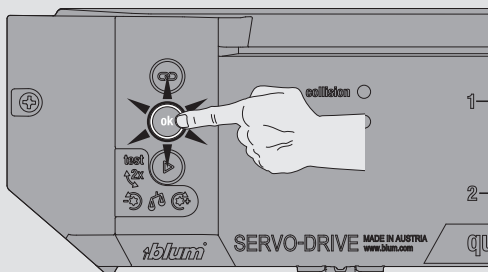

6 Link complete when ok button lights continuously.

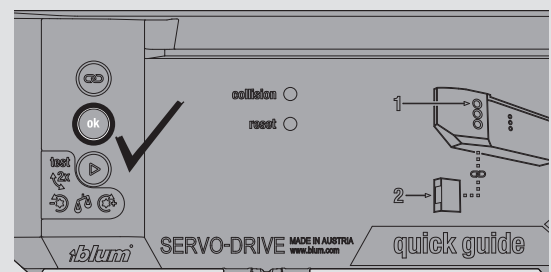

SERVO-DRIVE for AVENTOS HK top



Collision Avoidance with Other Drive Units

- 1 Press and hold COLL button on drive unit until...

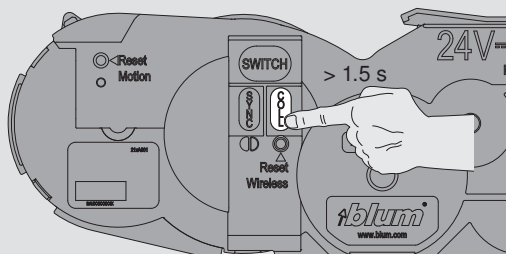

- 2 Flashing green light appears. Close door.

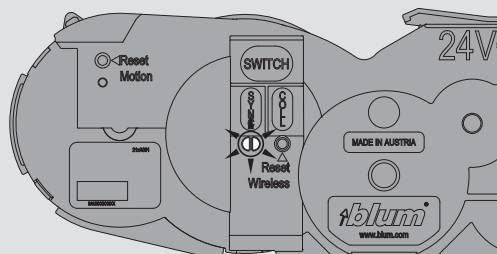

- 3 Open HK top door and press collision button on HK top drive unit.

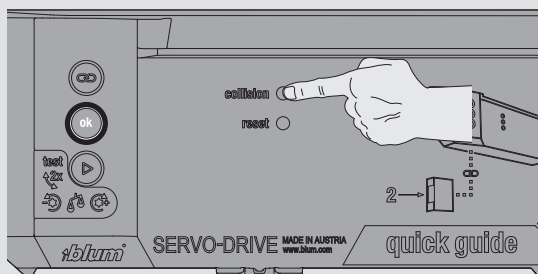

- 4 Press flashing ok button.

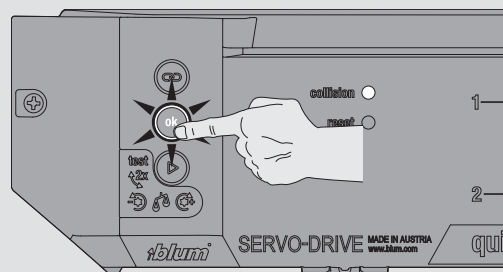

- 5 Collision button on HK top drive unit will begin to flash.

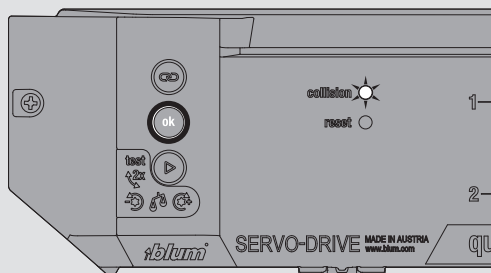

- 6 LED lights continuously on other unit.

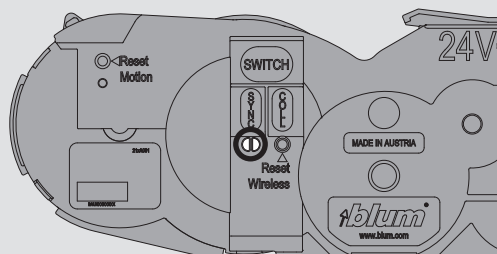

- 7 Collision button lights continuously.

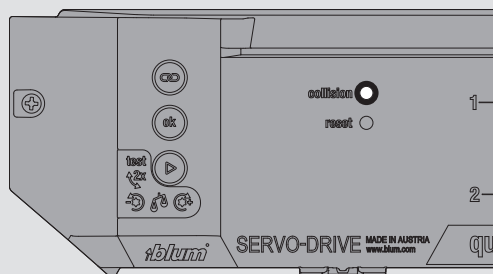

- 8 Link complete when ok button lights continuously.

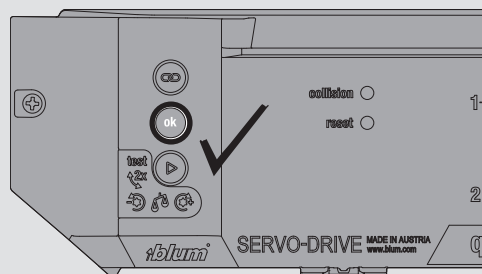

Cover Cap Assembly, Switch Battery Replacement, and Drive Unit Reset

SERVO-DRIVE for
AVENTOS HK top



Cover cap assembly

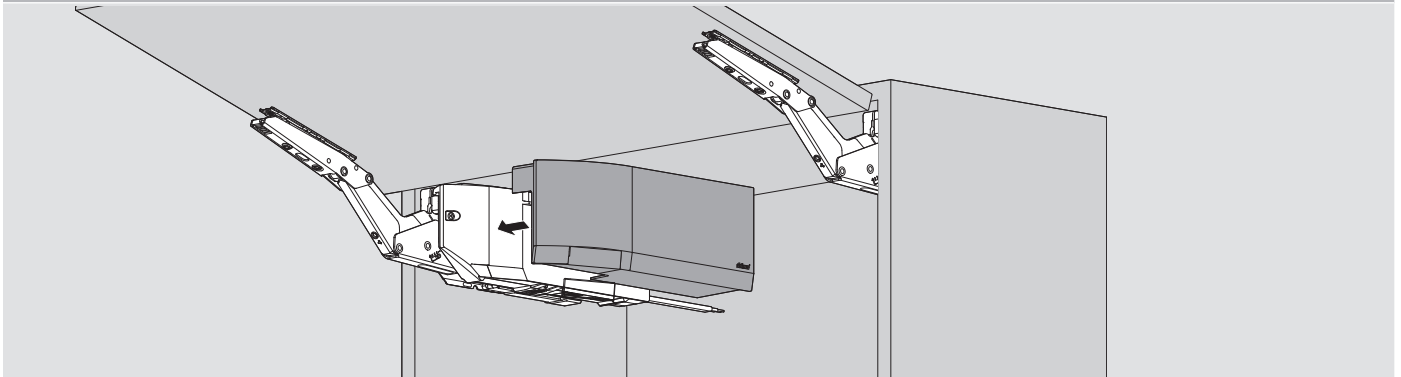

Replacing the SERVO-DRIVE switch battery

When the battery power begins to weaken, the battery display (LED) begins to flash red. If the battery is inserted incorrectly, the SERVO-DRIVE switch battery display will flash red.

- 1 Press release button on switch and remove battery tray.

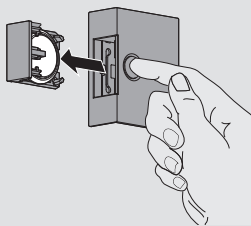

- 2 Remove old battery.

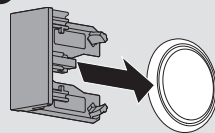

- 3 Replace with new battery.

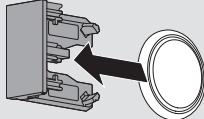

- 4 Insert battery tray back into switch.

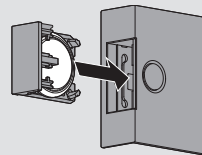

- Open the SERVO-DRIVE switch and remove the battery
- Insert the new battery (type CR2032) and close the SERVO-DRIVE switch - note correct polarity +/-

Note: The SERVO-DRIVE switch battery must not be recharged or discarded into fire.

E Reset

Reset the drive unit to the factory setting.

- 1 Press reset button.

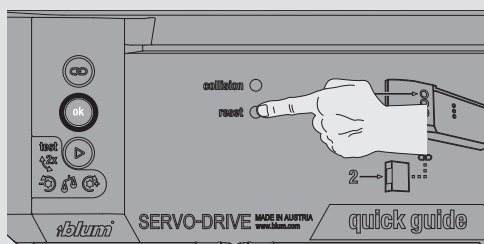

- 2 Link button will flash continuously when reset complete.

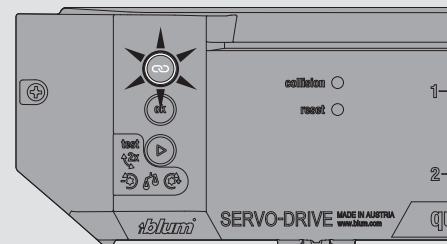

SERVO-DRIVE for AVENTOS HK top



Removal

SERVO-DRIVE removal

- 1 Remove cover cap.

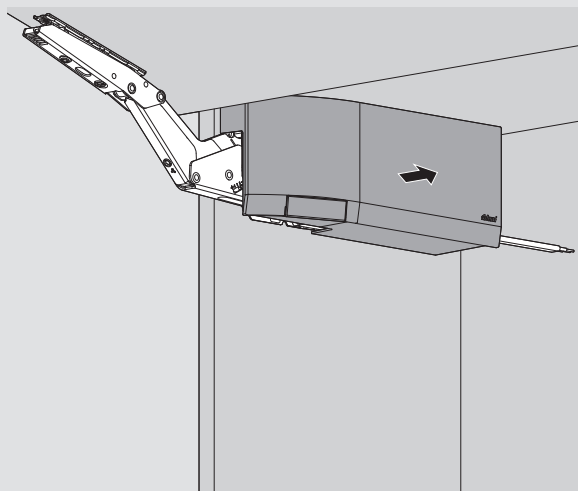

- 2 Press on drive unit release clip and lift unit off lift mechanism.

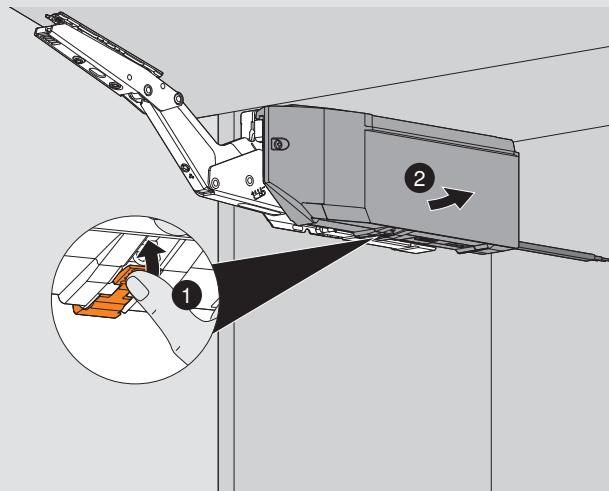

- 3 Remove distribution/power cable.

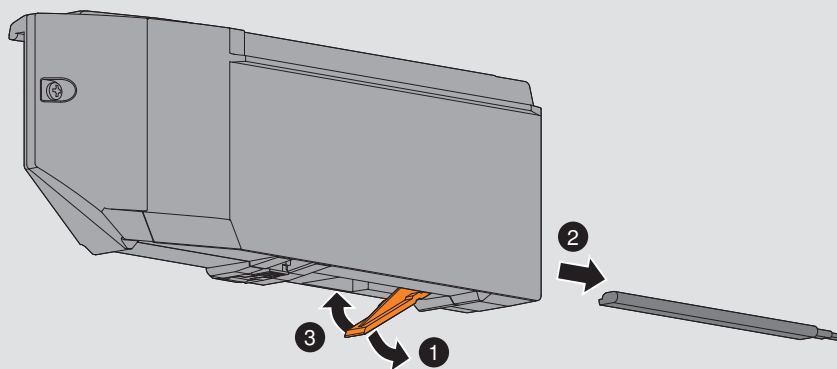

SERVO-DRIVE switch boring template

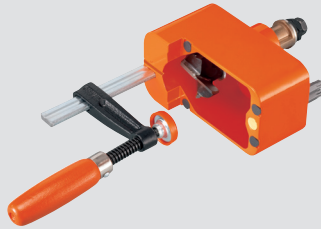

- For easy installation of SERVO-DRIVE for AVENTOS switch
- Clamp assembly for secure boring

Set includes:

- Ø35 mm bit
- Torx driver bit (qty 2)

Part no.

SERVO-DRIVE switch boring template

M31.2000

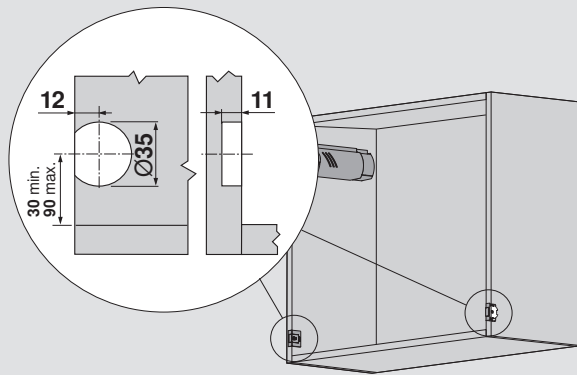

Mark switch location

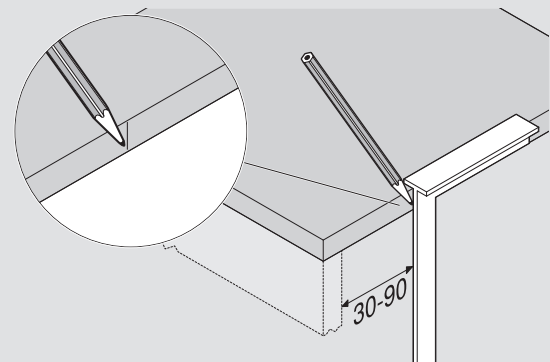

- Set drilling depth
- Align mark
- Secure template to cabinet panel with clamp
- Use provided Torx driver bit to bore hole

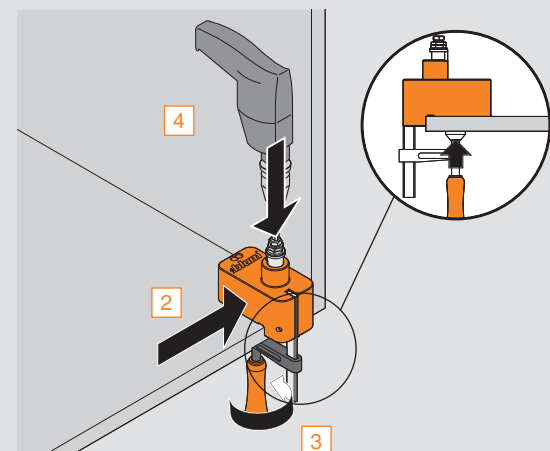
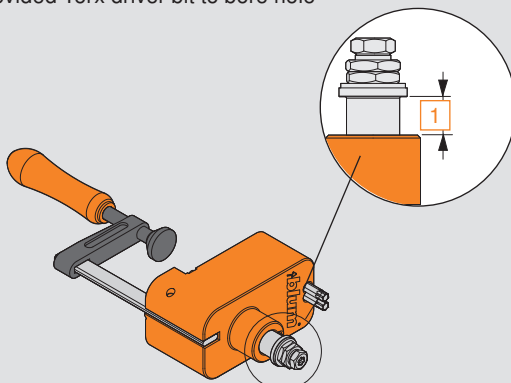

SERVO-DRIVE for AVENTOS HK top



AVENTOS HK top Part Number Index

Part no.	Page no.
20S4200	7, 14
20S4200A	11, 14
20S4F01	7
22K2300	7, 11
22K2300T	14
22K2500	7, 11
22K2500T	14
22K2700	7, 11
22K2700T	14
22K2900	7, 11
22K2900T	14
22K6001	7, 18
23K8000	22
22K8000.NA	7, 11, 14
23KA000	22
23P5020	23
23P5216	23
606N	7, 14
606P	7, 14
65.1051.02	19
7072A	7, 14
956.1004	15
956A1004	15
BIT HOLDER	19
DB-2.5mm R	19
DB-5mm R	19
M31.2000	35
POZI BIT #2x1	19
POZI BIT #2X2	19
POZI DRIVER	19
SHORT TORX DRIVER	19
TORX DRIVER	19
Z10NA30UGF	23
Z10NE03UG10	23
ZML.2200	19

[>](#) **Connect With Us on Social Media**







Why Choose Blum



The Blum name stands for quality, innovation and great customer service. We manufacture hardware that makes working in the kitchen easier, no matter the age of the user, and we do this globally. We've been in the United States for more than 40 years, and we are committed to manufacturing for the American market. Blum supports the United States market with a network of distributors, knowledgeable Blum sales representatives and an experienced customer service department. Each of our products has been designed carefully, with the customer experience in mind. We have a deep commitment to research and believe anyone who manufactures, sells, installs or uses our products should benefit from our knowledge and experience. We specialize in engineering and manufacturing concealed hinges, drawer systems and systems for lift-up doors. From our touch-to-open technology, to the soft-closing door or drawer, our hardware helps modernize the kitchen experience.



To learn more about Blum, visit blum.com/tour



Blum, Inc. is ISO 9001 certified which means that you are assured of consistent quality in every Blum product. They exceed the requirements of ANSI/BHMA standards for cycle life, static load and self-closing performance.



Please visit blum.com for information on other Blum products
LIT-AVT1900.04.20 Ident. 7629439 © 2020 Blum, Inc.

Blum, Inc.
7733 Old Plank Rd.
Stanley, NC 28164
800-438-6788
blum.com

FSC LOGO



ISO 9001
Certified Quality
System

