

## ► 721DW Drawer Lock

**BEST**  
For BEST style  
interchangeable  
core cylinders

ANSI/BHMA  
A156.11 Grade 1  
E07121

Woodwork Institute  
(WI) acknowledged  
product

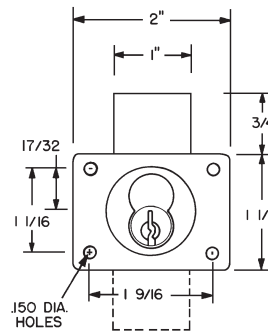
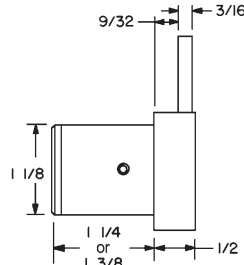

US19 flat  
black finish now  
available

721DW-LB

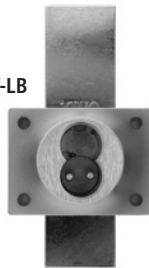

Long bolt option for  
drawer configuration

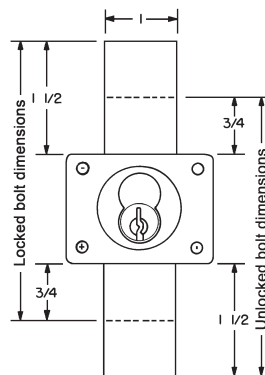

Shown in vertical  
function. Reverse  
dimensions for inverted  
function.

### KEY REMOVABLE LOCKED OR UNLOCKED POSITION

Item	Function	Finish	Cyl. Length	Description
721DW	Drawer	26D, US26, US3, 10B, US19	1-1/4"	Lock body - For small format IC
721DW-SP1	Drawer	26D, US26, US3, 10B	1-1/4"	Lock body - For Sargent XC or Marks high security cores. Includes short pin prong driver 721DW-11-SP1
721DW-138	Drawer	26D	1-3/8"	Lock body - For small format IC
Long bolt	Specify <b>LB</b> for long bolt installed in lock. Extends the overall bolt length by 1-1/2".			

### KEY RETAINING (KEY REMOVABLE LOCKED POSITION ONLY)

Item	Function	Finish	Cyl. Length	Description
721DW-KR	Drawer-KR	26D, US26, US3, 10B	1-1/4"	Lock body - For small format IC
721DW-KR138	Drawer-KR	26D	1-3/8"	

**Key-retaining:** Cycle to "locked" position before inserting core.

## SPECIFICATIONS

**Retrofits:** Best 3L

**Reversible:** Field reversible between door and drawer functions

**ANSI/BHMA:** Passed ANSI/BHMA A156.11 Grade 1 performance requirements. Equivalent to E07121 (721DR) / E07041 (721DW)

**Standard function:** Key removable in locked and unlocked position.

**Key-retaining function:** Key removable in locked position only. Specify **-KR** for key-retaining.

**US Patent Nos:** 4,899,563; 4,920,774

**Barrel diameter:** 1-1/8"

**Cylinder length:** 1-1/4" or 1-3/8"

**Body:** Zinc die cast

**Finish:** US26, 26D, US3, US10B or US19

**Packaged:** Packed 10 per box

## KEYING INFORMATION

**Cores:** Not included

**Accepts:** Best, Arrow, Falcon, KSP, Schlage SFIC or equivalent small format interchangeable cores

**Compatible electronic cylinders:** Medeco Nexgen XT or VIDEX CyberLock SFIC cylinders

## INCLUDED ACCESSORIES

**For 1-1/4" barrel length locks:**

- 725-1 spacer to fit 6 or 7 pin cores
- 725-PA plastic thumbturn
- 10-350 (qty 3) plastic spacers
- 10-054 1/4" plastic bar strike
- 10-057 .65" plastic bar strike

**For 1-3/8" barrel length locks:**

- 725-1 spacer to fit 6 or 7 pin cores
- 725-PA plastic thumbturn
- 10-054 1/4" plastic bar strike

## OPTIONAL ACCESSORIES

See the accessories section of this catalog for a complete list.

**Spacers:** 10-350 (1/8" thick), 10-348 (1/4" thick), 10-349 (1/2" thick)

**Strikes:** 10-052, 10-055, 10-056, 10-058, 12-2, 12-4

**Trim ring:** TR78

**Through-bolt hardware:** ETS1 trim plate, ETS1-PL trim pull and ETST1 template

**SFIC cores:** 206/207 Series (page 60)

**Long bolt only:** 721-1-LB



**OLYMPUS  
LOCK**  
INC.

Tel: 206.362.3290 | 800.525.0954  
Fax 206.362.3569 | www.olympuslock.com



The following warning is applicable to all parts listed on this page:  
**WARNING:** This product can expose you to chemicals including chromium, which is known to the State of California to cause cancer and birth defects or other reproductive harm. for more information go to www.P65Warnings.ca.gov.