

OVVO® V Connection System

1240 Releasable Specifications

THE FUTURE OF CONNECTION

ovvo
www.ovvotech.com

1240 Releasable

1240RH

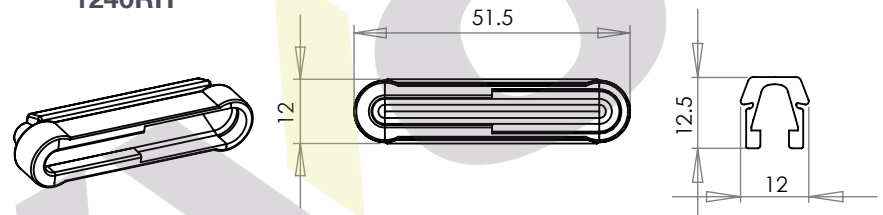

1240RC

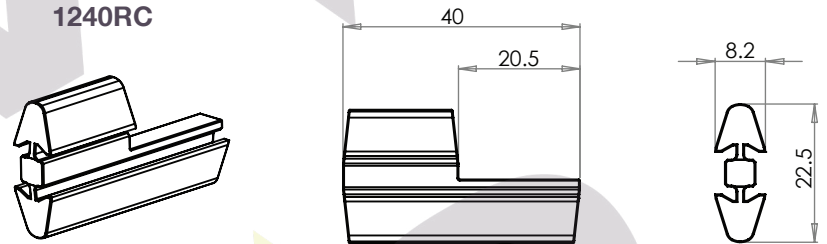

1240PH

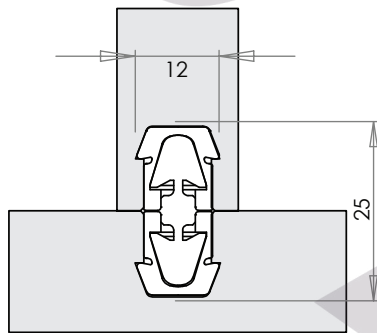
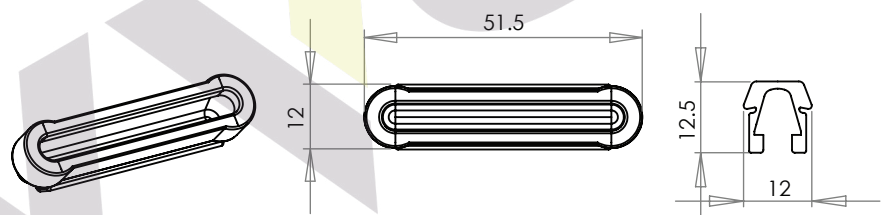

- (i) Plunge
- (ii) Travel
- (iii) Out

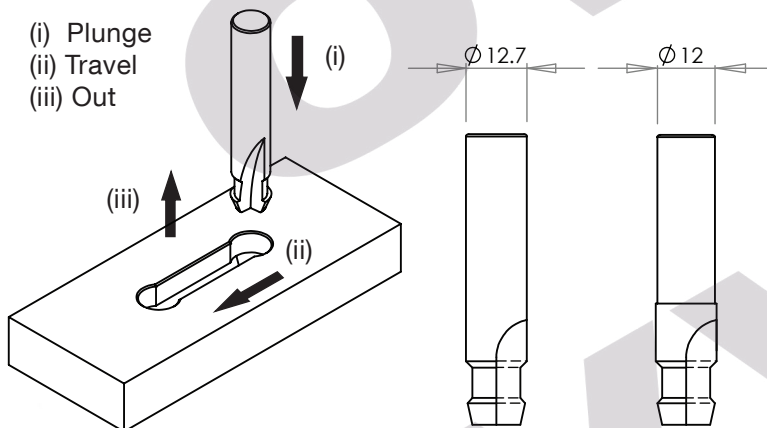

Depth

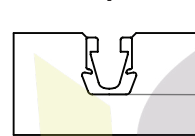

Travel

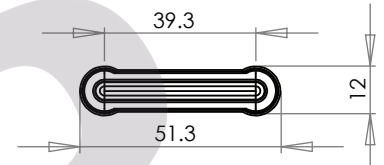

Depth Tolerances: 12.7mm (min) - 13.1mm (max)

Travel (Centre to Centre): 39.3mm

Out to Out: 51.3mm

*CNC speeds vary with different materials.
Maximum cutter rotation: 18,000*

How it works

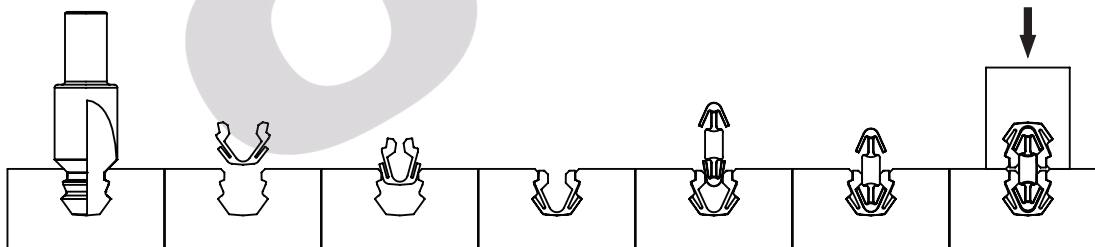

Simply push or slide to connect

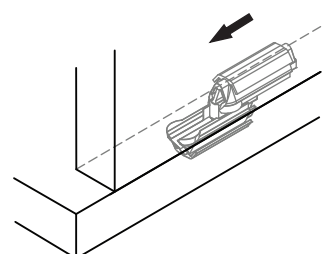

OVVO® V Connection System

1240 Permanent Specifications

THE FUTURE OF CONNECTION

ovvo
www.ovvotech.com

1240 Permanent

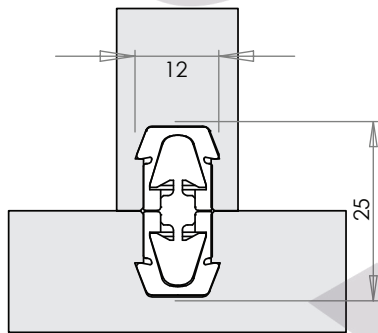

1240PH

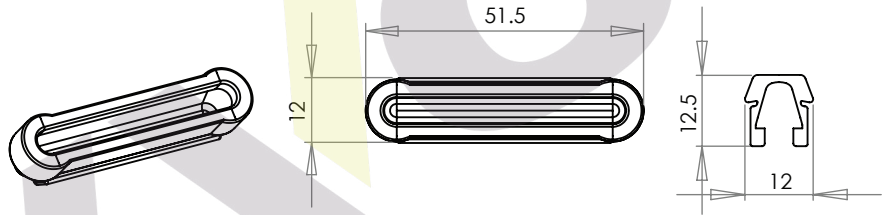

1240PC

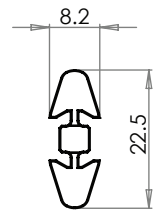
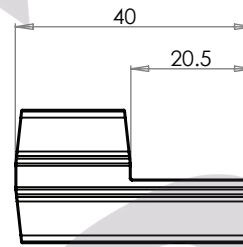
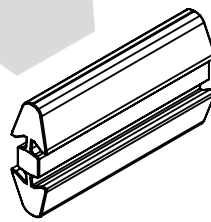

1240PH

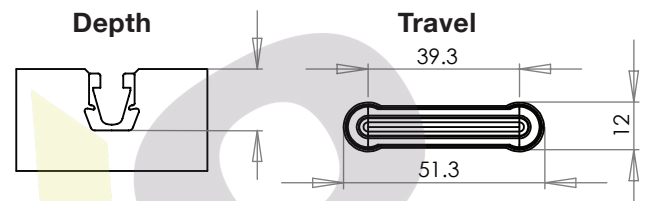
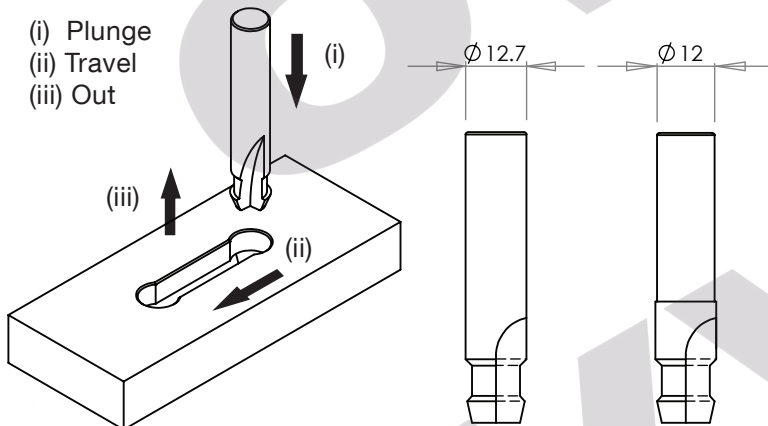
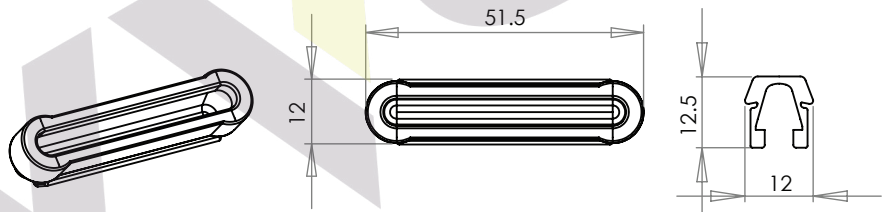

Depth Tolerances: 12.7mm (min) - 13.1mm (max)
Travel (Centre to Centre): 39.3mm
Out to Out: 51.3mm

*CNC speeds vary with different materials.
Maximum cutter rotation: 18,000*

How it works

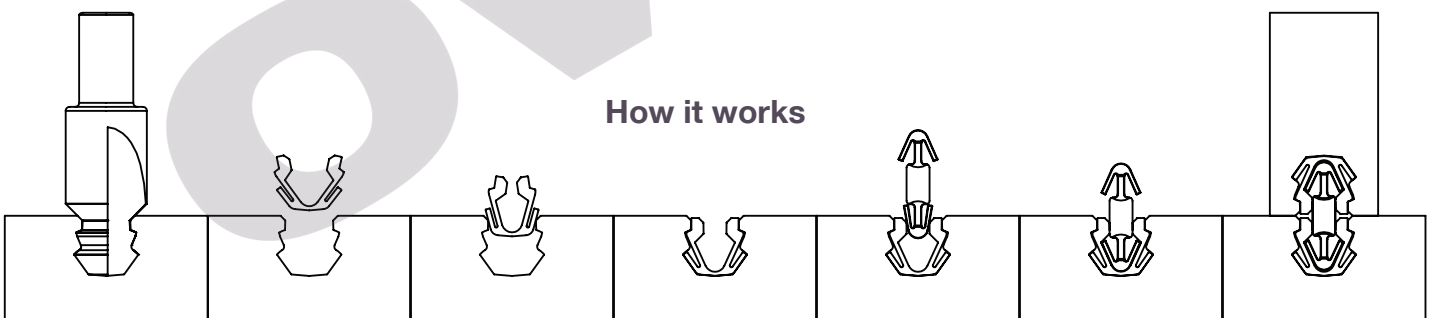

1240 Recommended Minimum Board Depth

Recommended minimum board depth or thickness values for the 1240 will change depending on both the substrate material used as well as the joint angle and axis of connection.

Minimum recommended measurements shown below are categorized according to two distinct groups of board material which share broadly similar connector retention properties.



Fig 1



Fig 2

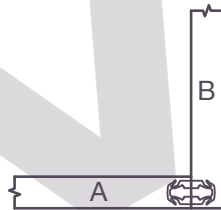

Fig 3

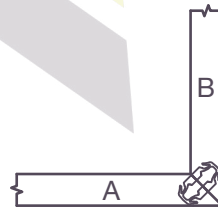

Fig 4

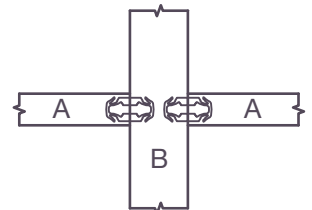

Fig 5

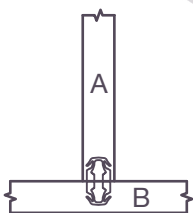

Fig 6

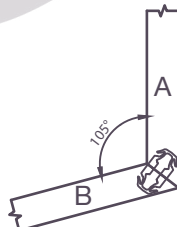

Fig 7

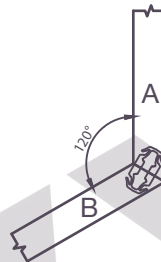

Fig 8

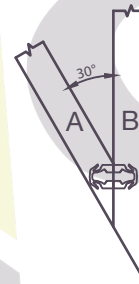

Fig 9

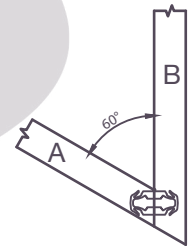

Fig 10

HPL/Composite, Solid Surface, Hardwoods, Birch Plywood		
	A	B
Fig 1	16mm	16mm
Fig 2	15mm	15mm
Fig 3	18mm	18mm
Fig 4	18mm	18mm
Fig 5	15mm	28mm
Fig 6	18mm	15mm
Fig 7	18mm	18mm
Fig 8	18mm	18mm
Fig 9	18mm	15mm
Fig 10	18mm	15mm

Particle/Chipboard, Softwoods/MDF		
	A	B
Fig 1	18mm	18mm
Fig 2	15mm	15mm
Fig 3	18mm	15mm
Fig 4	18mm	18mm
Fig 5	18mm	28mm
Fig 6	18mm	15mm
Fig 7	18mm	18mm
Fig 8	18mm	18mm
Fig 9	18mm	15mm
Fig 10	18mm	15mm

These are guidelines only and OVVO® recommends trial connections be made before going into full production.

OVVO® V Connection System

Important! Make a test

THE FUTURE OF CONNECTION



IMPORTANT! MAKE A TEST
WICHTIG! MACHEN SIE EINEN TEST
IMPORTANT! FAIRE UN TEST
IMPORTANTE! FARE UN TEST
IMPORTANTE! HACER UNA PRUEBA

DEPTH TOLERANCES

1240

12.7mm (min) - 13.1mm (max)

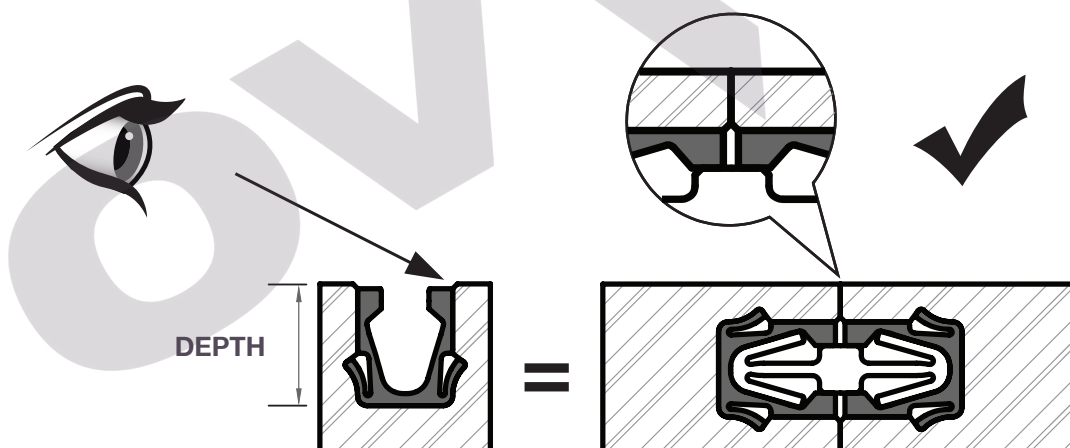
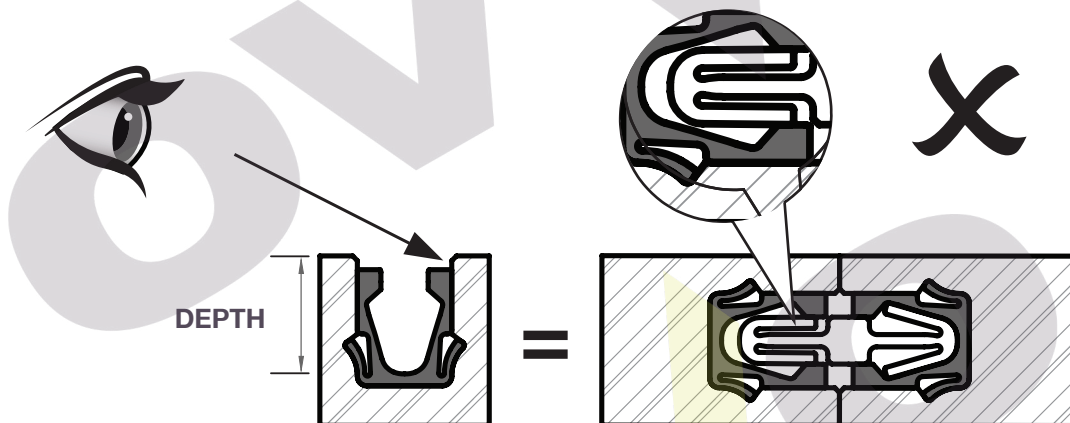
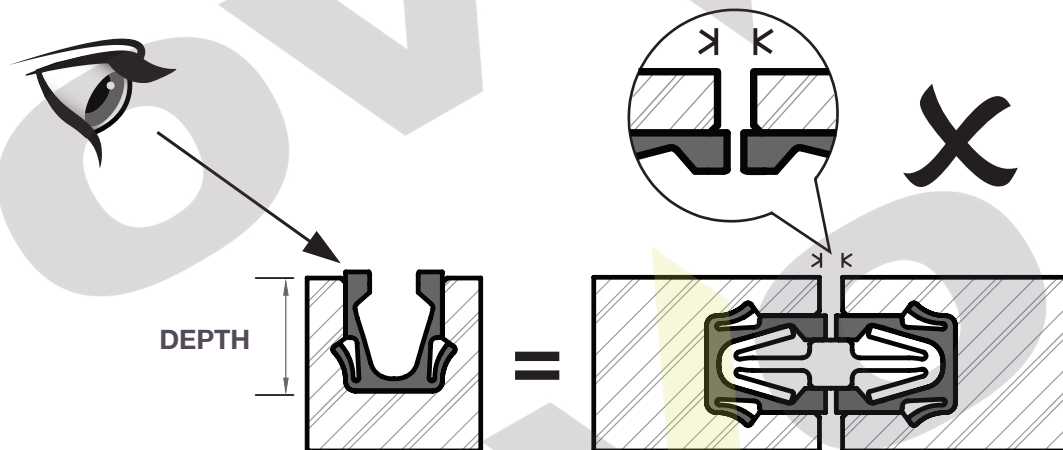

PERMANENT SET FITTING INSTRUCTIONS

2 x PH 1240 = PERMANENT HOUSING
1 x PC 1240 = PERMANENT CONNECTOR

THE FUTURE OF CONNECTION

OVVO

CTION

Milling

- (i) Plunge Depth: 12.7mm (min) - 13.1mm (max)
- (ii) Travel (Centre to Centre): 39.3mm
- Out to Out: 51.3mm

CNC Recommended Speeds

Plunge: 2.5 Metres
Travel: 5 Metres - 7.5 Metres
Rotation: 18,000 Revolutions

Speed applies to MDF / Chipboard / Solidwoods

1.

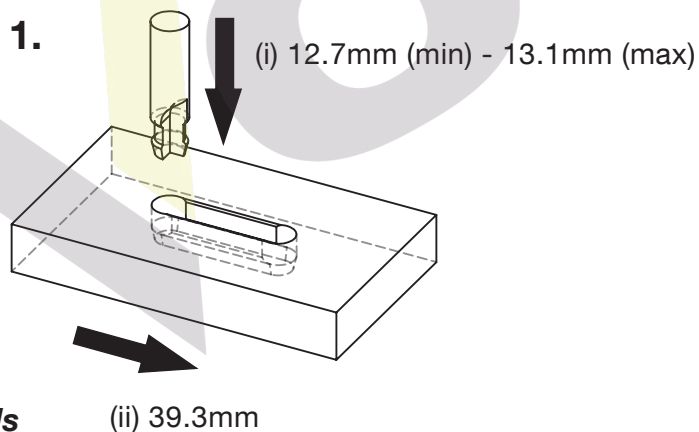

2.

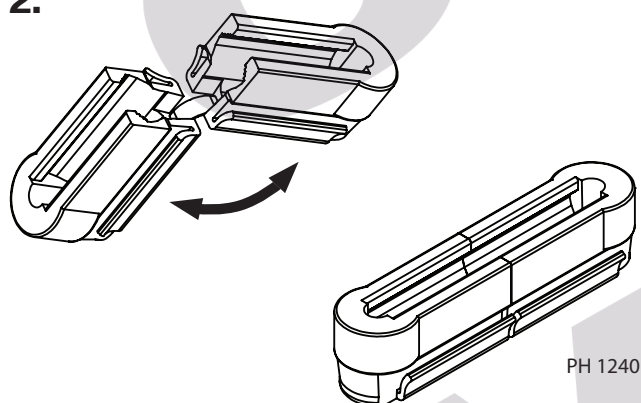

3.

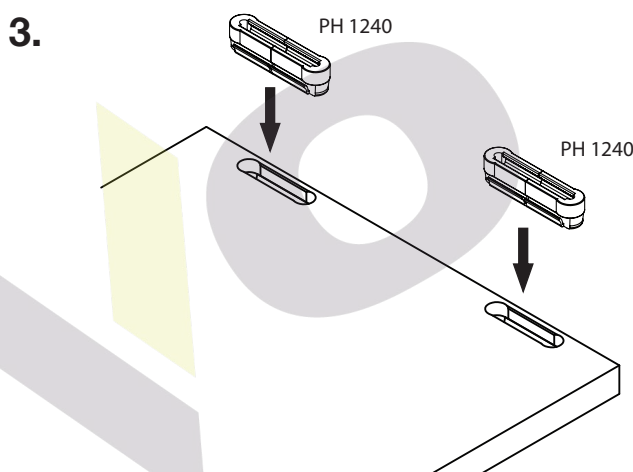

4.

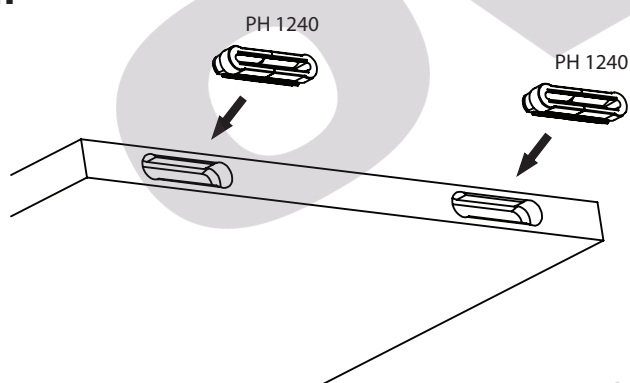

5.

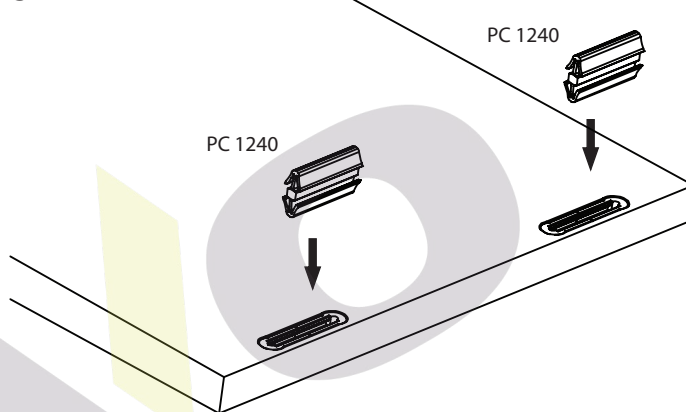

6.

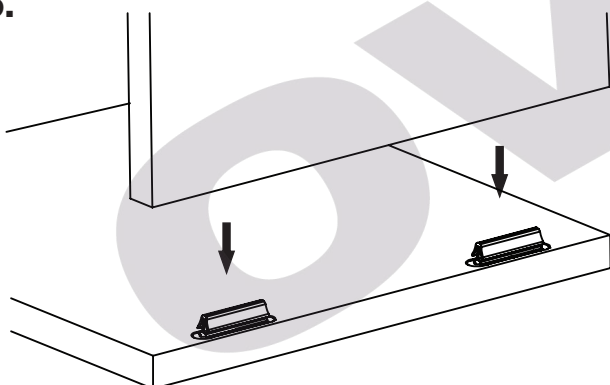

7.

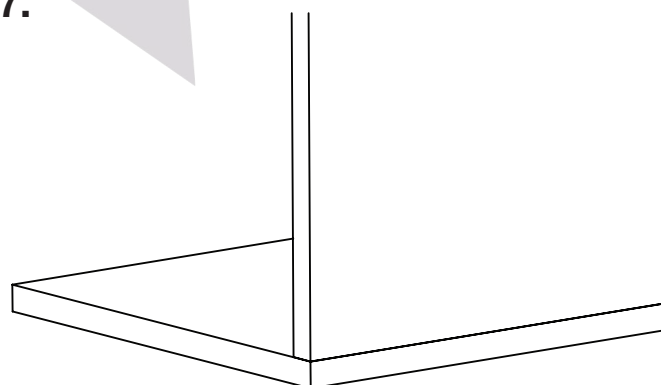

RELEASABLE SET FITTING INSTRUCTIONS

1 x RH 1240 = RELEASABLE HOUSING
1 x RC 1240 = RELEASABLE CONNECTOR
1 x PH 1240 = PERMANENT HOUSING

THE FUTURE OF CONNECTION
OVVO

Milling

(i) Plunge Depth: 12.7mm (min) - 13.1mm (max)
(ii) Travel (Centre to Centre): 39.3mm
Out to Out: 51.3mm

CNC Recommended Speeds

Plunge: 2.5 Metres
Travel: 5 Metres - 7.5 Metres
Rotation: 18,000 Revolutions

Speed applies to MDF / Chipboard / Solidwoods

